

DOUBLE SPHERE RUBBER EXPANSION JOINT Size DN32-DN600 PN16

FIG · 8102

Specification

- With multi-sphere structure so that the vibration absorption is better and noise reduction efficiency is significant.
- High working pressure, anti-burst and good elasticity.
- To avoid damage caused by stretching, compressing, deflecting or displacing of pipes.
- Carbon steel flanges, zinc plated to BS4504 PN16 (Other flanges available).
- EPDM rubber suitable for hot water, steam, oxidant, animal and vegetable oils. Excellent resistance to sunlight. Good for high and low temperature applications.
- NBR is suitable for most hydrocarbons, oils and petroleum fuels and hydraulic fluids. Not good for sunlight ageing, ozone and flame.
- Neoprene suitable for water, sewage, oxidant and non-aromatic hydrocarbons. Good for oil resistance and weathering.

Working Pressure

Size DN32 to DN300

- Working pressure 16 bar
- Bursting pressure 48 bar
- Vacuum Rating 500mmHg

Size DN350 to DN600

- Working pressure 10 bar
- Bursting pressure 30 bar
- Vacuum Rating 400mmHg

Working Temperature

- -10°C to 120°C for EPDM.
- -10°C to 82°C for NBR.
- -10°C to 110°C for Neoprene.

Notes: Design and material are subject to change without notice.

Material Specification

Part Name	Material
Rubber	EPDM/NBR/Neoprene
Carcass	Nylon Cord Fabric
Reinforcing wire	Spring Steel wire
Flange	Carbon Steel, Zinc Plated

Dimensions (mm)

Size	L±5	Axial Compression	Axial Elongation	Lateral Movement	Angular Movement α1+α2	Weight (kg)
32	175	20	10	20	30°	3.2
40	175	20	10	20	30°	3.6
50	175	20	10	20	30°	4.5
65	175	20	10	20	30°	5.4
80	175	20	10	20	30°	6.6
100	225	30	15	25	30°	7.6
125	225	30	15	25	30°	10.2
150	225	30	15	25	30°	13.4
200	325	40	20	30	30°	19.4
250	325	40	20	30	30°	25
300	325	40	20	30	30°	30
350	350	40	20	30	30°	38
400	350	40	20	30	30°	51
450	350	45	25	30	30°	57
500	350	45	25	30	30°	68
600	350	45	25	30	30°	87

Drawing and Picture

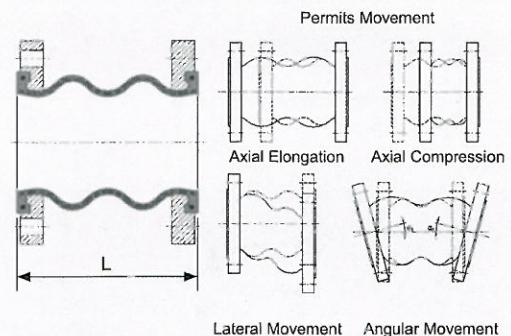

COMBINATION AIR VALVE FOR SEWAGE Size DN80-DN200 PN16

FIG · 9110

Specification

- Single chamber double orifice triple function air and vacuum automatic release valve.
- Designed to operate with liquids carrying solid particles such as sewage and effluent.
- Release air during charging of the system and intake air during draining of the system.
- Complete separation of the liquid from the sealing mechanism provide optimum work conditions.
- All inner metal parts made of stainless steel.
- Flange to EN1092-2 PN16 (other types available on request).

Working Pressure

- Working pressure range: 0.5-16bar.
- Shell test pressure (for body): 24bar
- Seat test pressure: 17.6bar

Working Temperature

- -10°C to 60°C

Corrosion Protection

- Inside and outside liquid epoxy painting or fusion bonded epoxy powder coating (FBE)

Notes: Design and material are subject to change without notice.

Material Specification

No	Part Name	Material	No	Part Name	Material
1	Body	DI, EN1563 EN-JS1050	11	O-ring	NBR
2	Float	SS316	12	Cover	Reinforced Nylon
3	Nut	SS316	13	Disc	NBR+SS316+Nylon
4	Spindle	SS316	14	Bolt	SS316
5	Spring	SS316	15	Plate	SS316
6	Stopper	Polypropylene	16	Bolt	SS316
7	Crown Nut	SS316	17	Washer	SS316
8	Washer	SS316	18	Plastic Base	Reinforced Nylon
9	Gasket	NBR	19	Guide Block	Polypropylene
10	Bonnet	DI, EN1563 EN-JS1050	20	Ball Valve DN25	SS316

Drawing and Picture

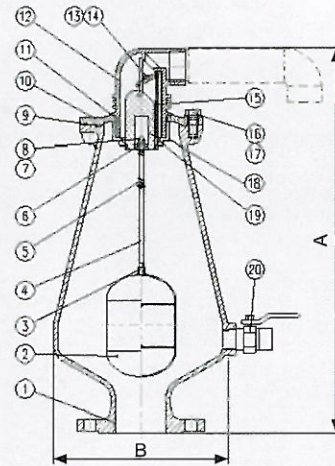

Dimensions (mm/inch)

Size	DN80	DN100	DN150	DN200
A	601	601	601	601
B	275	275	275	275

AUTOMATIC AIR VENT VALVE Size 1/2"-1" PN16

FIG · 9701

Specification

- Small orifice of 1/16 in. (1.6mm) to release air under pressure during normal pipeline operation.
- The float is connected to the vent via a linkage mechanism which is capable of operating the vent under full pipeline pressure.
- NPT or Metric thread of inlet.

Working Pressure

- 16bar

Working Temperature

- -10°C to 120°C

Corrosion Protection

- Internally and externally liquid epoxy painted or fusion bonded epoxy powder coated (FBE).

Notes: Design and material are subject to change without notice.

Material Specification

Part Name	Material	EN Spec.	ASTM Spec.
Body	Cast Iron	EN-JL1040	ASTM A126 Class B
Cover	Cast Iron	EN-JL1040	ASTM A126 Class B
Lever Frame	Stainless Steel	BS970 304S15	AISI 304
Seat	Stainless Steel	BS970 304S15	AISI 304
Float ball	Stainless Steel	BS970 304S15	AISI 304
Gasket	EPDM	Commercial	Commercial
Cover Bolt	Carbon Steel	Carbon Steel	A307 B
Float Arm	Stainless Steel	BS970 304S15	AISI 304
Orifice Button	Viton	Commercial	Commercial
Pivot Pin	Stainless Steel	BS970 304S15	AISI 304
Pin Retainer	Stainless Steel	BS970 304S15	AISI 304
Plug	Brass	CuZn39Pb3	ASTM B16 C36000
Locator	Stainless Steel	BS970 304S15	AISI 304

Drawing and Picture

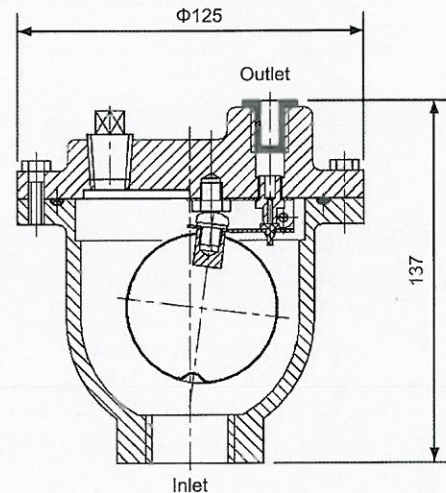

Dimensions (mm/inch)

Size	Inlet Size	Outlet	Orifice Size	Weight (kg)
1/2"	1/2" BSP or NPT	1/2" BSP or NPT	1/16"	3
3/4"	3/4" BSP or NPT	1/2" BSP or NPT	1/16"	3
1"	1" BSP or NPT	1/2" BSP or NPT	1/16"	3

GROOVED END Y-STRAINER Size DN50-DN300 PN16

FIG · 7901

Specification

- NPT or BSPT blowoff outlet on cover. Blowoff outlets are finished with plugs.
- Screens are perforated 304 stainless steel with spot welded seam.
- Recessed seat in body assures accurate screen alignment.
- Groove dimensions comply with Metric or AWWA C606 standard.

Working Pressure

- 16bar

Working Temperature

- -10°C to 120°C

Corrosion Protection

- Internally and externally liquid epoxy painted or fusion bonded epoxy powder coated (FBE).

Notes: Design and material are subject to change without notice.

Material Specification

Part Name	Materials	EN Spec.	ASTM Spec.
Body	Ductile Iron	EN-JS1050	ASTM A536 65-45-12
Cover	Ductile Iron	EN-JS1050	ASTM A536 65-45-12
Screen	Stainless Steel	BS970 304S15	AISI 304
Gasket	Teflon / Graphite	Commercial	Commercial
Plug	Ductile Iron	EN-JS1050	ASTM A536 65-45-12

Standard Screens

Size	Hole Dia.	Free Flow Area
DN50 to 80	1.5mm	33%
DN100 to 600	3.0mm	40%

Dimensions (mm)

Size	50	65	80	100	125	150	200	250	300
OD	60.3	73.0/76.1	88.9	114.3	139.7/141.3	165.1/168.3	219.1	273.0	323.9
L	225	285	318	375	448	502	640	710	779
H	190	225	230	270	340	380	482	560	632
Plug	1/2"	1"	1"	1"	1-1/4"	1-1/2"	1-1/2"	2"	2"
Weight (kg)	7	10.7	13.4	21	35.6	54.2	100	141	233

Drawing and Picture

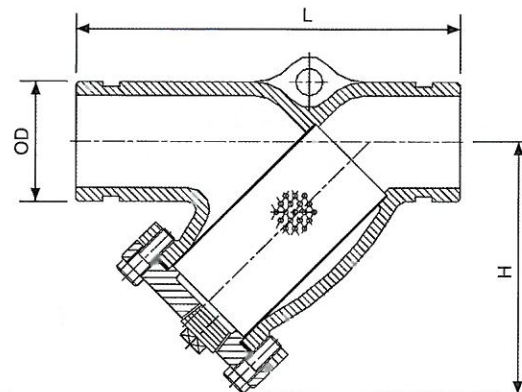
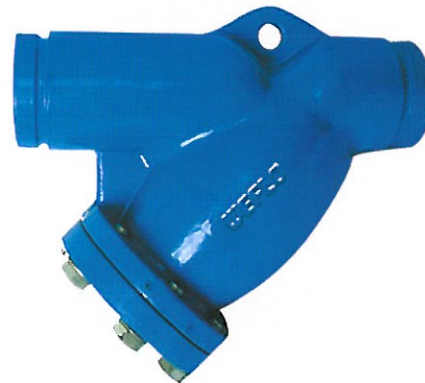

THREAD END Y-STRAINER Size DN15-DN80 PN25/Class250

FIG · 7701

Specification

- NPT or BSPT blowoff outlet on cover. Blowoff outlets are finished with plugs.
- Screens are perforated 304 stainless steel with spot welded seam.
- Recessed seat in body assures accurate screen alignment.
- NPT or Metric thread ends.

Working Pressure

- PN25/Class250

Working Temperature

- -10°C to 120°C

Corrosion Protection

- Internally and externally liquid epoxy painted or fusion bonded epoxy powder coated (FBE).

Notes: Design and material are subject to change without notice.

Material Specification

Part Name	Materials	ASTM Spec.
Body	Cast Iron	ASTM A126 class B
Cover	Cast Iron	ASTM A126 class B
Screen	Stainless Steel	AISI 304
Gasket	Teflon / EPDM	Commercial
Plug	Cast Iron	ASTM A126 class B

Dimensions (mm)

Size	15	20	25	32	40	50	65	80
L	85	98	116	135	154	190.5	223	254
H	62	72	90	110	115	145	165	175
Screen Hole Dia.	1.0	1.0	1.0	1.0	1.0	1.0	1.0	1.0
Plug	3/8"	1/2"	1/2"	3/4"	3/4"	1"	1-1/4"	1-1/2"
Weight (kg)	0.8	1.2	1.8	2.3	3.7	6.4	8.5	15

Drawing and Picture

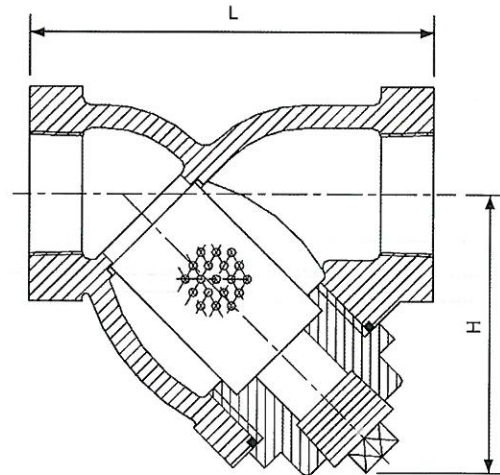
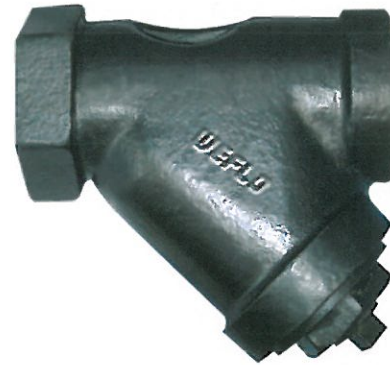

BRONZE BASKET STRAINER Size DN50-DN600 PN16

FIG · 7106

Specification

- NPT or BSPT blowoff outlet on body. Blowoff outlets are finished with plugs.
- Screens are perforated 304 stainless steel with spot welded seam.
- Available with flange EN1092-2 PN16 or ANSI B16.5 Class150 (Other types available on request).

Working Pressure

- 16bar

Working Temperature

- -10°C to 65°C

Notes: Design and material are subject to change without notice.

Material Specification

Part Name	Materials	EN Spec.	ASTM Spec.
Body	Bronze	1982 CC491K	ASTM B62 C83600
Cover	Bronze	1982 CC491K	ASTM B62 C83600
Screen	Stainless Steel	BS970 304S15	AISI 304
Gasket	Teflon / Graphite	Commercial	Commercial
Plug	Bronze	1982 CC491K	ASTM B62 C83600

Standard Screens

Size	Hole Dia.	Free Flow Area
DN50 to 80	1.5mm	33%
DN100 to 600	3.0mm	40%

Dimensions (mm)

Size	50	65	80	100	125	150	200	250	300	350	400	450	500	600
L	207	222	251	292	334	378	475	508	680	769	842	842	842	1054
A	220	250	287	342	370	398	510	665	760	930	980	1010	1110	1690
B	127	140	155	195	215	215	295	340	405	585	590	590	600	1175
Plug	1/2"	3/4"	3/4"	1"	1"	1"	1-1/2"	1-1/2"	2"	2"	2"	2"	2"	2"
Weight (kg)	10.0	14.1	19.1	31.8	40.9	56.3	122.6	174.3	304.2	478.6	550	710	935	1375

Drawing and Picture

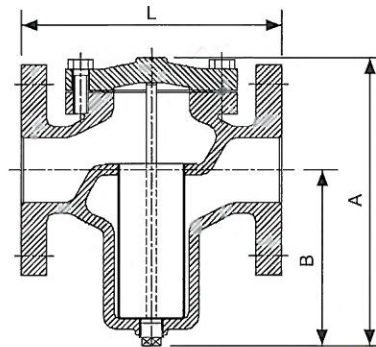

Size DN50

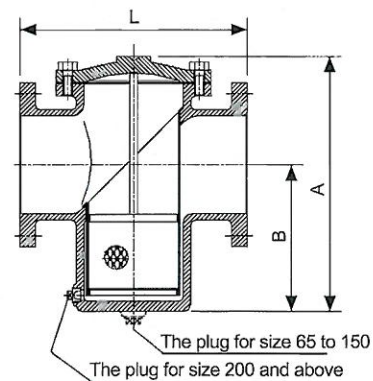

Y-STRAINER-BRONZE Size DN50-DN600 PN16/Class150

FIG · 7104

Specification

- NPT or BSPT blowoff outlet on cover. Blowoff outlets are finished with plugs.
- Screens are perforated 304 stainless steel with spot welded seam.
- Recessed seat in body assures accurate screen alignment.
- Available with flanges EN1092-2 PN10 or PN16, ANSI B16.1 Class125 (Other types available on request).

Working Pressure

- 16bar

Working Temperature

- -10°C to 65°C

Drawing and Picture

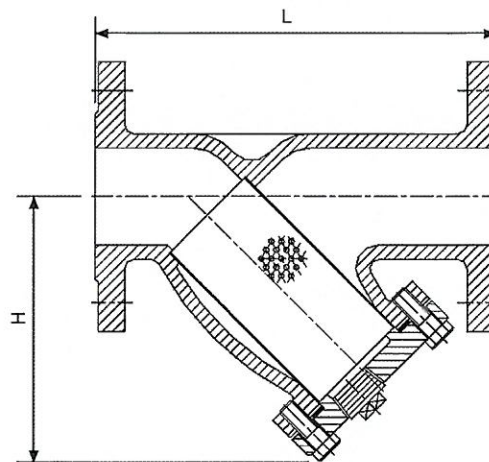

Notes: Design and material are subject to change without notice.

Material Specification

Part Name	Materials	EN Spec.	ASTM Spec.
Body	Bronze	1982 CC491K	ASTM B62 C83600
Cover	Bronze	1982 CC491K	ASTM B62 C83600
Screen	Stainless Steel	BS970 304S15	AISI 304
Gasket	Teflon / Graphite	Commercial	Commercial
Plug	Bronze	1982 CC491K	ASTM B62 C83600

Standard Screens

Size	Hole Dia.	Free Flow Area
DN50 to 80	1.5mm	33%
DN100 to 600	3.0mm	40%

Dimensions (mm) for Fig.7101

Size	50	65	80	100	125	150	200	250	300	350	400	450	500	600
L	219	260	295	365	447	473	571	664	770	960	1079	1168	1275	1450
H	157	202	207	248	295	337	395	473	554	740	840	902	990	1134
Plug	1/2"	3/4"	1"	1-1/2"	1-1/2"	1-1/2"	1-1/2"	2"	2"	2"	2"	2"	2"	2"
Weight (kg)	11	28.5	26	37.4	57.2	77	121	204	325	504	612	690	858	1188

Y-STRAINER

Size DN50-DN600

PN16/PN25/Class125/Class250

FIG · 7101-PN16/Class 125 , FIG · 7102-PN25/Class250

Specification

- NPT or BSPT blowoff outlet on cover. Blowoff outlets are finished with plugs.
- Screens are perforated 304 stainless steel with spot welded seam.
- Recessed seat in body assures accurate screen alignment.
- Available with flanges to EN1092-2 PN16/PN25, ANSI B16.1 Class125 or ANSI B16.2 Class250 (Other types available on request).
- WRAS approved.

Working Pressure

- 16bar for Size DN50 to DN600
- 25bar for Size DN50 to DN300

Working Temperature

- -10°C to 120°C

Corrosion Protection

- Internally and externally liquid epoxy painted or fusion bonded epoxy powder coated (FBE).

Material Specification

Part Name	Materials	EN Spec.	ASTM Spec.	
Disc	7101	Cast Iron	EN-JL1040	ASTM A126 Class B
	7102	Ductile Iron	EN-JS1050	ASTM A536 65-45-12
Cover	7101	Cast Iron	EN-JL1040	ASTM A126 Class B
	7102	Ductile Iron	EN-JS1050	ASTM A536 65-45-12
Screen	Stainless Steel	BS970 304S15	AISI 304	
Gasket	Teflon / Graphite	Commercial	Commercial	
Plug	7101	Cast Iron	EN-JL1040	ASTM A126 Class B
	7102	Ductile Iron	EN-JS1050	ASTMA536 65-45-12

Drawing and Picture

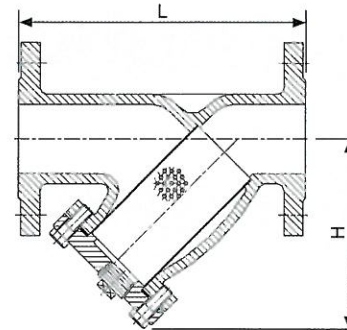

Standard Screens

Size	Hole Dia.	Free Flow Area
DN50 to 80	1.5mm	33%
DN100 to 600	3.0mm	40%

Notes: Design and material are subject to change without notice.

Dimensions (mm) for Fig.7101

Size	50	65	80	100	125	150	200	250	300	350	400	450	500	600
L	230	273	295	352	416	470	543	660	770	960	1079	1168	1275	1450
H	150	185	205	245	294	330	415	492	562	755	827	930	980	1170
Plug	1/2"	1"	1"	1"	1-1/4"	1-1/2"	1-1/2"	2"	2"	2"	2"	2"	2"	2"
Weight (kg)	10	26	23.5	34	52	70	110	185	295	458	556	627	780	1080

Dimensions (mm) for Fig.7102

Size	50	65	80	100	125	150	200	250	300
L	225	287	305	369	441	495	556	692	798
H	146	170	198	238	285	305	401	473	554
Plug	1/2"	1"	1"	1"	1-1/4"	1-1/2"	1-1/2"	2"	2"
Weight (kg)	12.7	19	24.5	50	73	102	167	268	404

ECENTRIC PLUG VALVE

Size 2"-24" PN16/PN25/Class125/Class250

FIG · 1105-Class125/PN16 , FIG · 1106-Class250/PN25

FIG · 1605-Mechanical Jointed End

Specification

- Seat area with welded overlay minimum 90% pure nickel.
- Shaft sealed by the multiple V-ring type.
- Round plug fully rubber coated up to 12" plugs 14" to 24" have a cylindrical rubber sealed surface.
- Bearings of sintered SS316, oil impregnated permanently lubricated.
- Available with flange to EN1092-2 PN16, ANSI B16.1 Class125 (Others available on request).
- With Mechanical-Joint AWWA/ANSI C153/A21.53-00.

Working Pressure

- 16bar or 25bar

Working Temperature

- -10°C to 120°C for EPDM coated plug
- -10°C to 82°C for NBR coated plug

Corrosion Protection

- Internally and externally liquid epoxy painted or fusion bonded epoxy powder coated (FBE).

Notes: Design and material are subject to change without notice.

Drawing and Picture

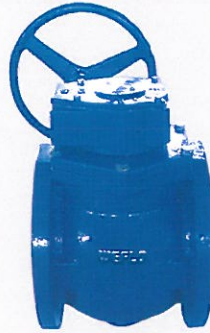

Flange End, Size 2" to 12"

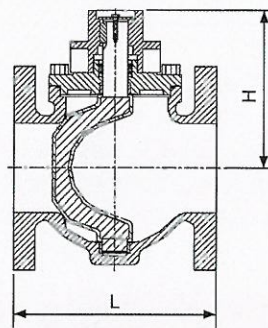

Flange End, Size 14" to 24"

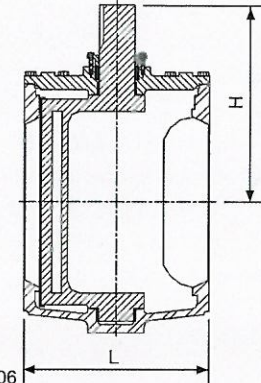
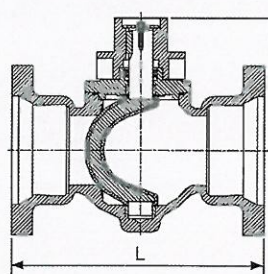

Fig. 1105/1106

MJ End, Size 2" to 12"



MJ End, Size 14" to 24"

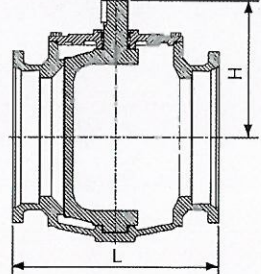

Fig. 1605

Material Specification

Part Name	Material	ASTM Spec.	Part Name	Material	ASTM Spec.
Body	Ductile Iron	ASTM A536 65-45-12	Plug	DI with EPDM/NBR coated	
Bonnet	Ductile Iron	ASTM A536 65-45-12	Torque collar	Ductile Iron	ASTM A536 65-45-12
Bearing	Stainless steel	ANSI 316	V-Packing	Rubber	EPDM/NBR
Thrust washer	PTFE	Commercial	Gasket	Rubber	EPDM/NBR

Dimensions for Fig. 1105 & 1106 (inch)

Size	2"	2.5"	3"	4"	5"	6"	8"	10"	12"	14"	16"	20"	24"	
L	1105	7.0	7.5	8	9	10.5	10.5	11.5	13	14	17	17.75	23.5	42
	1106	NA	9.5	11.12	12	15	15.88	16.5	18	19.75	18.5	19.38	25	42.88
H	5.25	6	6	7	7.5	8.5	9	11.5	13	16.6	18.1	22.3	23.5	
Weight(kg)	12	13.6	18.1	31.7	52.2	62	86.2	156.5	199.5	240	445	751	934	

Dimensions for Fig. 1605 (inch)

Size	3"	4"	6"	8"	10"	12"	14"	16"	20"	24"
L	11.5	14.25	15.75	17.38	19.37	20.75	24.5	27.25	31	42
H	6	7	8.5	9	11.5	13	16.6	18.1	22.3	23.5
Weight(kg)	22.7	36.3	56.7	90.7	163.3	217.7	264	492	831	1030

THIN WAFER CHECK VALVE PN16

FIG · 5315-Stainless Steel Body and Disc FIG · 5316-Carbon Steel Body and Disc

Specification

- The short face to face dimension and compact design of this valve allow installation and service in tight spaces.
- Soft sealed for perfect tightness even at low differential pressure.
- Available with flanges to EN1092-2 PN10 or PN16, ANSI B16.1 Class125 (Other types available on request).

Working Pressure

- 16bar

Working Temperature

- -10°C to 150°C

Corrosion Protection

- Internally and externally Cr plated for carbon steel body and disc.

Material Specification

No.	Description	Material
1	Body	SS316
		CS., DIN GS-Ck25
2	Disc	SS316
		CS., DIN GS-Ck25
3	Hook	Carbon Steel, Zinc Plated
4	Screw	SS316
5	O-Ring	Viton
6	Holder	SS316

Drawing and Picture

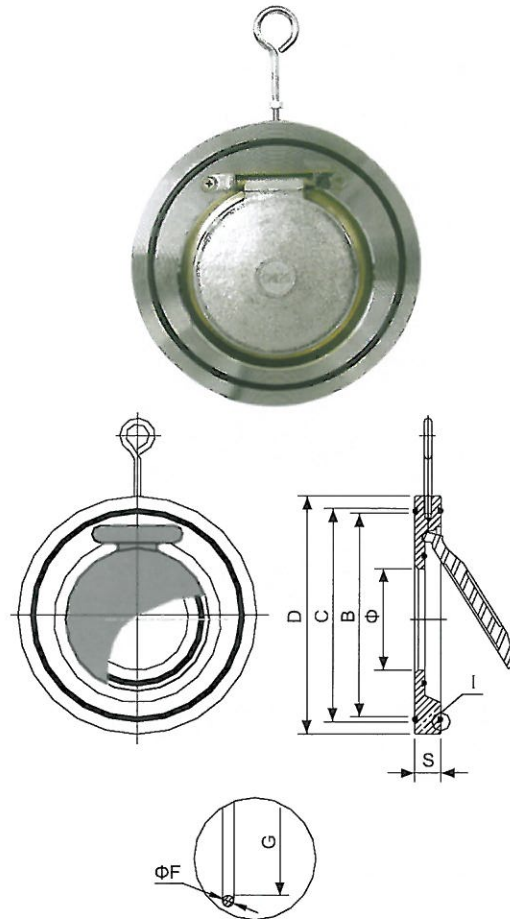

Notes: Design and material are subject to change without notice.

Dimensions (mm)

Size	50	65	80	100	125	150	200	250	300	350	400	450	500	600
S	14	14	14	18	18	20	22	26	28	36	41	50	56	56
D	109	129	144	164	194	220	275	330	380	440	490	537	592	694
Φ	31.8	40	51.3	70	91.5	110	163	192	234	270	315	359	410	490
C	98.3	108.3	129.8	147.3	171.3	201.8	253.8	305.8	355.8	402.8	452.8	503.8	551.8	647.8
B	91.7	102.7	123.2	140.7	161.7	192.2	244.2	294.2	344.2	387.2	437.2	488.2	536.2	632.2
G	87.5	98.5	118.5	135.5	160	187	239	287	337	387	436.5	488	536	632
F	3.5	3.5	3.5	3.5	5	5	5	6	6	8	8	8	8	8
Weight (kg)	1.0	1.5	1.9	2.3	3.6	5.0	10.5	14.0	18.2	27	36	49	63	83.5

FLEX CHECK VALVE Size DN50-DN600 PN16/Class125 FIG · 5107

Specification

- The disc is precision molded with an integral o-ring type sealing surface, and contain alloy steel with nylon reinforcement in the flexible hinge area.
- A threaded port with pipe plug on the bottom of valve to allow for field installation of a backflow actuator.
- Slamming and water hammer virtually non-existent due to its short closing travel.
- Full top-entry access for easy on-line inspection and maintenance.
- Available with flanges EN1092-2 PN10 or PN16, ANSI B16.1 Class125 (Other types available on request).

Working Pressure

- 16Bar

Working Temperature

- -10°C to 120°C for EPDM coated trim
- -10°C to 82°C for NBR coated trim
- -10°C to 150°C for Viton coated trim

Material Specification

Part Name	Materials	EN Spec.	ASTM Spec.
Body	Cast Iron for DN50 to DN300	EN-JL1040	A126 Class B
	Ductile Iron for DN350 and Above	EN-JS1050	A536 65-45-12
Cover	Cast Iron for DN50 to DN300	EN-JL1040	A126 Class B
	Ductile Iron for DN350 and Above	EN-JS1050	A536 65-45-12
Disc	Ductile Iron EPDM/NBR/Viton Coated	EN-JS1050	A536 65-45-12
Gasket	NBR/EPDM/Viton	Commercial	Commercial
Plug	Malleable Iron	Commercial	Commercial

Drawing and Picture

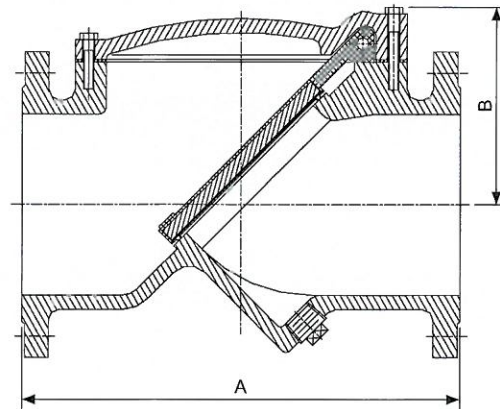

Corrosion Protection

- Internally and externally fusion bonded epoxy powder coated (FBE).

Notes: Design and material are subject to change without notice.

Dimensions (mm)

Size	50	65	80	100	125	150	200	250	300	350	400	450	500	600
A	203	216	243	292	349	381	495	622	699	787	813	914	1016	1219
B	95	95	110	121	147	147	222	260	292	333	391	435	486	578
Weight(kg)	13	14.5	23	32	46	58	120	180	240	300	360	455	648	873

SILENT CHECK VALVE

Size DN50-DN400 PN16/PN25/Class125/Class250

FIG · 5104-Bronze Seat , FIG · 5105-SS Seat

Specification

- The design is for liquid service and offers many obvious advantages when compared with conventional swing check valve.
- Spring automatically closes disc at zero flow before flow reversal occurs. This prevents surge and water hammer.
- Completely guided disc both top and bottom.
- Soft sealed for perfect tightness even at low differential pressure.
- Available with flanges EN1092-2 PN10 or PN16, ANSI B16.1 Class125 (Other types available on request).

Working Pressure

- 16bar or 25bar

Working Temperature

- -10°C to 120°C for EPDM seat
- -10°C to 82°C for NBR seat
- -10°C to 150°C for Viton seat

Corrosion Protection

- Internally and externally liquid epoxy painted or fusion bonded epoxy powder coated (FBE).

Material Specification

Part Name	Material	EN Spec.	ASTM Spec.
Body*	Cast Iron	EN-JL1040	A126 Class B
Disc	Bronze	EN1982 CC491K	B62 C83600
	Stainless Steel	BS970 304S15	A351 CF8
Seat	Bronze	EN1982 CC491K	B62 C83600
	Stainless Steel	BS970 304S15	A351 CF8
Seat O-Ring	EPDM/NBR/Viton	Commercial	Commercial
Spring	Stainless Steel	BS970 304S15	AISI 304
Bushing	Bronze	EN1982 CC491K	B62 C83600
Screw	Stainless Steel	BS970 304S15	AISI 304

Drawing and Picture

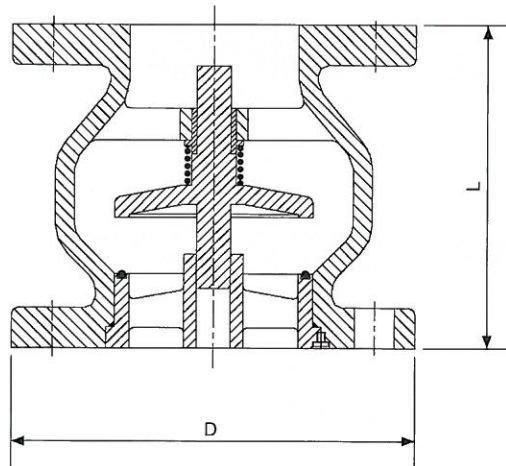

Notes: In Ductile Iron construction for PN25 or Class250.
Design and material are subject to change without notice.

Dimensions (mm)

Size	50	65	80	100	125	150	200	250	300	350	400
L	133	140	152	185	216	248	318	393	362	400	446
D	EN1092-2 PN16 Flange	165	185	200	220	250	285	340	405	460	520
	EN1092-2 PN25 Flange	165	185	200	235	270	300	360	425	485	555
	ANSI 125# Flange	152	178	191	229	254	279	343	406	483	533
	ANSI 250# Flange	165	191	210	254	279	318	381	445	521	584
Weight (kg)	7.5	10.3	13.6	18.3	25.7	34.3	60.6	80	125	185	257

WAFER SILENT CHECK VALVE Size DN50-DN350 PN16/Class125

FIG · 5312

Specification

- The design is for liquid service and offers many obvious advantages when compared with conventional swing check valve.
- Spring automatically closes disc at zero flow before flow reversal occurs. This prevents surge and water hammer.
- Completely guided disc both top and bottom.
- Soft sealed for perfect tightness even at low differential pressure.
- Available with flanges EN1092-2 PN10 or PN16, ANSI B16.1 Class125 (Other types available on request).

Working Pressure

- 16bar

Working Temperature

- -10°C to 120°C for EPDM seat O-ring
- -10°C to 82°C for NBR seat O-ring
- -10°C to 150°C for Viton seat O-ring

Corrosion Protection

- Internally and externally liquid epoxy painted or fusion bonded epoxy powder coated (FBE).

Material Specification

Part Name	Materials	EN Spec.	ASTM Spec.
Body*	Cast Iron	EN-JL1040	A126 Class B
Seat	Stainless Steel	BS970 304S15	A351 CF8
	Bronze	EN1982 CC491K	B62 C83600
Disc	Stainless Steel	BS970 304S15	A351 CF8
	Bronze	EN1982 CC491K	B62 C83600
Spring	Stainless Steel	BS970 304S15	AISI 304
Bushing	Bronze	EN1982 CC491K	B62 C83600
Screw	Stainless Steel	BS970 304S15	AISI 304
Seat O-ring	EPDM/NBR/Viton	Commercial	Commercial

Dimensions (mm)

Size		50	65	80	100	125	150	200	250	300	350
A	ANSI 125# & 250# Flange	113	127	146	188	213	248	340	410	415	478
	PN16 & PN25 Flange	113	127	150	167	213	248	340	410	415	478
B		67	73	80	102	118	140	165	216	286	350
Weight (kg)		2.8	4	6	9.2	14.5	22	32.5	56	98	140

Drawing and Picture

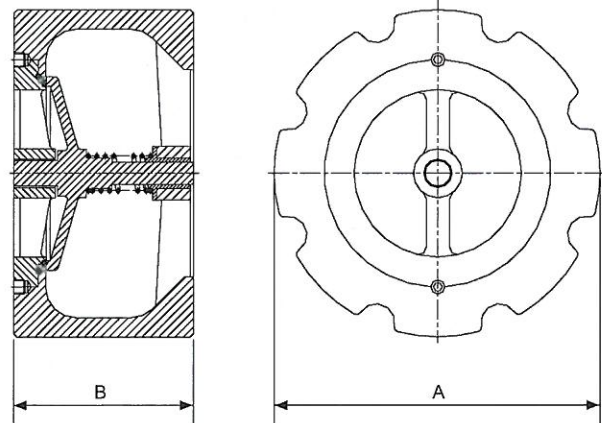
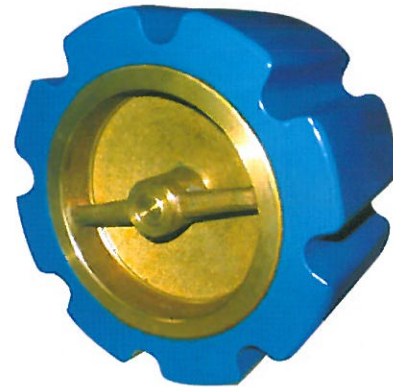

Notes: In Ductile Iron construction for PN25 or Class250.
Design and material are subject to change without notice.

WAFER DOUBLE DOOR CHECK VALVE Size DN50-DN350 PN25/PN40/Class250

FIG · 5304

Specification

- The short face to face dimension and compact design of this valve allow installation and service in tight spaces.
- Spring assisted for better dynamic behaviour.
- Soft sealed for perfect tightness even at low differential pressure.
- Available with flanges EN1092-2 PN10 or PN16, ANSI B16.1 Class125 (Other types available on request).

Working Pressure

- 25bar or 40bar

Working Temperature

- -10°C to 150°C

Notes: Design and material are subject to change without notice.

Material Specification

Part Name	Materials	BS Spec.	ASTM Spec.
Body	Stainless Steel	970 316S16	A351 CF8M
		970 304S15	A351 CF8
Disc	Stainless Steel	970 316S16	A351 CF8M
		970 304S15	A351 CF8
Seat	Viton	Commercial	Commercial
Hinge Pin	Stainless Steel	970 316S16	AISI 316
Stop Pin	Stainless Steel	970 316S16	AISI 316
Pin Retainer	Stainless Steel	970 316S16	AISI 316
Spring	Stainless Steel	970 304S15	AISI 304
Washer	PTFE	Commercial	Commercial
Gasket	Viton	Commercial	Commercial

Drawing and Picture

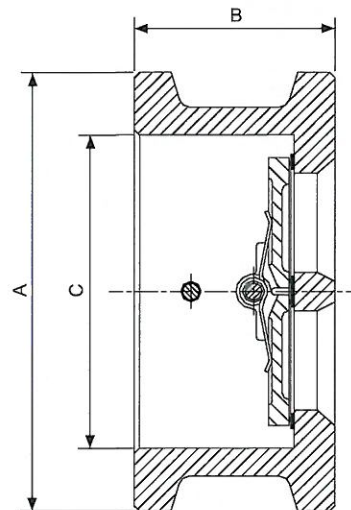

Dimensions (mm)

Size	A			B	C	Weight (kg)
	EN1092-2 PN40 Flange	ANSI 250# Flange	EN1092-2 PN25 Flange			
50	106	106	106	54	66	1.8
65	126	125	126	54	78	2.4
80	141	144	141	57	90	3.2
100	165	176	165	64	115	4.8
125	190	211	190	70	141	7.3
150	220	246	220	76	170	10
200	287	303	280	95	210	14.2
250	349	356	337	108	273	23.6
300	414	417	397	143	324	37.5
350	471	480	454	184	356	77

GROOVED END SWING CHECK VALVE Size DN50-DN300 PN25

FIG · 5904

Specification

- Globe shape to provide full flow with very low pressure drop.
- Rubber coated disc for perfect tightness at low differential pressure.
- Groove dimensions comply with Metric or AWWA C606 standard.

Working Pressure

- 25bar

Working Temperature

- -10°C to 120°C for EPDM
- -10°C to 82°C for NBR

Corrosion Protection

- Internally and externally liquid epoxy painted or fusion bonded epoxy powder coated (FBE).

Notes: Design and material are subject to change without notice.

Drawing and Picture

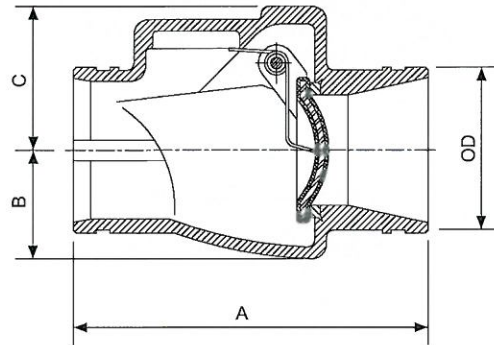

Material Specification

Part Name	Material	EN Spec.	ASTM Spec.
Body	Ductile Iron	EN-JS1050	A536 65-45-12
Disc	DI EPDM/NBR Coated	EN-JS1050	A536 65-45-12
Seat	Stainless Steel	BS970 316S16	AISI 316
	DI Integral	EN-JS1050	A536 65-45-12
Spring	Stainless Steel	BS970 304S15	AISI 304
Shaft	Stainless Steel	BS970 420S37	AISI 420
Gasket	EPDM/NBR	Commercial	Commercial
Shaft Plug	Brass	CuZn39Pb3	B16 C36000

Dimensions (mm)

Size	50	65	80	100	125	150	200	250	300
OD	60.3	73.0/76.1	88.9	114.3	139.7/141.3	165.1/168.3	219.1	273.0	323.9
A	99	99	108	254	267	292	356	432	495
B	36	45	49	76	111	105	130	163	188
C	47	57	68	99	114	127	154	188	205
Weight (kg)	11.5	13	17	25	40	50	58.3	218	282

SWING CHECK VALVE

Size DN50-DN600 PN16/PN25/Class125/Class250

FIG · 5108-Bronze Disc Trim , FIG · 5110-Rubber Disc Trim

Specification

- Valves comply with EN 12334, BS5153, MSS SP-71 or AWWA C508.
- Globe shape to provide full flow with low pressure drop.
- Suitable for mounting in horizontal and vertical position (with vertical flow upwards).
- Outside lever and adjustable weight or Outside lever and spring
- Available with flanges to EN1092-2 PN10 or PN16, ANSI B16.1 Class125 (Other types available on request).

Working Pressure

- Size 50mm–600mm 16Bar
- Size 50mm–300mm 25Bar

Working Temperature

- -10°C to 120°C for Bronze or EPDM disc trim
- -10°C to 82°C for NBR disc trim

Material Specification

Part Name	Materials	EN Spec.	ASTM Spec.
Body*	Cast Iron	EN-JL1040	A126 Class B
Cover*	Cast Iron	EN-JL1040	A126 Class B
Side Plug	Brass	CuZn39Pb3	B16 C36000
Hanger Pin	Stainless Steel	BS970 304S15	AISI 304
Hanger	Ductile Iron	EN-JS1050	A536 65-45-12
Disc*	Cast Iron	EN-JL1040	A126 Class B
Disc Trim	Bronze	EN1982 CC491K	B62 C83600
	EPDM/NBR	Commercial	Commercial
Body Trim	Bronze	EN1982 CC491K	B62 C83600
Gasket	Graphite	Non-asbestos	Non-asbestos
Lever	Carbon Steel	BS970 050A20	AISI 1020
Weight	Cast Iron	EN-JL1040	A126 Class B
Spring	Carbon Steel	Spring Steel	Spring Steel

Drawing and Picture

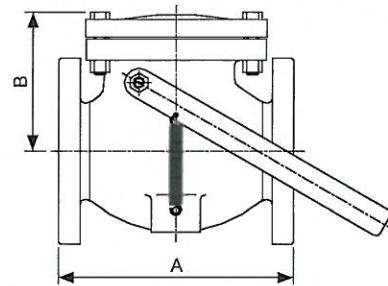
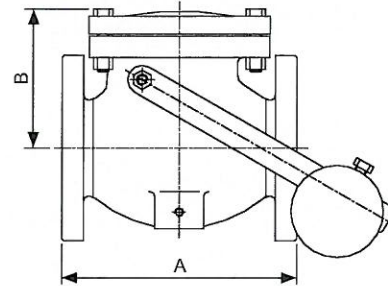

Corrosion Protection

- Internally and externally liquid epoxy painted or fusion bonded epoxy powder coated (FBE).

Notes: In Ductile Iron construction for PN25 or Class250.
Design and material are subject to change without notice.

Dimensions (mm)

Size	50	65	80	100	125	150	200	250	300	350	400	450	500	600
A	203	216	241	292	330	356	495	622	699	787	914	914	1016	1219
B	125	137	147	166	190	217	265	300	342	402	472	500	514	605
Weight(kg)	16.6	22.5	26.4	42.0	61.2	77.4	130.2	205.5	299.5	525	710	820	1060	1680

TRIPLE DUTY VALVE Size DN50-DN300 PN16/Class125

FIG · 1118-Flange EndM , FIG · 1918-Groove End

Specification

- Three valves in one.
- Spring assisted for better dynamic behaviour.
- Soft sealed for perfect tightness even at low differential pressure.
- Can be set in conjunction with flow charts.
- Two test points located on each valve.
- Available with flanges to EN1092-2 PN10 or PN16, ANSI B16.1 Class125 (Other types available on request).
- Groove to Metric or AWWA C606 standard.
- Face to face length in accordance with EN558-1 basic series 1.

Working Pressure

- 16bar

Working Temperature

- -10°C to 120°C

Corrosion Protection

- Internally and externally fusion bonded epoxy powder coated (FBE).

Notes: Design and material are subject to change without notice.

Material Specification

Part Name	Materials	EN Spec.	ASTM Spec.
Body	Ductile Iron	EN-JS1050	A536 65-45-12
Cover	Ductile Iron	EN-JS1050	A536 65-45-12
Disc	Stainless Steel	BS970 304S15	A351 CF8
Disc Sealed Ring	EPDM	Commercial	Commercial
Stem	Stainless Steel	BS970 420S37	AISI 420
Gasket	EPDM	Commercial	Commercial
Spring	Stainless Steel	BS970 304S15	AISI 304
Bushing	Brass	CuZn39Pb3	B16 C36000
Handwheel	Ductile Iron	EN-JS1050	A536 65-45-12

Drawing and Picture

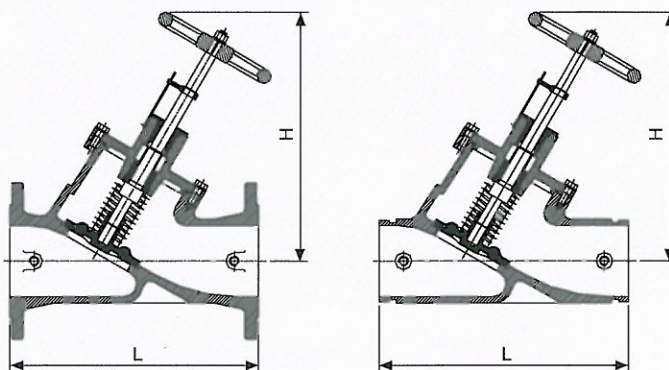

Dimensions (mm/Inch)

Size	DN50	DN65	DN80	DN100	DN125	DN150	DN200	DN250	DN300
L	230	290	310	350	400	480	600	730	850
H(Open)	300	320	350	455	515	565	710	895	1000
Weight(kg)	12	17.5	22	33	49	62	98.5	181.5	300

GLOBE VALVE
Size DN50-DN300 PN16/PN25/Class125/Class250
FIG · 6123

Specification

- Valves comply with EN13789, MSS SP-85.
- Metal seat.
- Adjustable stem seal.
- Packing replaceable under pressure.
- Available with flanges to EN1092-2 PN10 or PN16, ANSI B16.1 Class125 (Other types available on request).
- Face to face length in accordance with EN558-1 basic series 10 and ASME B16.10-2000.

Working Pressure

- 16bar for EN13789 valves
- 200psi for MSS SP-85 valves

Working Temperature

- -10°C to 120°C

Corrosion Protection

- Internally and externally liquid epoxy painted.

Notes: Body , bonnet & disc in ductile iron for PN 25 / Class 250 valves.
Design and material are subject to change without notice.

Material Specification

Part Name	Materials	EN Spec.	ASTM Spec.
Body*	Cast Iron	EN-JL1040	ASTM A126 Class B
Bonnet*	Cast Iron	EN-JL1040	ASTM A126 Class B
Body Trim	Bronze	EN1982 CC491K	ASTM B62 C83600
Disc Trim	Bronze	EN1982 CC491K	ASTM B62 C83600
Disc*	Cast Iron	EN-JL1040	ASTM A126 Class B
Stem	Stainless Steel	BS970 420S37	AISI 420
Packing	Graphite	Non-asbestos	Non-asbestos
Gasket	Graphite	Non-asbestos	Non-asbestos
Yoke Bushing	Brass	CuZn39Pb3	ASTM B16 C36000
Handwheel	Cast Iron	EN-JL1040	ASTM A126 Class B

Drawing and Picture

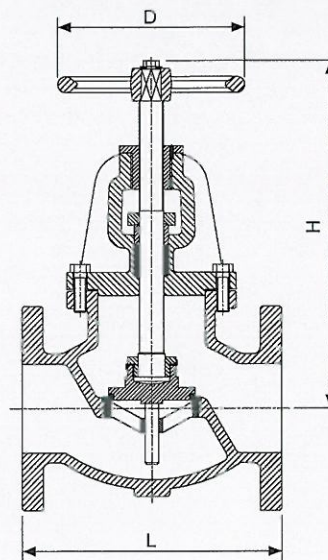

Dimensions (mm)

Size	DN50	DN65	DN80	DN100	DN125	DN150	DN200	DN250	DN300
L	203	216	241	292	330	356	495	622	698
H(Open)	295	336	345	389	425	511	580	720	859
D	190	190	190	305	305	305	305	400	457
Weight(kg)	17	21	29	45	60	90	150	226	344

NRS GATE VALVE , RESILIENT SEALED Size DN50-DN600 PN16/ANSI 125 FIG · 3226-AWWA C509

Specification

- Valves comply with AWWA C509.
- Resilient sealing.
- Inside screw.
- Superior stem packing with O-rings.
- With brass sealing bushing for size 14" to 24"
- Packing replaceable under pressure.
- With high strength integral thrust collar.
- Available with handwheel or gearbox (bevel or spur gearbox).
- Available with flanges to EN1092-2 PN10 or PN16, ANSI B16.1 Class125 (Other types available on request).
- Face to face length in accordance with EN558-1 basic series 3, ASME B16.10-2000.

Working Pressure

- 16bar

Working Temperature

- -10°C to 120°C

Material Specification

Part Name	Materials	ASTM Spec.
Body	Size 2"-12"	Cast Iron
	Size 14"-24"	Ductile Iron
Bonnet	Size 2"-12"	Cast Iron
	Size 14"-24"	Ductile Iron
Wedge	Size 2"-12"	CI - EPDM encapsulated
	Size 14"-24"	DI - EPDM encapsulated
Stem Nut	Bronze	B62 C83600
Stem	Stainless Steel	AISI 420
O-ring	EPDM	Commercial
Gasket	EPDM	Commercial
Gland	Ductile Iron	A536 65-45-12
Handwheel	Ductile Iron	A536 65-45-12

Drawing and Picture

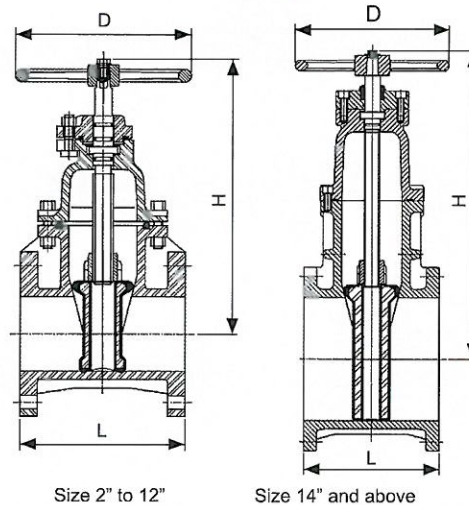

Corrosion Protection

- Internally and externally 250 microns minimum fusion bonded epoxy powder coated (FBE).

Notes: Design and material are subject to change without notice.

Dimensions (mm)

Size	50 2"	65 2-1/2"	80 3"	100 4"	150 6"	200 8"	250 10"	300 12"	350 14"	400 16"	450 18"	500 20"	600 24"
L	7 (178)	7-1/2 (191)	8 (203)	9 (229)	10-1/2 (267)	11-1/2 (292)	13 (330)	14 (356)	15 (381)	16 (406)	17 (432)	18 (457)	20 (508)
H	9-7/8 (250)	11 (280)	13-1/2 (342)	15-1/2 (342)	18-1/4 (464)	22-1/2 (573)	25-1/2 (649)	30-1/3 (771)	34-1/16 (865)	40-3/16 (1020)	40-9/16 (1030)	47-1/4 (1200)	53-3/8 (1355)
D	7-1/4 (184)	7-1/4 (184)	10 (254)	10 (254)	12 (305)	14 (356)	17-1/2 (445)	17-1/2 (445)	17-1/8 (445)	21-1/16 (535)	24 (610)	24 (610)	30 (762)
Weight(kg)	20	23.5	28	39	72	111	178	273	338	521	650	840	1215

NRS GATE VALVE , RESILIENT SEALED , MJ×MJ AND FL×MJ END Size DN50-DN300 PN16/ANSI125

FIG · 3648-MJ×MJ End , FIG · 3649-FL×MJ End

Specification

- Valves comply with AWWA C515.
- Resilient sealing.
- Inside screw.
- Superior stem packing with three O-rings, one primary O-ring seal, and dust seal.
- Packing replaceable under pressure.
- With high strength thrust collar.
- Available with handwheel, cap top or gearbox (bevel or spur gearbox).
- Available with flanges to EN1092-2 PN10 or PN16, ANSI B16.1 Class125 (Other types available on request).
- With Mechanical-Joint AWWA/ANSI C153/A21.53-00.

Drawing and Picture

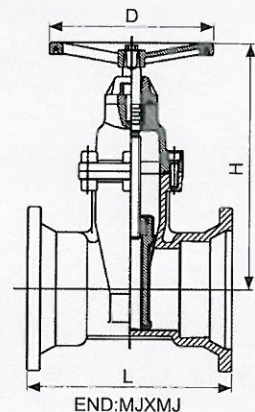
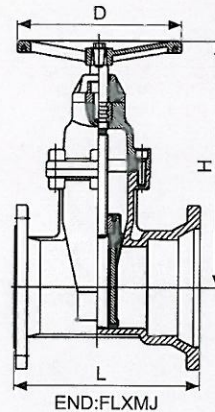

Working Pressure

- 16bar

Working Temperature

- -10°C to 120°C

Corrosion Protection

- Internally and externally 250 microns minimum fusion bonded epoxy powder coated (FBE).

Notes: Design and material are subject to change without notice.

Material Specification

Part Name	Materials	ASTM Spec.	EN Spec.	Part Name	Materials	ASTM Spec.	EN Spec.
Body	Ductile Iron	A536 65-45-12	EN-JS1050	O-ring	EPDM	Commercial	Commercial
Bonnet	Ductile Iron	A536 65-45-12	EN-JS1050	Gasket	EPDM	Commercial	Commercial
Wedge	DI with EPDM Coated	A536 65-45-12	EN-JS1050	Gland	Ductile Iron	A536 65-45-12	EN-JS1050
Thrust Collar	Brass	B16 C36000	2874 CZ 124	Wrench Nut	Ductile Iron	A536 65-45-12	EN-JS1050
Stem Nut	Brass	B16 C36000	2874 CZ 124	Handwheel	Ductile Iron	A536 65-45-12	EN-JS1050
Stem	Stainless Steel	AISI 420	BS970 420S37				

Dimensions (mm)

Size	DN50	DN80	DN100	DN150	DN200	DN250	DN300
L	MJ×MJ End	235	241	254	292	318	378
	FL×MJ End	206.5	222	241.3	279.5	305	367
H	240	280	305	417	525	621	711
D	175	255	255	305	355	405	405
Fig.3648 Weight (kg)	14.7	19.9	24.2	42.9	68.2	112.3	149.9
Fig.3649 Weight (kg)	14.1	19.2	23.3	41.3	65.7	108.2	144.4

NRS GATE VALVE , GROOVE END , METAL SEALED Size DN50-DN300 PN16

FIG · 3924-Stainless Steel Stem

Specification

- Valves comply with EN1171-2002, MSS SP-70.
- Metal seat.
- Inside screw.
- Adjustable stem seal.
- Packing replaceable under pressure.
- Available with handwheel or gearbox (bevel or spur gearbox).
- Available with groove to Metric or AWWA C606 standard.
- Face to face length in accordance with EN558-1 basic series 3 and ASME B16.10-2000.

Working Pressure

- 16bar

Working Temperature

- -10°C to 120°C

Material Specification

Part Name	Materials	EN Spec.	ASTM Spec.
Body	Ductile Iron	EN-JS1050	ASTM A536 65-45-12
Body Trim	Bronze	EN1982 CC491K	ASTM B62 C83600
Wedge Trim	Bronze	EN1982 CC491K	ASTM B62 C83600
Wedge	Ductile Iron	EN-JS1050	ASTM A536 65-45-12
Wedge Nut	Bronze	EN1982 CC491K	ASTM B62 C83600
Stem	Stainless Steel	BS970 420S37	AISI 420
Bonnet	Ductile Iron	EN-JS1050	ASTM A536 65-45-12
Gasket	Graphite	Non-asbestos	Non-asbestos
Stuffing Box	Ductile Iron	EN-JS1050	ASTM A536 65-45-12
Packing	Graphite	Non-asbestos	Non-asbestos
Handwheel	Ductile Iron	EN-JS1050	ASTM A536 65-45-12

Drawing and Picture

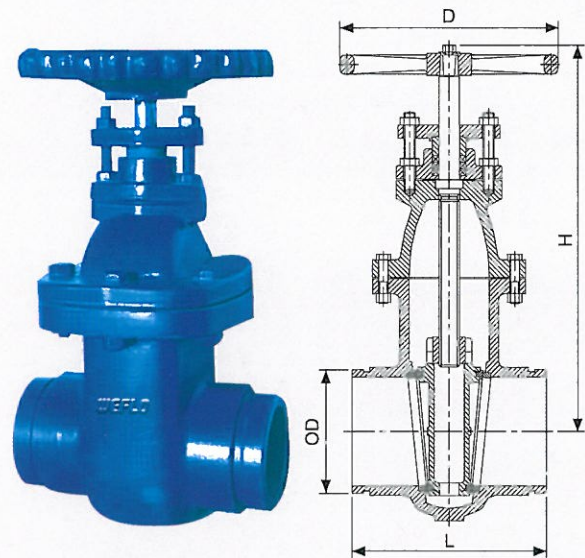

Corrosion Protection

- Internally and externally liquid epoxy painted.

Notes: Design and material are subject to change without notice.

Dimensions (mm)

Size	DN50	DN65	DN80	DN100	DN125	DN150	DN200	DN250	DN300
OD	60.3	73.0/76.0	88.9	114.3	139.7/141.3	165.1/168.3	219.1	273.0	323.9
L	178	191	203	229	254	267	292	330	356
H(Open)	260	276	300	355	409	467	606	750	835
D	190	190	190	250	305	305	356	405	457
Weight(kg)	16.0	20.0	24.0	38.0	50.0	60.0	110.0	200.0	280.0

OS&Y GATE VALVE , METAL SEALED Size DN50-DN300 PN16/ANSI125

FIG · 3193-Brass Stem , FIG · 3194-Stainless Steel Stem

Specification

- Valves comply with EN1171-2002 , MSS SP-70.
- Metal seat.
- Outside stem screw.
- Adjustable stem seal.
- Packing replaceable under pressure.
- Available with handwheel or gearbox (bevel or spur gearbox).
- Flanges to EN1092-2 PN10 or PN16, ANSI B16.1 Class125 (Other types available on request).
- Face to face length in accordance with EN558-1 basic series 3 and ASME B16.10-2000.

Working Pressure

- 16bar for EN1171 valves
- 200psi for MSS SP-70 valve

Material Specification

Part Name	Materials	EN Spec.	ASTM Spec.
Body	Ductile Iron	EN-JS1050	ASTM A536 65-45-12
Body Trim	Bronze	EN1982 CC491K	ASTM B62 C83600
Wedge Trim	Bronze	EN1982 CC491K	ASTM B62 C83600
Wedge	Ductile Iron	EN-JS1050	ASTM A536 65-45-12
Yoke Nut	Bronze	EN1982 CC491K	ASTM B62 C83600
Stem	Brass	CuZn39Pb3	ASTM B16 C36000
	Stainless Steel	BS970 420S37	AISI 420
Bonnet	Ductile Iron	EN-JS1050	ASTM A536 65-45-12
Gasket	Graphite	Non-asbestos	Non-asbestos
Gland	Ductile Iron	EN-JS1050	ASTM A536 65-45-12
Yoke	Ductile Iron	EN-JS1050	ASTM A536 65-45-12
Packing	Graphite	Non-asbestos	Non-asbestos
Handwheel	Ductile Iron	EN-JS1050	ASTM A536 65-45-12

Drawing and Picture

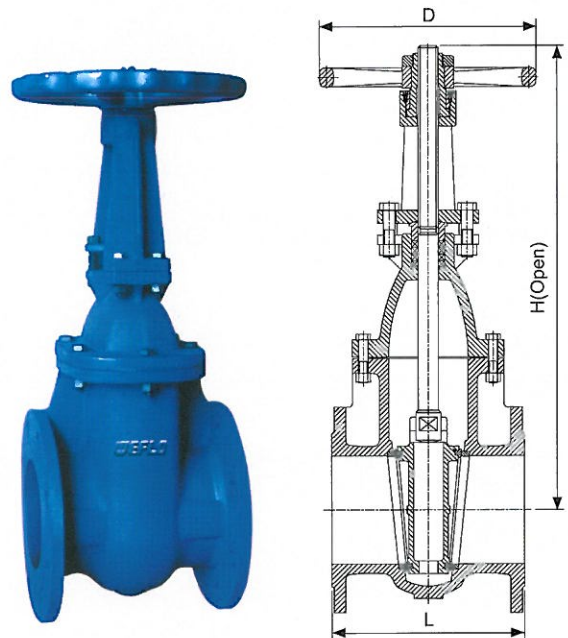

Working Temperature

- -10°C to 120°C

Corrosion Protection

- Internally and externally liquid epoxy painted.

Notes: Design and material are subject to change without notice.

Dimensions (mm)

Size	DN50	DN65	DN80	DN100	DN125	DN150	DN200	DN250	DN300
L	178	191	203	229	254	267	292	330	356
H(Open)	375	435	455	556	650	760	997	1197	1395
D	190	190	190	250	305	305	356	405	457
Weight(kg)	18.6	21.5	27	37	45.5	61	102	166.5	241

NRS GATE VALVE , METAL SEALED Size DN50-DN400 PN10

FIG · 3126

Specification

- Valves comply with DIN3352.
- Metal seat.
- Inside screw.
- O-ring stem seal.
- Handwheel operated.
- Flanges to EN1092-2 PN6 or PN10.
- Face to face length in accordance with DIN3202-F4.

Working Pressure

- 10bar for size DN40 to DN150
- 6bar for size DN200 to DN300
- 4bar for size DN350 to DN400

Working Temperature

- -10°C to 120°C

Corrosion Protection

- Internally and externally liquid epoxy painted.

Notes: Design and material are subject to change without notice.

Material Specification

Part Name	Materials	EN Spec.
Body	Cast Iron	EN-JL1040
Wedge	Cast Iron	EN-JL1040
Body Trim	Brass	CuZn39Pb3
Wedge Trim	Brass	CuZn39Pb3
Stem Nut	Brass	CuZn39Pb3
Stem	Stainless Steel	17440X20Cr13
Bonnet	Cast Iron	EN-JL1040
O-Ring	EPDM	Commercial
Gland	Cast Iron	EN-JL1040
Gasket	Graphite	Non-asbestos
Handwheel	Cast Iron	EN-JL1040

Drawing and Picture

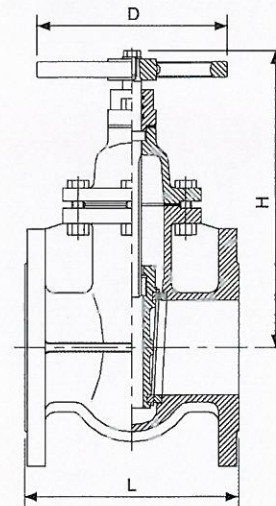

Dimensions (mm)

Size	40	50	65	80	100	125	150	200	250	300	350	400
L	140	150	170	180	190	200	210	230	250	270	290	310
H	230	210	230	265	303	375	430	524	650	740	810	885
D	140	140	160	160	185	200	240	240	360	360	405	405
Weight(kg)	10.0	11.8	15.0	19.0	26.5	35.0	50.0	60.0	218.0	128.0	285.0	325.0

OS&Y GATE VALVE , METAL SEALED Size DN50-DN300 PN16/ANSI125

FIG · 3119

Specification

- Valves comply with EN1171-2002 , BS3464.
- Metal seat.
- Outside screw.
- Adjustable stem seal.
- Packing replaceable under pressure.
- Available with handwheel or gearbox (bevel or spur gearbox).
- Flanges to EN1092-2 PN10 or PN16, ANSI B16.1 Class125 (Other types available on request).
- Face to face length in accordance with BS3464.

Working Pressure

- 16bar

Working Temperature

- -10°C to 120°C

Corrosion Protection

- Internally and externally liquid epoxy painted.

Notes: Seats are available integrally machined in body and wedge.
Design and material are subject to change without notice.

Material Specification

Part Name	Materials	EN Spec.	ASTM Spec.
Body	Cast Iron	EN-JL1040	ASTM A126 Class B
Body Trim	Bronze	EN1982 CC491K	ASTM B62 C83600
	CI Integral	EN-JL1040	ASTM A126 Class B
Wedge Trim	Bronze	EN1982 CC491K	ASTM B62 C83600
	CI Integral	EN-JL1040	ASTM A126 Class B
Wedge	Cast Iron	EN-JL1040	ASTM A126 Class B
Yoke Nut	Bronze	EN1982 CC491K	ASTM B62 C83600
Stem	Carbon Steel	BS970 050A20	AISI 1020
	Stainless Steel	BS970 420S37	AISI 420
Bonnet	Cast Iron	EN-JL1040	ASTM A126 Class B
Gasket	Graphite	Non-asbestos	Non-asbestos
Yoke	Cast Iron	EN-JL1040	ASTM A126 Class B
Packing	Graphite	Non-asbestos	Non-asbestos
Handwheel	Cast Iron	EN-JL1040	ASTM A126 Class B

Drawing and Picture

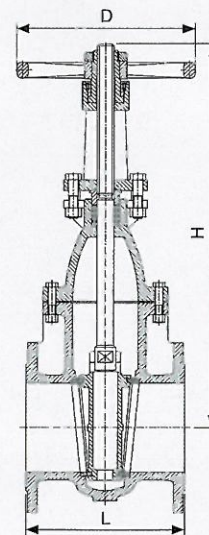

Dimensions (mm)

Size	DN50	DN65	DN80	DN100	DN125	DN150	DN200	DN250	DN300
L	146	159	165	171	191	210	241	273	305
H(Open)	380	415	462	602	725	830	1065	1228	1352
D	190	190	190	250	305	305	356	405	457
Weight(kg)	20.0	22.0	28.0	46.5	76.0	89.0	142.0	240.0	325.0

OS&Y GATE VALVE , METAL SEALED Size DN50-DN600 PN16/ANSI125

FIG · 3113-Brass Stem , FIG · 3114-Stainless Steel Stem

Specification

- Valves comply with EN1171-2002 , MSS SP-70.
- Metal seat.
- Outside stem screw.
- Adjustable stem seal.
- Packing replaceable under pressure.
- Available with handwheel or gearbox (bevel or spur gearbox).
- Flanges to EN1092-2 PN10 or PN16, ANSI B16.1 Class125 (Other types available on request).
- Face to face length in accordance with EN558-1 basic series 3 and ASME B16.10-2000.

Working Pressure

- 16bar for EN1171 valves
- 200psi for MSS SP-70 valve size 2"to 12"
- 150psi for MSS SP-70 valve size14"and above

Material Specification

Part Name	Materials	EN Spec.	ASTM Spec.
Body	Cast Iron	EN-JL1040	ASTM A126 Class B
Body Trim	Bronze	EN1982 CC491K	ASTM B62 C83600
Wedge Trim	Bronze	EN1982 CC491K	ASTM B62 C83600
Wedge	Cast Iron	EN-JL1040	ASTM A126 Class B
Yoke Nut	Bronze	EN1982 CC491K	ASTM B62 C83600
Stem	Brass	CuZn39Pb3	ASTM B16 C36000
	Stainless Steel	BS970 420S37	AISI 420
Bonnet	Cast Iron	EN-JL1040	ASTM A126 Class B
Gasket	Graphite	Non-asbestos	Non-asbestos
Yoke	Cast Iron	EN-JL1040	ASTM A126 Class B
Packing	Graphite	Non-asbestos	Non-asbestos
Handwheel	Cast Iron	EN-JL1040	ASTM A126 Class B

Drawing and Picture

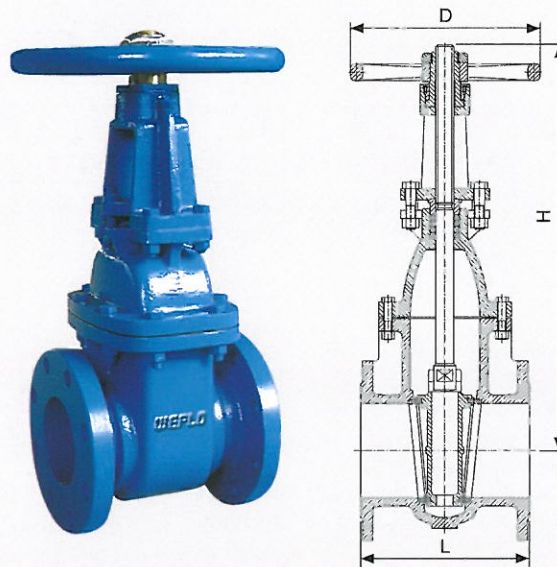

Working Temperature

- -10°C to 120°C

Corrosion Protection

- Internally and externally liquid epoxy painted.

Notes: Valve size DN50 to DN300 (2" to 12") available PN25 or Class250 with ductile Iron body and flanges to EN1092-2 PN25 or ANSI B16.2 Class250.

Design and material are subject to change without notice.

Dimensions (mm)

Size	DN50	DN65	DN80	DN100	DN125	DN150	DN200	DN250	DN300
L	178	191	203	229	254	267	292	330	356
H(Open)	405	415	486	632	710	842	1100	1228	1373
D	190	190	190	250	305	305	356	405	457
Weight(kg)	22.0	24.1	29.5	53.2	70.0	95.8	160.4	251.0	365.0

Size	DN350	DN400	DN450	DN500	DN600
L	381	406	432	457	508
H(Open)	1595	1900	2210	2600	3040
D	508	558	610	610	762
Weight(kg)	450.0	696.0	950.0	950.0	1520.0

Lever and Gear Operator



Ductile Iron Lever

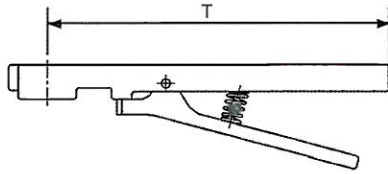

Steel Lever, FBE Coated

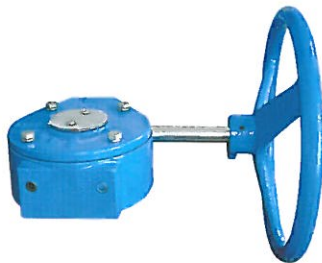
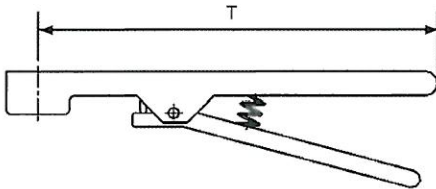

Gear Operator

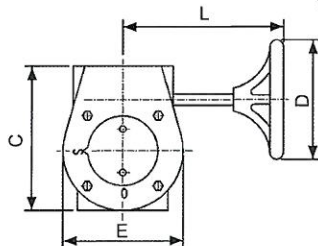
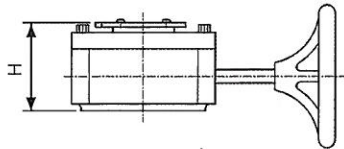

Dimensions (mm)

Valve Size	Part Number	T
DN50 ~DN150	2000 - S	263
DN200 ~DN300	2000 - M	326

Dimensions (mm)

Valve Size	Part Number	T
DN50 ~DN150	2001 - S	260
DN200 ~DN300	2001 - M	325

Dimensions (mm)

Valve Size	50~150	200~250	300~350	400~450	500~600
Part No.	2000-24	2000-30	2000-50	2000-80	2000-70
Ratio	24:1	30:1	50:1	80:1	70:1
L	165	238	230	275	250
H	65	85	95	125	125
D	190	295	297	390	390
E	108	153	161	255	264
C	130	180	198	281	303

Output Torque Max. (N.m)

Part No.	2000-24	2000-30	2000-50	2000-80	2000-70
Ratio	24:1	30:1	50:1	80:1	70:1
Output Torque Max.	270	700	1200	2000	4500

Materials Specification

Part Name	Material	EN Spec.	ASTM Spec.
Housing	Cast Iron	EN-JL1040	A126 Class B
Cover	Cast Iron	EN-JL1040	A126 Class B
Worm	Carbon Steel	BS970 060A47	AISI 1045
Worm Gear	Ductile Iron	EN-JS1050	A536 65-45-12
Shaft	Carbon Steel	BS970 060A47	AISI 1045
Handwheel	Cast Iron	EN-JL1040	A126 Class B

FLANGED BUTTERFLY VALVE Size DN350-DN2000 PN16

FIG · 2123

Specification

- Valves comply with EN593.
- EPDM/NBR rubber lined.
- Actuator-ready with top-flange in accordance to ISO5211-1.
- Gearbox operated.
- Flanges to EN1092-2 PN10/PN16 (Other types available on request).
- Face to Face dimensions conforms to EN558-1 basic series 13.

Working Pressure

- 16bar

Working Temperature

- -10°C to 120°C for EPDM Seat
- -10°C to 82°C for NBR Seat

Corrosion Protection

- Internally and externally liquid epoxy painted or fusion bonded epoxy powder coated (FBE).

Notes: Design and material are subject to change without notice.

Material Specification

Part	Materials	EN Spec.	ASTM Spec.
Body	Ductile Iron	EN-JS1050	ASTM A536 65-45-12
Shaft	Stainless Steel	BS970 431S29	AISI 431
Disc	SS304	BS970 304S15	AISI 304
	Ductile Iron	EN-JS1050	ASTM A536 65-45-12
Seat	EPDM/NBR	Commercial	Commercial
O-Ring	NBR	Commercial	Commercial

Drawing and Picture

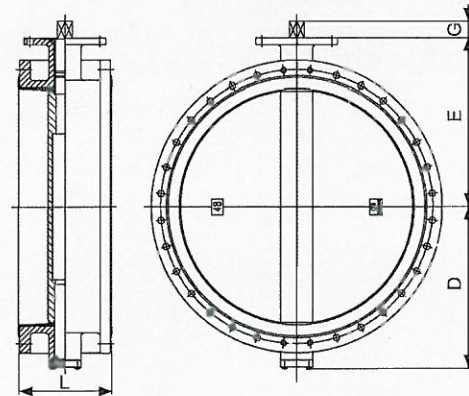

Dimensions (mm)

Size	350	400	450	500	600	700	750	800	900
L	190	216	222	229	267	292	318	318	330
D	288	322	341	381	450	486	525	538	632
E	330	375	397	446	520	585	585	610	690
G	45	65	65	65	65	65	65	85	85
Top Flange	F12	F14	F14	F16	F16	F25	F25	F25	F25
Weight (kg)	95	130	150	200	300	380	440	500	660

Size	1000	1050	1200	1300	1400	1500	1600	1800	2000
L	410	410	470	530	530	600	600	670	760
D	685	720	820	855	919	1008	1069	1200	1325
E	740	770	855	915	955	1067	1079	1277	1360
G	85	85	85	90	90	100	100	120	140
Top Flange	F25	F25	F35	F35	F35	F35	F35	F40	F40
Weight (kg)	900	1000	1310	1680	2050	2500	3500	4000	4550

AWWA C504 BUTTERFLY VALVE Size 3"-24" 150PSI/250PSI

FIG · 2102-SS Disc, FIG · 2103-DI Disc with SS Edge

Specification

- Valves comply with AWWA C504.
- Rubber lined.
- Actuator-ready with top-flange in accordance to ISO5211-1.
- Handle or gearbox operated.
- Flanges to ANSI B16.1 Class125 or ANSI B16.2 Class250.

Working Pressure

- 150psi for ANSI B16.1 Class125 flange
- 250psi for ANSI B16.2 Class250 flange
- MJXMJ end valve pressure can be both 150psi & 250psi

Working Temperature

- -10°C to 120°C for EPDM liner
- -10°C to 82°C for NBR liner
- -10°C to 150°C for Viton liner

Corrosion Protection

- Internally and externally liquid epoxy painted or fusion bonded epoxy powder coated (FBE).

Notes: Design and material are subject to change without notice.

Material Specification

Part Name	Material	ASTM Spec.
Body	Cast Iron	ASTM A126 Class B
Seat	EPDM/NBR/Viton	Commercial
Disc	Stainless Steel	A351 CF8/CF8M
	DI with SS316 edge	ASTM A536 65-45-12,
Stem	Stainless Steel	AISI 420
V-Packing	EPDM/NBR	Commercial
Cover Plate	Ductile Iron	ASTM A536 65-45-12

Drawing and Picture

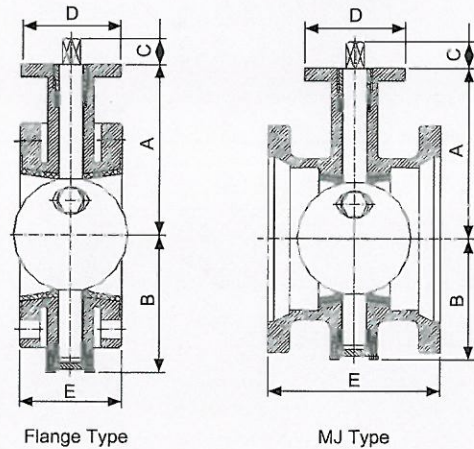
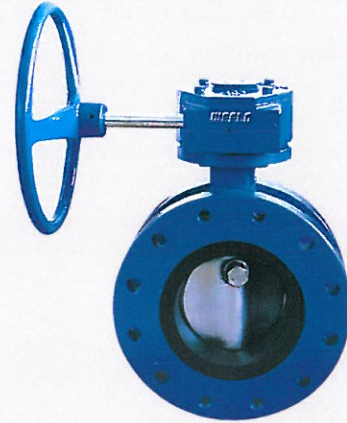

Dimensions (mm)

Size	3"	4"	6"	8"	10"	12"	14"	16"	18"	20"	24"
A	6-5/16 (160)	7-1/16 (179)	8-3/8 (213)	9-5/8 (245)	10-15/16 (277)	12-1/2 (318)	14-1/16 (357)	16-1/16 (408)	17-1/4 (438)	18-9/16 (472)	22-9/16 (573)
B	3-11/16 (93)	5-1/2 (140)	6-13/16 (173)	8 (204)	9-5/16 (237)	10-13/16 (278)	12-1/8 (308)	12-3/8 (315)	13 (331)	14-5/16 (363)	16-3/4 (425)
C	1-3/16 (30)	1-3/16 (30)	1-3/16 (30)	1-3/16 (30)	1-3/16 (30)	1-3/16 (30)	1-3/4 (45)	1-3/4 (45)	1-3/4 (45)	1-3/4 (45)	1-3/4 (45)
D	3-9/16 (90)	3-9/16 (90)	4-15/16 (125)	4-15/16 (125)	4-15/16 (125)	5-15/16 (150)	5-15/16 (150)	8-5/16 (210)	8-5/16 (210)	8-5/16 (210)	8-5/16 (210)
E	ANSI 125# FL.	5 (127)	5 (127)	5 (127)	6 (152)	8 (203)	8 (203)	8 (203)	8 (203)	8 (203)	8 (203)
	ANSI 250# FL.	5 (127)	5 (127)	5 (127)	6 (152)	8 (203)	8 (203)	8 (203)	8 (203)	8 (203)	8 (203)
	MJXMJ	8-1/2 (216)	8-1/2 (216)	8-1/2 (216)	8-5/8 (219)	9-1/4 (235)	9-1/4 (235)	11-1/2 (292)	12 (305)	12-1/4 (311)	12-1/2 (318)
Top Flange	F07	F07	F10	F10	F10	F12	F12	F16	F16	F16	F16
Weight (kg)	42.0	60.0	75.0	82.0	100.0	170.0	205.0	250.0	316.0	456.0	623.0

LUG BUTTERFLY VALVE
Size DN50-DN600 PN16/PN25/Class125/Class250

FIG · 2502-SS Disc, FIG · 2503-Bronze Disc, FIG · 2504-DI Disc

Specification

- Valves comply with EN593, BS5155, MSS SP-67.
- Replaceable rubber liner for size DN50 to DN300.
- Vulcanized rubber liner for size DN350 to DN600.
- With 4 locating holes for easier installation and centering.
- Actuator-ready with top-flange in accordance with ISO5211-1
- Handle or gearbox operated.
- Flanges to EN1092-2 PN10/PN16, ANSI B16.1 Class125 (Other types available on request).
- WRAS approved.

Working Pressure

- Size 50mm— 600mm 16 Bar
- Size 50mm— 300mm 25 Bar

Working Temperature

- -10°C to 120°C for EPDM liner
- -10°C to 82°C for NBR liner
- -10°C to 150°C for Viton liner

Corrosion Protection

- Internally and externally liquid epoxy painted or fusion bonded epoxy powder coated (FBE).

Notes:Ductile Iron body for PN25 or Class250 valves.
Design and material are subject to change without notice.

Material Specification

Part Name	Material	EN Spec.	ASTM Spec.
Body*	Cast Iron	EN-JL1040	ASTM A126 Class B
Shaft	Stainless Steel	BS970 420S37	AISI 420
	Stainless Steel	BS970 304S15	A351 CF8
Disc	Bronze	EN1982 CC491K	ASTM B62 C83600
	Ductile Iron ChromePlated or FBE Coated	EN-JS1050	ASTM A536 65-45-12
Bushing	PTFE	Commercial	Commercial
Liner	EPDM/NBR/Viton	Commercial	Commercial
O-Ring	EPDM/NBR/Viton	Commercial	Commercial

Drawing and Picture

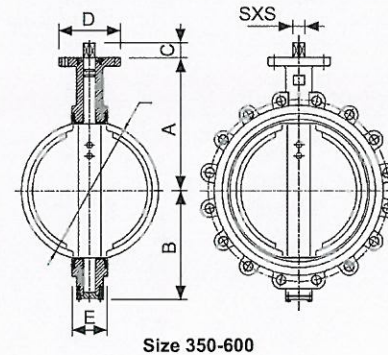
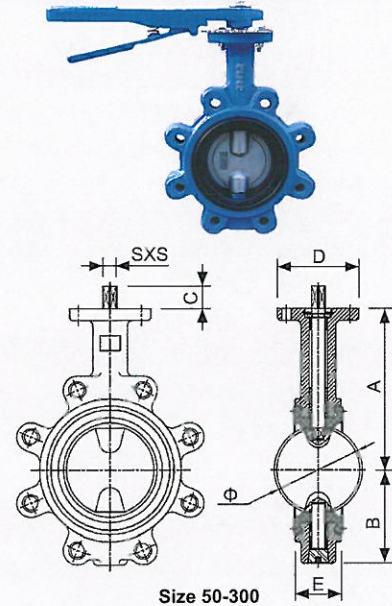

Dimensions (mm)

Size	50	65	80	100	125	150	200	250	300	350	400	450	500	600
A	140	152	160	180	191	202	237	274	313	368	400	422	480	562
B	68	76	85	100	120	132	164	200	230	288	315	344	388	450
C	30	30	30	30	30	30	30	30	30	45	45	45	45	45
D	90	90	90	90	90	90	125	125	125	150	175	175	210	210
E	43	45	46	51.5	56	56.5	60	68.5	79.5	78	88	109	127	154
Φ	56.8	71.5	83	101.5	127.8	151.1	200.5	251.3	300.5	335.5	393.5	443.5	500.5	600.8
SxS	11x11		14x14			17x17		22x22			27x27		φ48	
Top Flange	F07	F07	F07	F07	F07	F07	F10	F10	F10	F12	F14	F14	F16	F16
Weight (kg)	4.6	5.6	5.9	7.7	10.2	12.5	17.5	28	38	10	120	135	180	233

FIRE HYDRANT DN80 BS750 TYPE II PN16 FIG · 9207

Specification

- Complies with BS750 Type II.
- Seating type is resilient material to DI integral seat.
- Flange drilled to DN80 EN1092-2 PN16 and BS10 Table E.
- 2-1/2" London Round Thread outlet. Other type outlets are available, such as 2-1/2" Instantaneous outlet, 2-1/2" Belfast V outlet and Dublin Bayonet outlet.
- Bottom drain connection.
- Fusion bonded epoxy coated interior and exterior.
- WRAS approved.

Working Pressure

- 16bar

Working Temperature

- -10°C to 120°C

Corrosion Protection

- Internally and externally fusion bonded epoxy powder coated (FBE).

Drawing and Picture

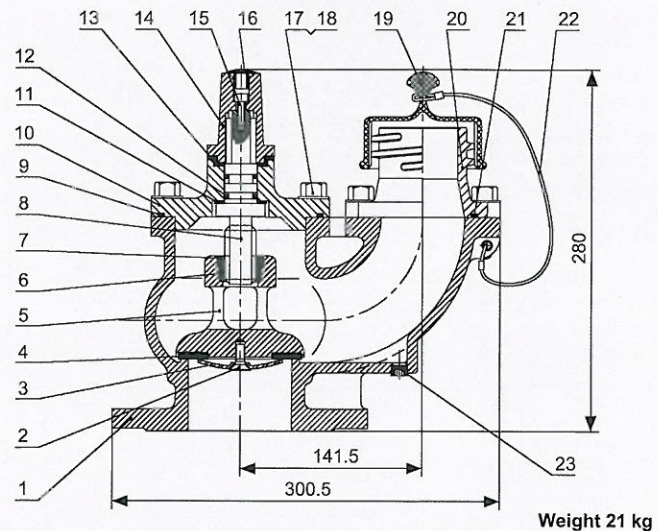

Weight 21 kg

Notes: Design and material are subject to change without notice.

Material Specification

No.	Component	ASTM Spec.	No.	Part Name	ASTM Spec.
1	Body	DI ASTM A536 65-45-12	13	Cap Gasket	Plastic
2	Bolt	Stainless Steel AISI 304	14	Driver Cap	C.I. ASTM A126 class B
3	Holder	Stainless Steel AISI 304	15	Bolt	Stainless Steel AISI 201
4	Gasket	NBR	16	Indicator Cap	Plastic
5	Disc	DI ASTM A536 65-45-12	17	Bolt	Stainless Steel AISI 201
6	Stem Nut	Brass ASTM B16 C36000	18	Washer	Stainless Steel AISI 201
7	Screw	Steel	19	Dust Cap	Plastic
8	Stem	Stainless Steel AISI 420	20	Outlet	Brass ASTM B16 C36000
9	O-Ring	NBR	21	O-Ring	NBR
10	Cover	D.I. ASTM A536 65-45-12	22	Rope	Stainless Steel
11	Washer	Copper	23	Plug	Plastic
12	O-Ring	NBR			

Y-STRAINER GROOVE ENDS 175PSI FIG · F0522-175

Specification

- NPT or BSPT blowoff outlet on cover. Blowoff outlets are finished with plugs.
- Screens are perforated 304 stainless steel with spot welded seam.
- Recessed seat in body assures accurate screen alignment.
- Groove dimension comply with Metric or AWWA C606 standard.
- UL listed.

Working Pressure

- 175PSI

Working Temperature

- -10°C to 120°C

Corrosion Protection

- Internally and externally liquid epoxy painted or fusion bonded epoxy powder coated (FBE).

Notes: Design and material are subject to change without notice.

Material Specification

Component	Material
Body	Ductile Iron ASTM A536 Gr. 70-50-05
Cover	Ductile Iron ASTM A536 Gr. 70-50-05
Screen	Stainless Steel AISI 304
Gasket	PTFE/Graphite
Plug	Ductile Iron ASTM A536 Gr. 70-50-05

Standard Screens

Size (mm/inch)	Hole Dia.(mm)	Free Flow Area(%)
65(2-1/2")	2.54	38.5
80-200(3" -8")	4	48
250 (10")	4.7	50.5
300 (12")	6.3	57.2

Dimensions (mm/inch)

Size	Pipe O.D.		A		B		Plug Size (NPT Thread)	Weight(kg)
	mm	inch	mm	inch	mm	inch		
65mm / 2-1/2"	73.0	2-7/8	285.0	11-1/4	215.0	8-1/2	1"	10.7
	76.1	3						
80mm / 3"	88.9	3-1/2	318.0	12-1/2	219.0	8-5/8	1"	13.4
100mm / 4"	114.3	4-1/2	375.0	14-3/4	254.0	10	1"	21
125mm / 5"	139.7	5-1/2	448.0	17-5/8	322.0	12-11/16	1-1/4"	35.6
	141.3	5-9/16						
150mm / 6"	165.1	6-1/2	502.0	19-3/4	365.0	14-3/8	1-1/2"	54.2
	168.3	6-5/8						
200mm / 8"	219.1	8-5/8	640.0	25-3/16	462.0	18-3/16	1-1/2"	100.4
250mm / 10"	273.0	10-3/4	710.0	27-15/16	540.0	21-1/4	2"	141
300mm / 12"	323.9	12-3/4	780.0	30-11/16	610.0	24	2"	233

Drawing and Picture

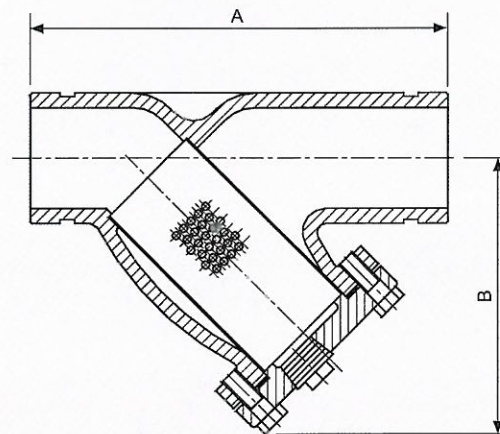

DOUBLE DOOR CHECK VALVE 175PSI

FIG · F0411-175

Specification

- The extremely short face to face dimension and compact design of this valve allow installation and service in tight spaces.
- Spring assisted for better dynamic behaviour.
- Soft seated for perfect tightness even at low differential pressure.
- Flanges ANSI B16.1 Class125.
- UL listed.

Working Pressure

- 175PSI

Working Temperature

- -10°C to 120°C

Corrosion Protection

- Internally and externally spray-painted or fusion bonded epoxy powder coated (FBE).

Drawing and Picture

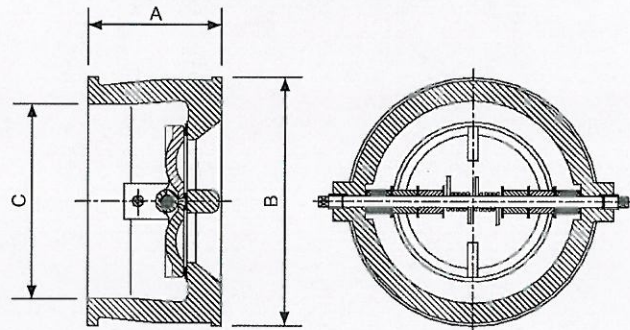
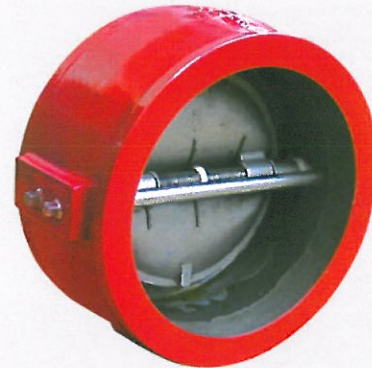

Notes: Design and material are subject to change without notice.

Material Specification

Component	Material	Component	Material
Body	Cast Iron ASTM A126 Class B	Washer	PTFE
Stop Pin	Stainless Steel AISI 416	Spacer	PTFE
Hinge Pin	Stainless Steel AISI 416	Disc	Stainless Steel ASTM CF8
Seat	EPDM	Spring	Stainless Steel AISI 304
Pin Retainer	Stainless Steel AISI 416	Lifting Hook	Carbon Steel (Not Shown, only for 8", 10" & 12")
Gasket	PTFE		

Dimensions (mm/inch)

Size	100mm / 4"		150mm / 6"		200mm / 8"		250mm / 10"		300mm / 12"	
	mm	inch	mm	inch	mm	inch	mm	inch	mm	inch
A	93	3-11/16	105	4-1/8	121	4-3/4	154	6-1/16	187	7-3/8
B	172	6-3/4	220	8-11/16	280	11	340	13-3/8	410	16-1/8
C	136	5-3/8	178	7	230	9-1/16	285	11-1/4	338	13-5/16
Weight(kg)	8.4		13.5		23		42		68	

**SWING CHECK VALVE
FLANGE ENDS 300PSI
FIG · F0311-300**

Specification

- Valves comply with AWWA C508, clear waterway design.
- Seating type is resilient material to bronze seat construction.
- Two brass plugs screwed on one side of body.
- Flanges to EN1092-PN10/PN16, ANSI B16.1 Class125. (Other types available on request).
- FM and UL approved.

Working Pressure

- 300PSI
- 200PSI and 250PSI available on request

Working Temperature

- 0.6°C to 52°C

Corrosion Protection

- Internally and externally fusion bonded epoxy powder coated (FBE).

Drawing and Picture

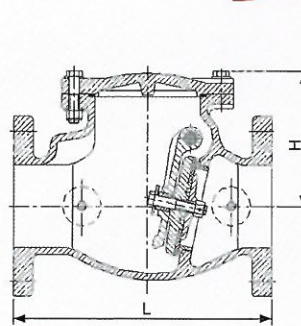
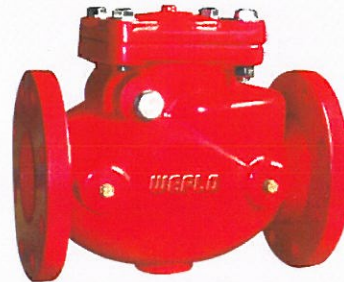

Size 2" to 4"

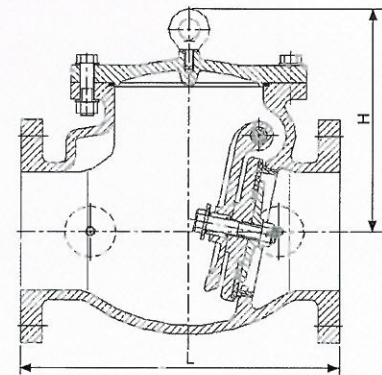

Size 5" to 12"

Notes: Design and material are subject to change without notice.

Material Specification

Part Name	Material	ASTM Spec.	Part Name	Material	ASTM Spec.
Body	Ductile Iron	A536 65-45-12	Gasket	EPDM	Commercial
Seat Ring	Bronze	ASTM B62	Hinge Pin	Stainless Steel	AISI 304
Disc Ring	EPDM	Commercial	Clapper Arm	Ductile Iron	A536 65-45-12
Disc Ring Retainer	Bronze	ASTM B62	Pin Plug	Stainless Steel	AISI 304
Retainer Bolt	Stainless Steel	AISI 304	NPT Plug	Brass	B16 C36000
Disc	Ductile Iron	A536 65-45-12	Bolt and Nut	Carbon Steel	A307 B
Bonnet	Ductile Iron	A536 65-45-12	Eyebolt	Carbon Steel	A307 B

Dimensions (mm/inch)

Size	2"	2.5"	3"	4"	5"	6"	8"	10"	12"	
L	mm	203	254	279	330	356	406	495	559	660
	inch	8	10	11	13	14	16	19-1/2	22	26
H	mm	132	145	150	175	298	300	352	395	445
	inch	5-3/16	5-11/16	5-7/8	6-7/8	11-3/4	11-13/156	13-7/8	15-9/16	17-1/2
Weight(kg)	11.5	13	17	25	40	50	58.3	218	282	

VERTICAL INDICATOR POST FIG · F0600-IP

Specification

- Indicates if the valve is in the open or shut position.
- The indicator post provides a means to operate a buried or otherwise inaccessible valve.
- The adjustment range of the indicator post is 34.5" to suit the deeper buried valve and can be easily adjusted in the field.
- The wrench handle fits over a "U" bracket on the barrel, and may be fixed with a padlock to secure the operating wrench to the barrel.
- Can be supplied to open left or right.

FM and UL approved.

Material Specification

No.	Component	Material
1	Hex Cap Screw	Carbon Steel ASTM A307B
2	Hex Nut	Carbon Steel ASTM A307B
3	Crane Coupling	Ductile Iron ASTM A536 Gr. 65-45-12
4	Cotter Pin	Stainless Steel AISI 304
5	Base Flange	Cast Iron ASTM A126 Class B
6	Hex Nut	Carbon Steel ASTM A307B
7	Hex Cap Screw	Carbon Steel ASTM A307B
8	Standpipe	Carbon Steel ASTM A53
9	Stem 1" Square	Carbon Steel AISI1045
10	Body	Cast Iron ASTM A126 Class B
11	Locking Wrench	Bronze ASTM B62 C83600
12	Target Carrier Nut	Cast Iron ASTM A126 Class B Stainless Steel AISI 304
13	Hex Cap Screw	Carbon Steel ASTM A307B
14	Hex Nut	Carbon Steel ASTM A307B
15	Hex Cap Screw	Carbon Steel ASTM A307B
16	Target	Cast Aluminium
17	Window Glass	Plexiglass
18	Gasket	PTFE
19	Operating Nut	Bronze ASTM B62 C83600 Stainless Steel AISI 304
20	Top Section	Cast Iron ASTM A126 Class B
21	Snap Ring	Stainless Steel AISI1066
22	Plug	Malleable Iron
23	Square Nut	Carbon Steel ASTM A307B
24	Hex Cap Screw	Carbon Steel ASTM A307B

Corrosion Protection

- Internally and externally red epoxy coated RAL3000.

Notes: Design and material are subject to change without notice.

Drawing and Picture

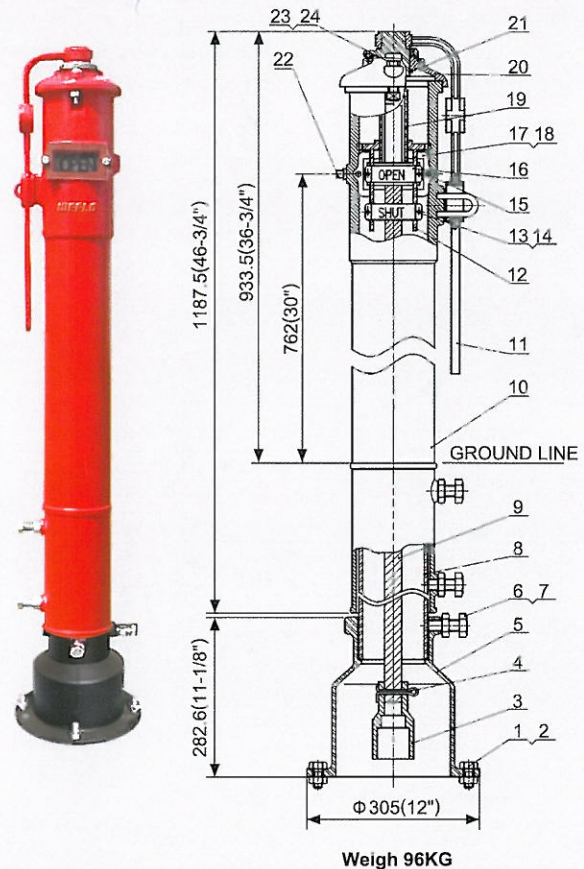

Field Adjustment

- Remove the Top Section from the top of the Indicator Post assembly.
- Cut the required stem length and adjust the Standpipe to match up to the Ground Line.
- Set the "OPEN" and "SHUT" targets for the appropriate valve size.
- Reattach the Top Section to the top of the Indicator Post assembly.

**NRS RESILIENT SEALED GATE VALVE
GROOVE ENDS 300PSI
FIG · F0222-300**

Specification

- Valves comply with AWWA C515
- Valves with an indicator post flange and a 2" square wrench nut.
- Triple O-rings stem seal.
- NPT brass plug on body
- Groove to Metric or AWWA C606 standard
- FM and UL approved

Working Pressure

- 300PSI
- 200PSI and 250PSI available on request

Working Temperature

- 0.6°C to 52°C

Corrosion Protection

- Internally and externally fusion bonded epoxy powder coated (FBE).

Notes: Design and material are subject to change without notice.

Material Specification

Part Name	Material	ASTM Spec.
Body	Ductile Iron	A536 65-45-12
Wedge	Ductile Iron with EPDM Coated	
Wedge Nut	Bronze	ASTM B62
Stem	Stainless Steel	AISI 420
Thrust Collar	Bronze	ASTM B62
Bonnet	Ductile Iron	A536 65-45-12
Gasket	EPDM	Commercial
Gland	Ductile Iron	A536 65-45-12
O-ring	EPDM	Commercial
Post Flange	Ductile Iron	A536 65-45-12
Operating Nut	Ductile Iron	A536 65-45-12
NPT Plug	Brass	B16, C36000
Indicator Flange Bolts	Stainless Steel	AISI 316
Bonnet Bolts	Carbon Steel	A307 B

Drawing and Picture

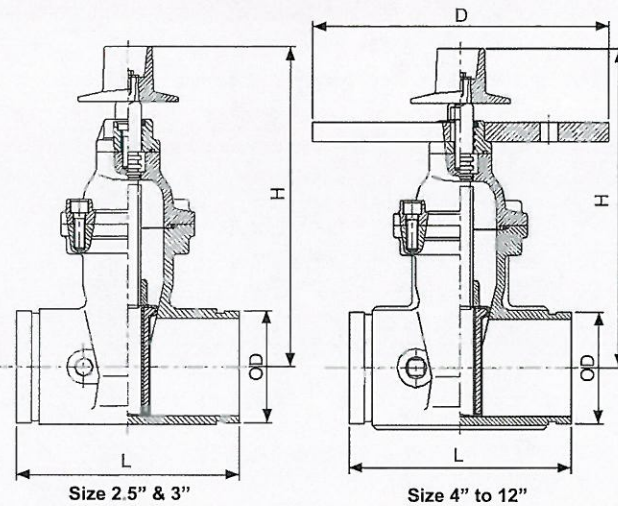

Dimensions (mm/inch)

Size	2-1/2"		3"		4"		5"		6"		8"		10"		12"	
	mm	inch	mm	inch	mm	inch	mm	inch	mm	inch	mm	inch	mm	inch	mm	inch
OD	73.0	2-7/8	88.9	3-1/2	114.3	4-1/2	139.7	5-1/2	165.1	6-1/2	219.1	8-5/8	273.0	10-3/4	323.9	12-3/4
	76.1	3					141.3	5-9/16	168.3	6-5/8						
L	190.5	7-1/2	203	8	229	9	254	10	267	10-1/2	292	11-1/2	330	13	356	14
H	270	10-5/8	296	11-5/8	350	13-3/4	410	16-1/8	455	17-15/16	545	21-7/16	645	25-3/8	730	28-3/4
D	--	--	--	--	305	12	305	12	305	12	305	12	305	12	305	12
Weight(kg)	11.3		13.6		28		36.5		43.5		66		103		144	

NRS RESILIENT SEALED GATE VALVE FLANGE ENDS 300PSI FIG · F0211-300

Specification

- Valves comply with AWWA C515.
- No rising stem.
- With indicator post flange and a 2" square operating nut.
- Triple O-ring stem seal.
- NPT brass plug on body.
- Flange designed to EN1092-2 PN10 / PN16, ANSI B16.1 Class125 (Others available on request) .
- FM and UL approved.

Working Pressure

- 300PSI

Working Temperature

- 0.6°C to 52°C

Corrosion Protection

- Internally and externally fusion bonded epoxy powder coated (FBE).

Notes: Design and material are subject to change without notice.

Material Specification

Part Name	Material	ASTM Spec.
Body	Ductile Iron	A536 65-45-12
Wedge	Ductile Iron with EPDM Coated	
Wedge Nut	Bronze	ASTM B62
Stem	Stainless Steel	AISI 420
Thrust Collar	Bronze	ASTM B62
Bonnet	Ductile Iron	A536 65-45-12
Gasket	EPDM	Commercial
Gland	Ductile Iron	A536 65-45-12
O-ring	EPDM	Commercial
Post Flange	Ductile Iron	A536 65-45-12
Operating Nut	Ductile Iron	A536 65-45-12
NPT Plug	Brass	B16, C36000
Indicator Flange Bolts	Stainless Steel	AISI 316
Bonnet Bolts	Carbon Steel	A307 B

Drawing and Picture

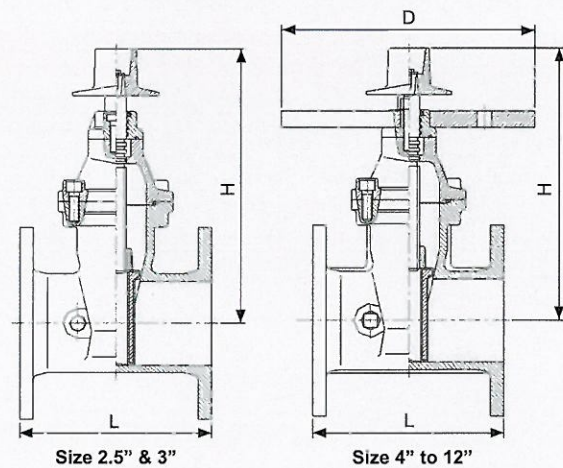

Dimensions (mm/inch)

Size	2-1/2"		3"		4"		5"		6"		8"		10"		12"	
	mm	inch	mm	inch	mm	inch	mm	inch	mm	inch	mm	inch	mm	inch	mm	inch
L	190.5	7-1/2	203	8	229	9	254	10	267	10-1/2	292	11-1/2	330	13	356	14
H	270	10-5/8	296	11-5/8	350	13-3/4	410	16-1/8	455	17-15/16	545	21-7/16	645	25-3/8	730	28-3/4
D	--	--	--	--	305	12	305	12	305	12	305	12	305	12	305	12
Weight(kg)	16.5		23		30		35		50		75		110		164	

NRS RESILIENT SEALED GATE VALVE FLANGE ENDS 200PSI FIG · F0211-200

Specification

- Valves comply with AWWA C515.
- No rising stem.
- With indicator post flange and a 2" square operating nut.
- Triple O-ring stem seal.
- NPT brass plug on body.
- Flange designed to EN1092-2 PN10 / PN16, ANSI B16.1 Class125 (Others available on request) .
- FM and UL approved.

Working Pressure

- 200PSI

Working Temperature

- 0.6°C to 52°C

Corrosion Protection

- Internally and externally fusion bonded epoxy powder coated (FBE).

Notes: Design and material are subject to change without notice.

Material Specification

Part Name	Material	ASTM Spec.
Body	Ductile Iron	A536 65-45-12
Wedge	Ductile Iron with EPDM Coated	
Wedge Nut	Bronze	ASTM B62
Stem	Stainless Steel	AISI 420
Thrust Collar	Bronze	ASTM B62
Bonnet	Ductile Iron	A536 65-45-12
Gasket	EPDM	Commercial
Gland	Ductile Iron	A536 65-45-12
O-ring	EPDM	Commercial
Post Flange	Ductile Iron	A536 65-45-12
Operating Nut	Ductile Iron	A536 65-45-12
NPT Plug	Brass	B16, C36000
Indicator Flange Bolts	Stainless Steel	AISI 316
Bonnet Bolts	Carbon Steel	A307 B

Drawing and Picture

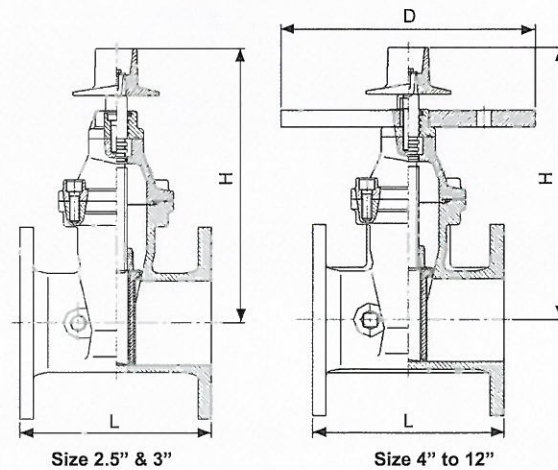

Dimensions (mm/inch)

Size	2-1/2"		3"		4"		5"		6"		8"		10"		12"	
	mm	inch	mm	inch	mm	inch	mm	inch	mm	inch	mm	inch	mm	inch	mm	inch
L	190.5	7-1/2	203	8	229	9	254	10	267	10-1/2	292	11-1/2	330	13	356	14
H	270	10-5/8	296	11-5/8	350	13-3/4	410	16-1/8	455	17-15/16	545	21-7/16	645	25-3/8	730	28-3/4
D	--	--	--	--	305	12	305	12	305	12	305	12	305	12	305	12
Weight(kg)	16.5		23		30		35		50		75		110		164	

OS&Y RESILIENT SEALED GATE VALVE FLANGE ENDS 300PSI FIG · F0111-300

Specification

- Valves comply with AWWA C515.
- The handwheel is attached to the yoke by a heavy duty nut.
- High quality graphite stem seal.
- NPT brass plug on body.
- Flanges EN1092-2 PN10 / PN16, ANSI B16.1 Class125 (Others available on request).
- FM and UL approved.

Working Pressure

- 300PSI

Working Temperature

- 0.6°C to 52°C

Corrosion Protection

- Internally and externally fusion bonded epoxy powder coated (FBE).

Notes: Design and material are subject to change without notice.

Material Specification

Part Name	Material	ASTM Spec.
Body	Ductile Iron	A536 65-45-12
Wedge	Ductile Iron, EPDM Encapsulated	
Wedge Nut	Stainless Steel	AISI 304
Stem	Stainless Steel	AISI 420
Bonnet	Ductile Iron	A536 65-45-12
Gasket	EPDM	Commercial
Packing	Graphite	Commercial
Gland	Ductile Iron	A536 65-45-12
Yoke Nut	Bronze	ASTM B62
Handwheel	Ductile Iron	A536 65-45-12
Handwheel Nut	Ductile Iron	A536 65-45-12
NPT Plug	Brass	B16, C36000
Gland Bolts	Stainless Steel	AISI 316
Bonnet Bolts	Carbon Steel	A307 B

Drawing and Picture

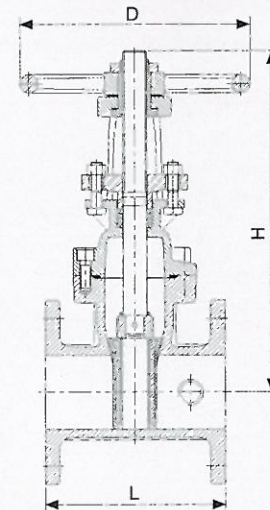

Dimensions (mm/inch)

Size	2.5"		3"		4"		5"		6"		8"		10"		12"	
	mm	inch	mm	inch	mm	inch	mm	inch	mm	inch	mm	inch	mm	inch	mm	inch
L	190.5	7-1/2	203	8	229	9	254	10	267	10-1/2	292	11-1/2	330	13	356	14
H(Open)	415	16-5/8	480	18-7/8	550	21-5/8	655	25-4/5	740	29-1/8	930	36-5/8	1130	44-1/2	1320	52
H(Close)	350	13-3/4	400	15-3/4	450	17-3/4	530	20-7/8	590	23-1/4	730	28-3/4	880	34-3/4	1020	40-1/6
D	184	7-1/4	254	10	254	10	305	12	305	12	356	14	445	17-1/2	445	17-1/2
Weigh(kg)	20		25		30		42		50		77		120		170	

**OS&Y RESILIENT SEALED GATE VALVE
FLANGE ENDS 200PSI
FIG · F0111-200**

Specification

- Valves comply with AWWA C515
- The handwheel is attached to the yoke by a heavier nut.
- High quality graphite stem seal.
- NPT brass plug on body.
- One brass plug screwed on body
- Flanges EN1092-2 PN10 / PN16, ANSI B16.1 Class125 (Others available on request).
- FM and UL approved

Working Pressure

- 200PSI

Working Temperature

- 0.6°C to 52°C

Corrosion Protection

- Internally and externally fusion bonded epoxy powder coated (FBE).

Notes: Design and material are subject to change without notice.

Material Specification

Part Name	Material	ASTM Spec.
Body	Ductile Iron	A536 65-45-12
Wedge	Ductile Iron, EPDM Encapsulated	
Wedge Nut	Stainless Steel	AISI 304
Stem	Stainless Steel	AISI 420
Bonnet	Ductile Iron	A536 65-45-12
Gasket	EPDM	Commercial
Packing	Graphite	Commercial
Gland	Ductile Iron	A536 65-45-12
Yoke Nut	Bronze	ASTM B62
Handwheel	Ductile Iron	A536 65-45-12
Handwheel Nut	Ductile Iron	A536 65-45-12
NPT Plug	Brass	B16, C36000
Gland Bolts	Stainless Steel	AISI 316
Bonnet Bolts	Carbon Steel	A307 B

Drawing and Picture

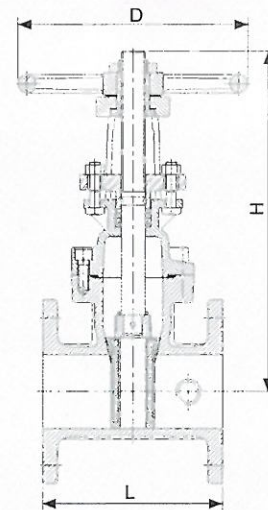

Dimensions (mm/inch)

Size	2.5"		3"		4"		5"		6"		8"		10"		12"	
	mm	inch	mm	inch	mm	inch	mm	inch	mm	inch	mm	inch	mm	inch	mm	inch
L	190.5	7-1/2	203	8	229	9	254	10	267	10-1/2	292	11-1/2	330	13	356	14
H(Open)	415	16-5/8	480	18-7/8	550	21-5/8	655	25-4/5	740	29-1/8	930	36-5/8	1130	44-1/2	1320	52
H(Close)	350	13-3/4	400	15-3/4	450	17-3/4	530	20-7/8	590	23-1/4	730	28-3/4	880	34-3/4	1020	40-1/6
D	184	7-1/4	254	10	254	10	305	12	305	12	356	14	445	17-1/2	445	17-1/2
Weight(kg)	20		25		30		42		50		77		120		170	

Groove Butterfly Valve Gear Operated, 300PSI FIG · F1022-300

Specification

- Vulcanized disc design for bubble-tight shutoff at 300 psi.
- Flag type position indicator.
- Low torque operation, high cycle life.
- With built-in supervisory switch.
- Top flange to ISO 5211/1.
- With groove to Metric or AWWA C606 standard.
- UL listed.

Working Pressure

- 300PSI
- 200PSI and 250PSI available on request

Working Temperature

- 0.6°C to 52°C

Corrosion Protection

- Internally and externally fusion bonded epoxy powder coated (FBE).

Notes: Design and material are subject to change without notice.

Drawing and Picture



Installation of Gear Operator With Tamper Switch

Butterfly valves are provided with internal supervisory position switches. The tamper switch operates by a cam connected to the valve stem. The switch will change position and close within two (2) full turns of the handwheel from the fully open position.

Switch #1:

For connection to the supervisory circuit

Normally closed: 2 Yellow

Normally open: 2 Red

Common: 2 White

Switch #2:

Auxiliary switch connected per authority

Normally closed: 1 Blue

Normally open: 1 Orange

Common: 1 Black

Ground Lead: 1 Green

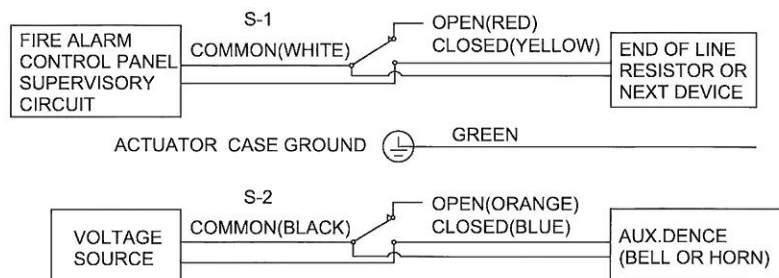

- NOTES 1. Item No. : VSION 021 C2
2. Rated : 10A 125-250VAC

Wafer Butterfly Valve Gear Operated, 300PSI FIG · F0811-300

Specification

- Single piece through shaft.
- Vulcanized seat design for bubble-tight shutoff at 300 psi.
- Flag type position indicator.
- Low torque operation, high cycle life.
- With built-in supervisory switch.
- Top flange to ISO 5211/1.
- Flanges designed to EN1092-2 PN10 / PN16, ANSI B16.1 Class125 (Other types available on request).
- UL listed.

Working Pressure

- 300PSI
- 200PSI and 250PSI available on request

Working Temperature

- 0.6°C to 52°C

Corrosion Protection

- Internally and externally fusion bonded epoxy powder coated (FBE).

Notes: Design and material are subject to change without notice.

Drawing and Picture

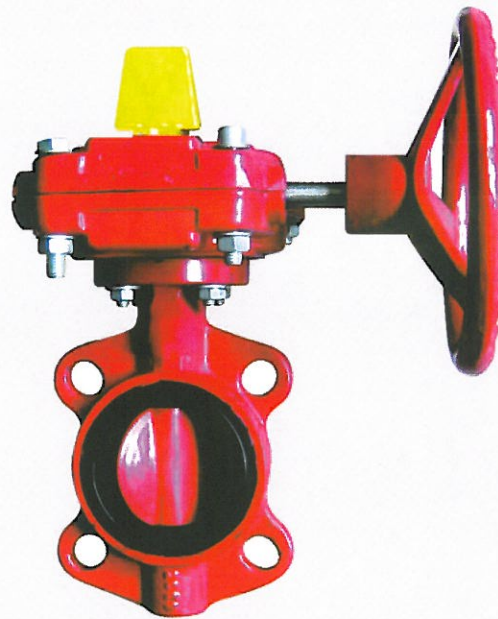

Installation of Gear Operator With Tamper Switch

Butterfly valves are provided with internal supervisory position switches. The tamper switch operates by a cam connected to the valve stem. The switch will change position and close within two (2) full turns of the handwheel from the fully open position.

Switch #1:

For connection to the supervisory circuit

Normally closed: 2 Yellow

Normally open: 2 Red

Common: 2 White

Switch #2:

Auxiliary switch connected per authority

Normally closed: 1 Blue

Normally open: 1 Orange

Common: 1 Black

Ground Lead: 1 Green

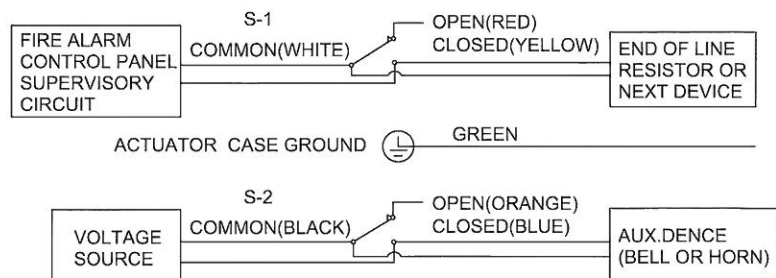

- NOTES
1. Item No. : VSION 021 C2
 2. Rated : 10A 125-250VAC