

Valve Specification	Fig. No.	Page
• NRS Gate Valve, Resilient Sealed, MJ×MJ and FL×MJ End	Fig.3648/3649	43
• OS&Y Gate Valve, Resilient Sealed	Fig.3233	44
• NRS Gate Valve, Resilient Sealed, DN50-600	Fig.3226	45
• NRS Gate Valve, Resilient Sealed, DN750-1800	Fig.3226	46
• Globe Valve	Fig.6123	47
• DIN Globe Valve	Fig.6125	48
• Triple Duty Valve	Fig.1118/1918	49
• Swing Check Valve	Fig.5101/5102	50
• Swing Check Valve with Lever & Weight or Lever & Spring	Fig.5108/5110	51
• DIN Swing Check Valve	Fig.5201/5202	52
• Grooved End Swing Check Valve	Fig.5904	53
• Wafer Swing Check Valve	Fig.5301	54
• Wafer Double Door Check Valve	Fig.5304	55
• Wafer Double Door Check Valve	Fig.5306	56
• Wafer Silent Check Valve	Fig.5312	57
• Grooved End Double Door Check Valve	Fig.5905/5906	58
• Silent Check Valve	Fig.5104/5105	59
• Globe Silent Check Valve	Fig.5106	60
• Flex Check Valve	Fig.5107	61
• Ball Check Valve	Fig.5109/5709	62
• Thin Wafer Check Valve	Fig.5315/5316	63
• Balancing Valve	Fig.1209/1210	64
• Plug Valve	Fig.1105/1106/1605	65
• Foot Valve	Fig.1120	66
• Y-Strainer	Fig.7101/7102	67
• DIN Y-Strainer	Fig.7103/7107	68
• Bronze Y-Strainer	Fig.7104	69
• Basket Strainer	Fig.7105/7108	70
• Bronze Basket Strainer	Fig.7106	71
• Suction Diffuser	Fig.7109	72
• Thread End Y-Strainer	Fig.7701	73
• Stainless Steel Thread End Y-Strainer	Fig.7702	74
• Grooved End Y-Strainer	Fig.7901	75
• Ball Valve	Fig.4102/4103/4104	76
• Automatic Air Vent Valve	Fig.9701	77
• Double Orifice Air Relief Valve	Fig.9101A	78
• Combination Air Valve for Sewage	Fig.9110	79
• Single Sphere Rubber Expansion Joint	Fig.8101	80
• Double Sphere Rubber Expansion Joint	Fig.8102	81
• Double Sphere Union Type Rubber Expansion Joint	Fig.8701	82

Wafer Butterfly Valve  
 Gear Operated, 300PSI  
**FIG · F0811-300**

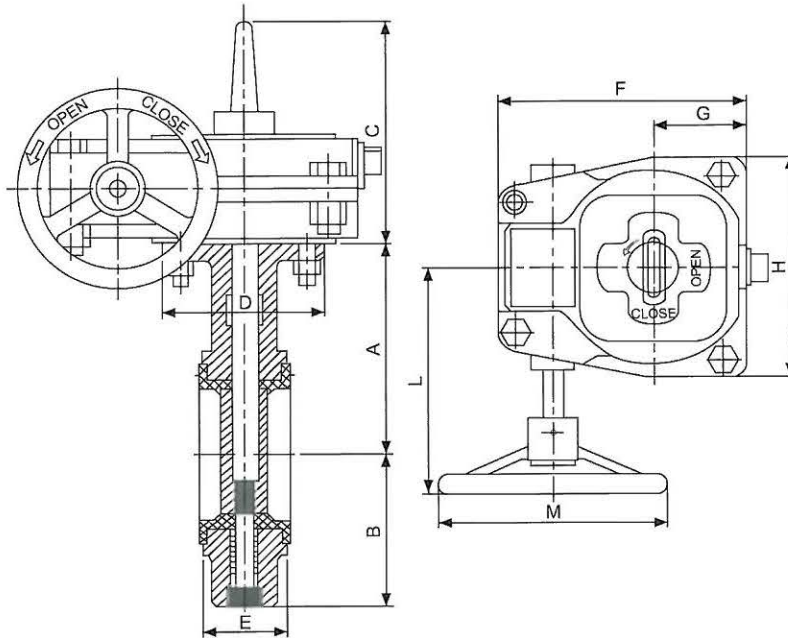

**Material Specification**

	Part Name	Material	EN Spec.	ASTM Spec.
Valve	Body	Ductile Iron	EN-JS1050	A536 65-45-12
	Disc	Ductile Iron	EN-JS1050	A536 65-45-12
	Shaft	Stainless Steel	BS970 431S29	AISI 431
	Bushing	Brass	CuZn39Pb3	B16 C36000
Gear Operator	Housing	Cast Iron	EN-JL1040	A126 Class B
	Cover	Cast Iron	EN-JL1040	A126 Class B
	Wormgear	Brass	CuZn39Pb3	B16 C36000
	Worm	Stainless Steel	BS970 420S37	AISI 420
	Handwheel	Cast Iron	EN-JL1040	A126 Class B

**Dimensions (mm/inch)**

Size	A	B	D	E	C	F	G	H	L	M
DN50	110	74	90	43	120	170	65	155	150	200
DN65	118	85	90	46						
DN80	130	95	90	46						
DN100	145	115	90	51.5						
DN125	160	130	90	56						
DN150	175	145	90	56.5	160	225	85	206	200	300
DN200	200	170	125	60						
DN250	250	208	125	68.5						
DN300	275	237.5	125	79.5						

Groove Butterfly Valve  
Gear Operated, 300PSI  
**FIG · F1022-300**

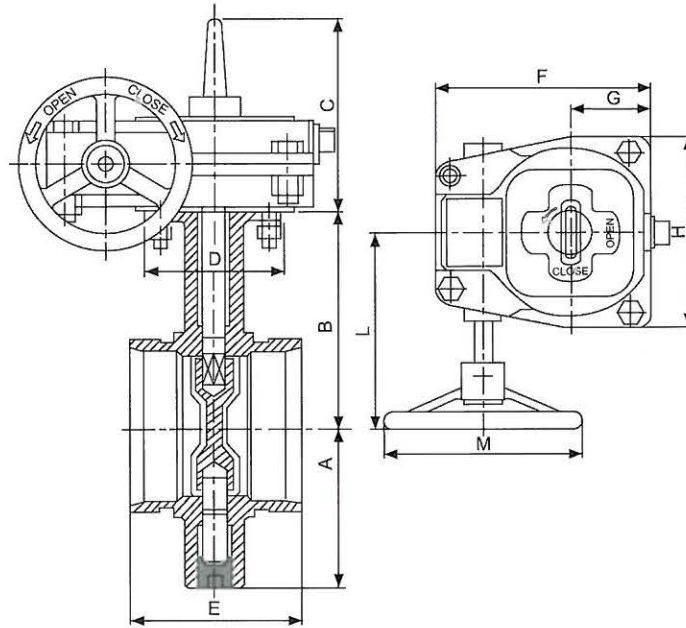

**Material Specification**

	Part Name	Material	EN Spec.	ASTM Spec.
Valve	Body	Ductile Iron	EN-JS1050	A536 65-45-12
	Disc	Ductile Iron, EPDM coated	EN-JS1050	A536 65-45-12
	Shaft Upper	Stainless Steel	BS970 431S29	AISI 431
	Shaft Lower	Stainless Steel	BS970 431S29	AISI 431
	Bushing	Brass	CuZn39Pb3	B16 C36000
Gear Operator	Housing	Cast Iron	EN-JL1040	A126 Class B
	Cover	Cast Iron	EN-JL1040	A126 Class B
	Wormgear	Brass	CuZn39Pb3	B16 C36000
	Worm	Stainless Steel	BS970 420S37	AISI 420
	Handwheel	Cast Iron	EN-JL1040	A126 Class B

**Dimensions (mm/inch)**

Size	A	B	D	E	C	F	G	H	L	M
DN50	77	99	90	84	120	170	65	155	150	200
DN65	85	112	90	97						
DN80	90	115	90	97						
DN100	108	145	90	116						
DN125	120	138.5	90	148						
DN150	145	185	90	148	160	225	85	206	200	300
DN200	180	200	125	133						
DN250	230	250	125	159						
DN300	260	275	125	165						





## OS&Y RESILIENT SEALED GATE VALVE FLANGE ENDS 250PSI FIG · F011-250

### Specification

- Valves comply with AWWA C515
- The handwheel is attached to the yoke by a heavier nut.
- High quality graphite stem seal.
- NPT brass plug on body.
- One brass plug screwed on body
- Flanges EN1092-2 PN10 / PN16, ANSI B16.1 Class125 (Others available on request).
- FM and UL approved

### Working Pressure

- 250PSI

### Working Temperature

- 0.6°C to 52°C

### Corrosion Protection

- Internally and externally fusion bonded epoxy powder coated (FBE).

**Notes:** Design and material are subject to change without notice.

### Material Specification

Part Name	Material	ASTM Spec.
Body	Ductile Iron	A536 65-45-12
Wedge	Ductile Iron, EPDM Encapsulated	
Wedge Nut	Stainless Steel	AISI 304
Stem	Stainless Steel	AISI 420
Bonnet	Ductile Iron	A536 65-45-12
Gasket	EPDM	Commercial
Packing	Graphite	Commercial
Gland	Ductile Iron	A536 65-45-12
Yoke Nut	Bronze	ASTM B62
Handwheel	Ductile Iron	A536 65-45-12
Handwheel Nut	Ductile Iron	A536 65-45-12
NPT Plug	Brass	B16, C36000
Gland Bolts	Stainless Steel	AISI 316
Bonnet Bolts	Carbon Steel	A307 B

### Drawing and Picture

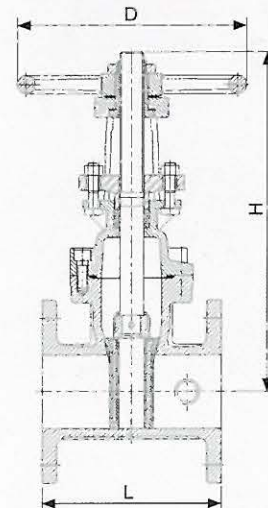

### Dimensions (mm/inch)

Size	2.5"		3"		4"		5"		6"		8"		10"		12"	
	mm	inch	mm	inch	mm	inch	mm	inch	mm	inch	mm	inch	mm	inch	mm	inch
L	190.5	7-1/2	203	8	229	9	254	10	267	10-1/2	292	11-1/2	330	13	356	14
H(Open)	415	16-5/8	480	18-7/8	550	21-5/8	655	25-4/5	740	29-1/8	930	36-5/8	1130	44-1/2	1320	52
H(Close)	350	13-3/4	400	15-3/4	450	17-3/4	530	20-7/8	590	23-1/4	730	28-3/4	880	34-3/4	1020	40-1/6
D	184	7-1/4	254	10	254	10	305	12	305	12	356	14	445	17-1/2	445	17-1/2
Weigh(kg)	20		25		30		42		50		77		120		170	



# OS&Y RESILIENT SEALED GATE VALVE GROOVE ENDS 300PSI FIG · F0122-300

## Specification

- Valves comply with AWWA C515
- Valves with an indicator post flange and a 2" square wrench nut.
- Triple O-rings stem seal.
- NPT brass plug on body
- Groove to Metric or AWWA C606 standard
- FM and UL approved

## Working Pressure

- 300PSI
- 200PSI and 250PSI available on request

## Working Temperature

- 0.6°C to 52°C

## Corrosion Protection

- Internally and externally fusion bonded epoxy powder coated (FBE).

**Notes:** Design and material are subject to change without notice.

## Material Specification

Part Name	Material	ASTM Spec.
Body	Ductile Iron	A536 65-45-12
Wedge	Ductile Iron with EPDM Coated	
Wedge Nut	Bronze	ASTM B62
Stem	Stainless Steel	AISI 420
Thrust Collar	Bronze	ASTM B62
Bonnet	Ductile Iron	A536 65-45-12
Gasket	EPDM	Commercial
Gland	Ductile Iron	A536 65-45-12
O-ring	EPDM	Commercial
Post Flange	Ductile Iron	A536 65-45-12
Operating Nut	Ductile Iron	A536 65-45-12
NPT Plug	Brass	B16, C36000
Indicator Flange Bolts	Stainless Steel	AISI 316
Bonnet Bolts	Carbon Steel	A307 B

## Drawing and Picture

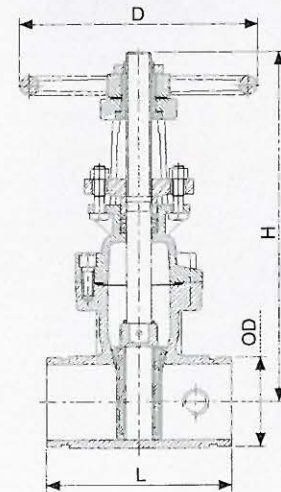

## Dimensions (mm/inch)

Size	2.5"		3"		4"		5"		6"		8"		10"		12"	
	mm	inch	mm	inch	mm	inch	mm	inch	mm	inch	mm	inch	mm	inch	mm	inch
OD	73.0	2-7/8	88.9	3-1/2	114.3	4-1/2	139.7	5-1/2	165.1	6-1/2	219.1	8-5/8	273.0	10-3/4	323.9	12-3/4
	76.1	3					141.3	5-9/16	168.3	6-5/8						
L	190.5	7-1/2	203	8	229	9	254	10	267	10-1/2	292	11-1/2	330	13	356	14
H(Open)	415	16-5/8	480	18-7/8	550	21-5/8	655	25-4/5	740	29-1/8	930	36-5/8	1130	44-1/2	1320	52
H(Close)	350	13-3/4	400	15-3/4	450	17-3/4	530	20-7/8	590	23-1/4	730	28-3/4	880	34-3/4	1020	40-1/6
D	184	7-1/4	254	10	254	10	305	12	305	12	445	17-1/2	445	17-1/2	445	17-1/2
Weigh(kg)	13.3		17.5		28		40.5		43.5		68		113		153	



## NRS RESILIENT SEALED GATE VALVE FLANGE ENDS 250PSI FIG · F0211-250

### Specification

- Valves comply with AWWA C515.
- No rising stem.
- With indicator post flange and a 2" square operating nut.
- Triple O-ring stem seal.
- NPT brass plug on body.
- Flange designed to EN1092-2 PN10 / PN16, ANSI B16.1 Class125 (Others available on request).
- FM and UL approved.

### Working Pressure

- 250PSI

### Working Temperature

- 0.6°C to 52°C

### Corrosion Protection

- Internally and externally fusion bonded epoxy powder coated (FBE).

**Notes:** Design and material are subject to change without notice.

### Material Specification

Part Name	Material	ASTM Spec.
Body	Ductile Iron	A536 65-45-12
Wedge	Ductile Iron with EPDM Coated	
Wedge Nut	Bronze	ASTM B62
Stem	Stainless Steel	AISI 420
Thrust Collar	Bronze	ASTM B62
Bonnet	Ductile Iron	A536 65-45-12
Gasket	EPDM	Commercial
Gland	Ductile Iron	A536 65-45-12
O-ring	EPDM	Commercial
Post Flange	Ductile Iron	A536 65-45-12
Operating Nut	Ductile Iron	A536 65-45-12
NPT Plug	Brass	B16, C36000
Indicator Flange Bolts	Stainless Steel	AISI 316
Bonnet Bolts	Carbon Steel	A307 B

### Drawing and Picture

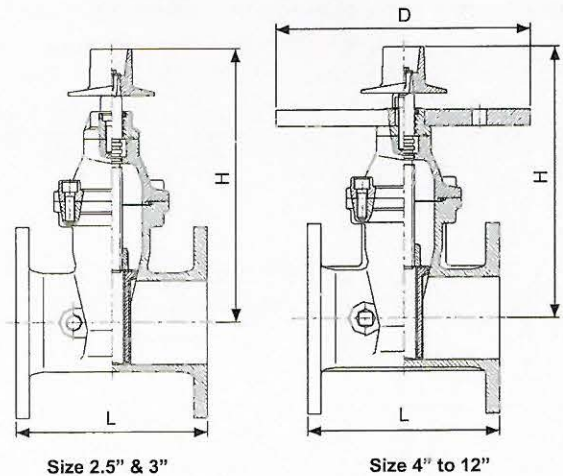

### Dimensions (mm/inch)

Size	2-1/2"		3"		4"		5"		6"		8"		10"		12"	
	mm	inch	mm	inch	mm	inch	mm	inch	mm	inch	mm	inch	mm	inch	mm	inch
L	190.5	7-1/2	203	8	229	9	254	10	267	10-1/2	292	11-1/2	330	13	356	14
H	270	10-5/8	296	11-5/8	350	13-3/4	410	16-1/8	455	17-15/16	545	21-7/16	645	25-3/8	730	28-3/4
D	--	--	--	--	305	12	305	12	305	12	305	12	305	12	305	12
Weigh(kg)	16.5		23		30		35		50		75		110		164	





**NRS RESILIENT SEALED GATE VALVE**  
**FL×MJ ENDS 300PSI**  
**FIG · F0213-300**

**Specification**

- Valves comply with AWWA C515
- No rising stem
- With indicator post flange and a 2" operating nut
- Triple O-ring stem seal
- NPT plug on body
- Flange designed to EN1092-2 PN10 / PN16, ANSI B16.1 Class125 (Others available on request)
- With the mechanical joint designed to ANSI/AWWA C153/A21.53.
- FM and UL approved

**Working Pressure**

- 300PSI
- 200PSI and 250PSI available on request

**Working Temperature**

- 0.6°C to 52°C

**Corrosion Protection**

- Internally and externally fusion bonded epoxy powder coated (FBE).

**Notes:** Design and material are subject to change without notice.

**Material Specification**

Part Name	Material	ASTM Spec.
Body	Ductile Iron	A536 65-45-12
Wedge	Ductile Iron with EPDM Coated	
Wedge Nut	Bronze	ASTM B62
Stem	Stainless Steel	AISI 420
Thrust Collar	Bronze	ASTM B62
Bonnet	Ductile Iron	A536 65-45-12
Gasket	EPDM	Commercial
Gland	Ductile Iron	A536 65-45-12
O-ring	EPDM	Commercial
Post Flange	Ductile Iron	A536 65-45-12
Operating Nut	Ductile Iron	A536 65-45-12
NPT Plug	Brass	B16, C36000
Indicator Flange Bolts	Stainless Steel	AISI 316
Bonnet Bolts	Carbon Steel	A307 B

**Drawing and Picture**

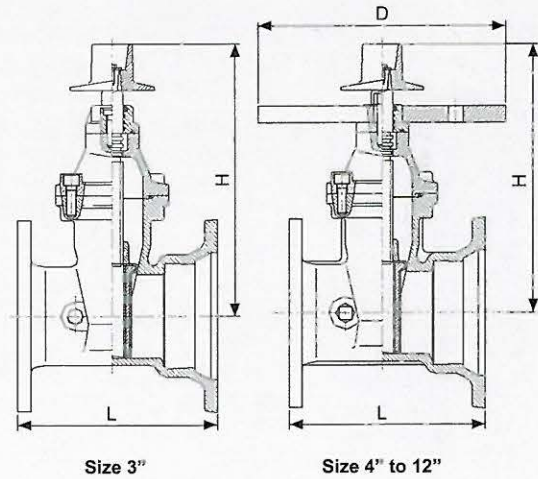

**Dimensions (mm/inch)**

Size	3"		4"		6"		8"		10"		12"	
	mm	inch	mm	inch	mm	inch	mm	inch	mm	inch	mm	inch
L	222	8-3/4	241.5	9-1/2	279.5	11	305	12	352.5	13-7/8	367	14-7/16
H	296	11-5/8	350	13-3/4	455	17-15/16	545	21-7/16	645	25-3/8	730	28-3/4
D	--	--	305	12	305	12	305	12	305	12	305	12
Weigh(kg)	21.4		31		51.5		77.5		114		169.5	





## NRS RESILIENT SEALED GATE VALVE MJ×MJ ENDS 300PSI FIG · F0233-300

### Specification

- Valves comply with AWWA C515
- No rising stem
- With indicator post flange and a 2" operating nut
- Triple O-ring stem seal
- NPT plug on body
- With the mechanical joint designed to ANSI/AWWA C153/A21.53.
- FM and UL approved

### Working Pressure

- 300PSI
- 200PSI and 250PSI available on request

### Working Temperature

- 0.6°C to 52°C

### Corrosion Protection

- Internally and externally fusion bonded epoxy powder coated (FBE).

**Notes:** Design and material are subject to change without notice.

### Material Specification

Part Name	Material	ASTM Spec.
Body	Ductile Iron	A536 65-45-12
Wedge	Ductile Iron with EPDM Coated	
Wedge Nut	Bronze	ASTM B62
Stem	Stainless Steel	AISI 420
Thrust Collar	Bronze	ASTM B62
Bonnet	Ductile Iron	A536 65-45-12
Gasket	EPDM	Commercial
Gland	Ductile Iron	A536 65-45-12
O-ring	EPDM	Commercial
Post Flange	Ductile Iron	A536 65-45-12
Operating Nut	Ductile Iron	A536 65-45-12
NPT Plug	Brass	B16, C36000
Indicator Flange Bolts	Stainless Steel	AISI 316
Bonnet Bolts	Carbon Steel	A307 B

### Drawing and Picture

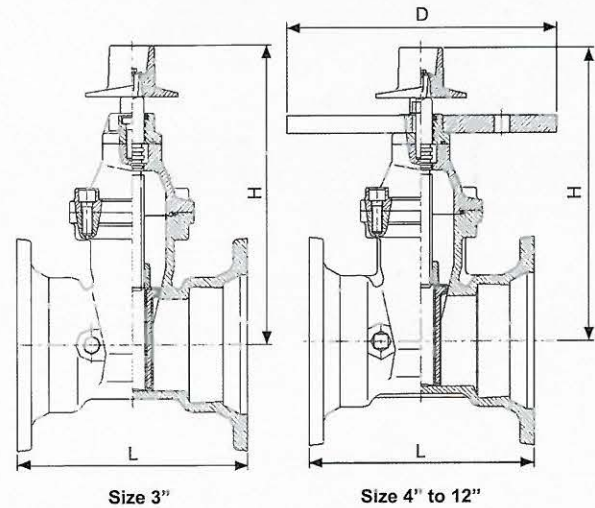

### Dimensions (mm/inch)

Size	3"		4"		6"		8"		10"		12"	
	mm	inch	mm	inch	mm	inch	mm	inch	mm	inch	mm	inch
L	241	9-1/2	254	10	292	11-1/2	318	12-1/2	375	14-3/4	378	14-7/8
H	296	11-5/8	350	13-3/4	455	17-15/16	545	21-7/16	645	25-3/8	730	28-3/4
D	--	--	305	12	305	12	305	12	305	12	305	12
Weigh(kg)	20.4		32		52.5		80		118		175	

## WALL INDICATOR POST FIG · F0600-WP

### Specification

- Indicates if the valve is in the open or shut position.
- Used to operate a valve installed behind a wall.
- With a 12"O.D. post flange to mount on a wall.
- Operated by handwheel.
- Can be supplied to open left or right.
- FM and UL approved.

### Corrosion Protection

- Internally and externally red epoxy coated RAL3000.

**Notes:** Design and material are subject to change without notice.

### FIELD ADJUSTMENT

- Remove the Top Section from the top of the Indicator Post assembly.
- Reattach the Top Section to the top of the Indicator Post assembly.
- Set the "OPEN" and "SHUT" targets for the appropriate valve size.

### Drawing and Picture

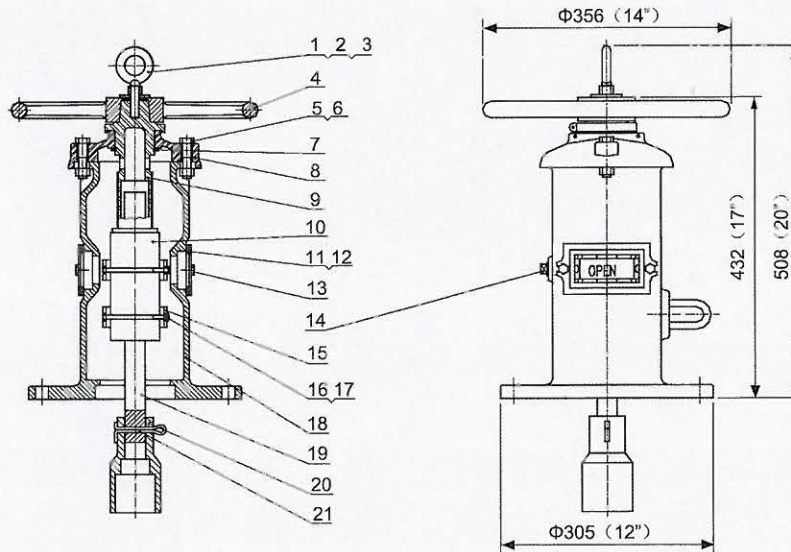

### Material Specification

No.	Component	Material	No.	Component	Material
1	Eye Bolt	Carbon Steel ASTM A307B	11	Window Glass	Plexiglass
2	Hex Nut	Carbon Steel ASTM A307B	12	Gasket	PTFE
3	Washer	Carbon Steel ASTM A570 Gr. 33	13	Hex Nut	Carbon Steel ASTM A307B
4	Handwheel	Ductile Iron ASTM A536 Gr. 65-45-12	14	Plug	Malleable Iron
5	Hex Cap Screw	Carbon Steel ASTM A307B	15	Target	Cast Aluminium
6	Square Nut	Carbon Steel ASTM A307B	16	Hex Cap Screw	Carbon Steel ASTM A307B
7	Snap Ring	Stainless Steel AISI 1066	17	Hex Nut	Carbon Steel ASTM A307B
8	Cover	Cast Iron ASTM A126 Class B	18	Body	Cast Iron ASTM A126 Class B
9	Operating Nut	Bronze ASTM B62 C83600	19	Stem	Carbon Steel AISI 1045
		Stainless Steel AISI 304	20	Crane Coupling	Ductile Iron ASTM A536 Gr. 65-45-12
10	Target Carrier Nut	Bronze ASTM B62 C83600	21	Cotter Pin	Stainless Steel AISI 304
		Stainless Steel AISI 304			





**WEFLO**<sup>®</sup>

WEFLO VALVE COMPANY LTD.

## SWING CHECK VALVE GROOVE ENDS 300PSI FIG · F0322-300

### Specification

- Seating type is resilient material to bronze seat construction.
- Full waterway design.
- Ductile iron disc, EPDM encapsulated.
- Groove dimensions comply with Metric or AWWA C606.
- FM and UL approved.

### Working Pressure

- 300PSI
- 200PSI and 250PSI available on request

### Working Temperature

- 0.6 °C to 52 °C

### Corrosion Protection

- Internally and externally fusion bonded epoxy powder coated (FBE).

**Notes:** Design and material are subject to change without notice.

### Material Specification

Part Name	Material	ASTM Spec.
Body	Ductile Iron	A536 65-45-12
Body Seat	Bronze	ASTM B62
Disc	DI and Rubber Encapsulated	DI+EPDM
Spindle	Stainless Steel	AISI 316
Spring	Stainless Steel	AISI 304
Plug	Stainless Steel	AISI 304
Washer	Rubber	EPDM

### Drawing and Picture

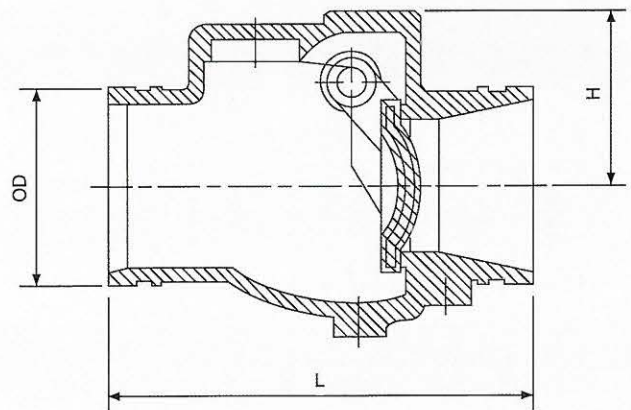

### Dimensions (mm/inch)

Size	2.5"		3"		4"		5"		6"		8"		10"		12"	
	mm	inch	mm	inch	mm	inch	mm	inch	mm	inch	mm	inch	mm	inch	mm	inch
OD	73.0	2-7/8	88.9	3-1/2	114.3	4-1/2	139.7	5-1/2	165.1	6-1/2	219.1	8-5/8	273	10-3/4	323.9	12-3/4
	76.1	3					141.3	5-9/16	168.3	6-5/8						
L	203.2	8	213	8-3/8	245	9-5/8	267	10-1/2	292	11-1/2	356	14	432	17	495	19-1/2
H	74.5	2-15/16	78	3-1/16	102	4	112	4-7/16	133.5	5-1/4	160	6-5/16	195	7-11/16	215	8-1/2



# Y-STRAINER FLANGE ENDS 175PSI FIG · F0511-175

## Specification

- NPT or BSPT blowoff outlet on cover. Blowoff outlets are finished with plugs.
- Screens are perforated 304 stainless steel with spot welded seam.
- Recessed seat in body assures accurate screen alignment.
- Flanges to EN1092-2 PN16, ANSI B16.1 Class125 (Other types available on request).
- UL listed.

## Working Pressure

- 175PSI

## Working Temperature

- -10°C to 120°C

## Corrosion Protection

- Internally and externally spray-painted or fusion bonded epoxy powder coated (FBE).

**Notes:** Design and material are subject to change without notice.

## Material Specification

Component	Material
Body	Cast Iron ASTM A126 Class B
Cover	Cast Iron ASTM A126 Class B
Screen	Stainless Steel AISI 304
Gasket	PTFE/Graphite
Plug	Ductile Iron ASTM A536 Gr. 65-45-12

## Standard Screens

Size (mm/inch)	Hole Dia.(mm)	Free Flow Area(%)
65(2-1/2" )	3	53.6
80-125(3" -5")	4.3	46.3
150-250 (6"-10" )	6.0	54.5
300 (12" )	6.3	57.2

## Dimensions (mm/inch)

Size	A		B		Plug Size (NPT Thread)	Weight(kg)
	mm	inch	mm	inch		
65mm / 2-1/2"	273.0	10-3/4	135.0	5-5/16	1"	14
80mm / 3"	295.0	11-5/8	215.0	8-1/2	1"	17.3
100mm / 4"	352.0	13-7/8	245.0	9-5/8	1"	32
125mm / 5"	416.0	16-3/8	295.0	11-5/8	1-1/4"	47.5
150mm / 6"	470.0	18-1/2	320.0	12-5/8	1-1/2"	62.5
200mm / 8"	543.0	21-3/8	415.0	16-3/8	1-1/2"	107.5
250mm / 10"	660.0	26	485.0	19-1/8	2"	175
300mm / 12"	770.0	30-5/16	560.0	22-1/16	2"	253

## Drawing and Picture

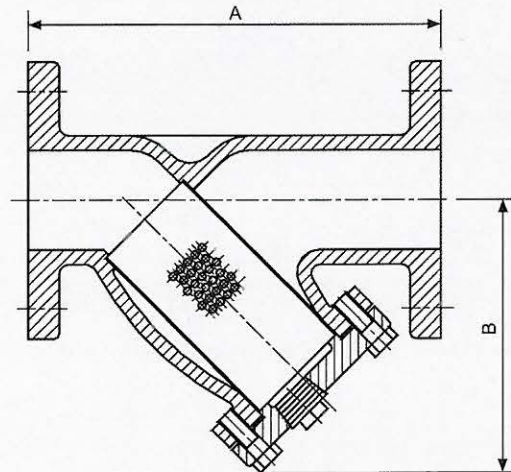

# FIRE HYDRANT DRY-BARREL 250PSI FIG · F0733-250

## Specification

- Complies with AWWA C502.
- Seating type is resilient material to bronze seat construction.
- One pumper nozzle, 4.5-4NH thread. Two hose nozzle, 2.5-7.5NH thread. Other threads are available.
- Multiple buried lengths available.
- 6" mechanical joint designed to ANSI/AWWA C153/A21.53.
- FM approved.

## Material Specification

Part Name	Material	ASTM Spec.
Operating Nut	Bronze	ASTM B62
Hold Down Nut	Bronze	ASTM B62
O-Ring	NBR	Commercial
Bonnet	Cast Iron	A126 Class B
Bonnet Bolt & Nut	Stainless Steel	AISI 201
Upper Rod	Carbon Steel	AISI 1045
Pumper Nozzle	Bronze	ASTM B62
Pumper Nozzle Gasket	NBR	Commercial
Hose Nozzle	Bronze	ASTM B62
Hose Nozzle Gasket	NBR	Commercial
Pumper Nozzle Cap	Cast Iron	A126 Class B
Hose Nozzle Cap	Cast Iron	A126 Class B
Cap Chain	Carbon Steel	Plated
Standpipe Upper	Cast Iron	A126 Class B
Safety Coupling	Stainless Steel	A890
Safety Flange Bolt & Nut	Stainless Steel	AISI 201
Safety Flange	Cast Iron	A126 Class B
Lower Rod	Carbon Steel	AISI 1045
Standpipe Lower	Cast Iron	A126 Class B
Stem Pin	Stainless Steel	A276
Drain Ring Housing	Ductile Iron	A536 65-45-12
Drain Ring	Bronze	ASTM B62
Seat Ring	Bronze	ASTM B62
Bottom Plate	Ductile Iron	A536 65-45-12
Disc Ring	NBR	Commercial
Bottom Plate Nut	Ductile Iron	A536 65-45-12
Elbow	Ductile Iron	A536 65-45-12

## Dimensions (inch)

L	3'-0"	3'-6"	4'-0"	4'-6"	5'-0"	5'-6"	6'-0"
Weight(kg)	170	178	183	196	200	210	215

## Working Pressure

- 250PSI

## Working Temperature

- 0.6 °C to 52 °C

## Corrosion Protection

- Internally and externally liquid epoxy painted.

Notes: Design and material are subject to change without notice.

## Drawing and Picture

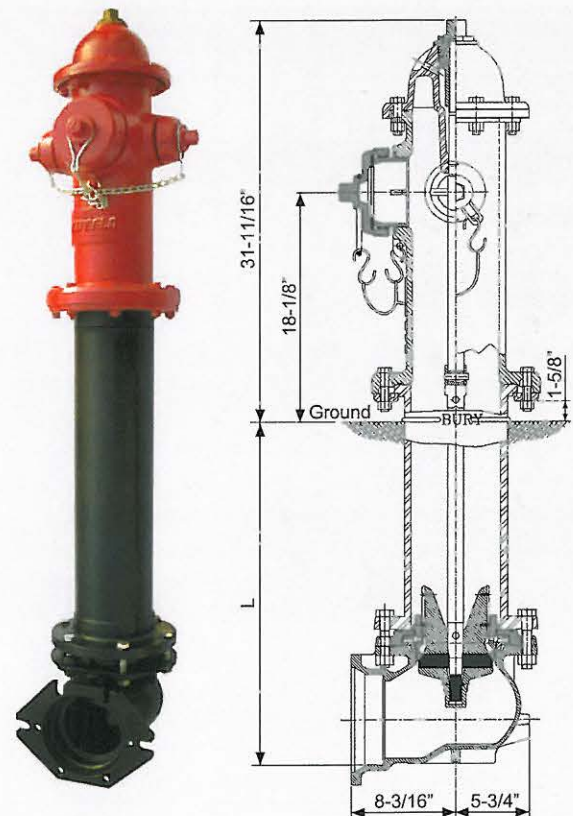



**WAFER BUTTERFLY VALVE**

Size DN50-DN600 PN16/PN25/Class125/Class250

**FIG·2302-SS Disc, FIG·2303-Bronze Disc, FIG·2304-DI Disc**

**Specification**

- Valves comply with EN593, BS5155, MSS SP-67.
- Replaceable rubber liner for size DN50 to DN300.
- Vulcanized rubber liner for size DN350 to DN600.
- With 4 locating holes for easier installation and centering.
- Actuator-ready with top-flange in accordance with ISO5211-1
- Handle or gearbox operated.
- Flanges to EN1092-2 PN10/PN16, ANSI B16.1 Class125 (Other types available on request).
- WRAS approved.

**Working Pressure**

- Size 50mm – 600mm 16 Bar
- Size 50mm – 300mm 25 Bar

**Working Temperature**

- -10°C to 120°C for EPDM liner
- -10°C to 82°C for NBR liner
- -10°C to 150°C for Viton liner

**Corrosion Protection**

- Internally and externally liquid epoxy or fusion bonded epoxy powder coated (FBE).

**Notes:** Ductile Iron body for PN25 or Class250 valves.  
Design and material are subject to change without notice.

**Material Specification**

Part Name	Material	EN Spec.	ASTM Spec.
Body*	Cast Iron	EN-JL1040	ASTM A126 Class B
Shaft	Stainless Steel	BS970 420S37	AISI 420
Disc	Stainless Steel	BS970 304S15	A351 CF8
	Bronze	EN1982 CC491K	ASTM B62 C83600
	Ductile Iron ChromePlated or FBE Coated	EN-JS1050	ASTM A536 65-45-12
Bushing	PTFE	Commercial	Commercial
Liner	EPDM/NBR/Viton	Commercial	Commercial
O-Ring	EPDM/NBR/Viton	Commercial	Commercial

**Drawing and Picture**

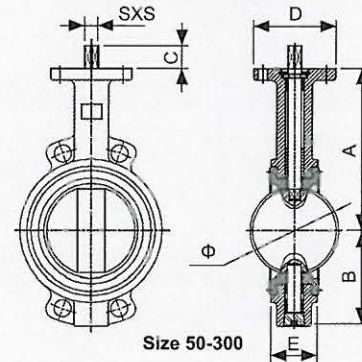

Size 50-300

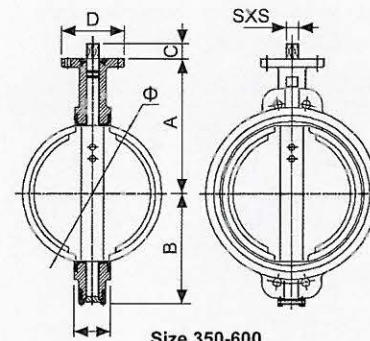

Size 350-600

**Dimensions (mm)**

Size	50	65	80	100	125	150	200	250	300	350	400	450	500	600	
A	161	175	181	200	215	225	241	296	336	368	400	422	480	562	
B	80	91	95	115	134	138	174	198	234	288	315	340	388	450	
C	30	30	30	30	30	30	30	30	30	45	45	45	45	45	
D	90	90	90	90	90	90	125	125	125	150	175	175	210	210	
E	43	45	46	51.5	56	56.5	60	68.5	79.5	78	88	109	127	154	
Φ	56.8	71.5	83	101.5	127.8	151.1	200.5	250.8	300.5	335.5	393.5	443.5	500.5	600.8	
SxS	11x11			14x14			17x17			22x22			27x27		Φ48
Top Flange	F07	F07	F07	F07	F07	F07	F10	F10	F10	F12	F14	F14	F16	F16	
Weight (kg)	4.4	5.4	5.6	7.4	10	12.2	16.9	26.3	36.3	66.7	110	130.5	157.3	222	



## GROOVE BUTTERFLY VALVE

### Size DN50-DN300 PN16

# FIG · 2902

#### Specification

- Valves comply with EN593, BS5155, MSS SP-67.
- Coated rubber disc.
- Actuator-ready with top-flange in accordance to ISO5211-1.
- Handle or gearbox operated.
- Groove dimensions comply with Metric or AWWA C606 standard.

#### Working Pressure

- 16bar

#### Working Temperature

- -10°C to 120°C for EPDM liner
- -10°C to 82°C for NBR liner
- -10°C to 150°C for Viton liner

#### Corrosion Protection

- Internally and externally fusion bonded epoxy powder coated (FBE).

**Notes:** Design and material are subject to change without notice.

#### Material Specification

Part Name	Material	EN Spec.	ASTM Spec.
Body	Ductile Iron	EN-JS1050	A536 65-45-12
Shaft	Stainless Steel	BS970 420S37	AISI 420
Disc	DI EPDM Coated	EN-JS1050	A536 65-45-12
	DI NBR Coated	EN-JS1050	A536 65-45-12
	DI Viton Coated	EN-JS1050	A536 65-45-12
O-Ring	EPDM/NBR/Viton	Commercial	Commercial

#### Dimensions (mm)

Size	50	65	80	100	125	150	200	250	300
Pipe OD	60.3	73.0/76.1	88.9	114.3	139.7/141.3	165.1/168.3	219.1	273.0	323.9
A	130	142	147	177	171	213	231	282	306
B	77	85	90	108	120	145	180	230	260
C	30	30	30	30	30	30	30	30	30
D	90	90	90	90	90	90	125	125	125
E	84	97	97	116	148	148	133	159	165
Top Flange	F07	F07	F07	F07	F07	F07	F10	F10	F10
Weight (kg)	3.8	4.3	4.7	7	8.5	11.5	15.6	28.8	35

#### Drawing and Picture

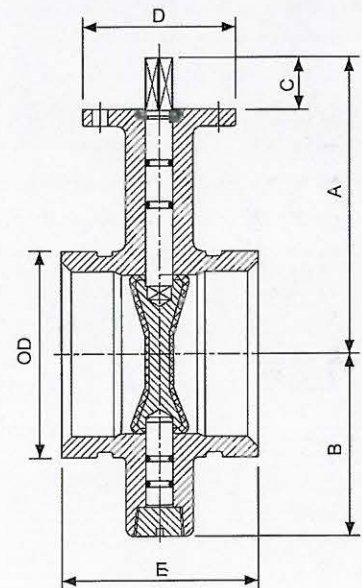

## U-TYPE BUTTERFLY VALVE

Size DN350-DN2000 PN16

### FIG · 2122

#### Specification

- Valves comply with EN593.
- EPDM/NBR rubber lined.
- Actuator-ready with top-flange in accordance to ISO5211-1.
- Gearbox operated.
- Flanges to EN1092-2 PN10/PN16 (Other types available on request).
- Face to Face dimensions conforms to EN558-1 basic series 20.

#### Working Pressure

- 16bar

#### Working Temperature

- -10°C to 120°C for EPDM Seat
- -10°C to 82°C for NBR Seat

#### Corrosion Protection

- Internally and externally liquid epoxy painted or fusion bonded epoxy powder coated (FBE).

**Notes:** Design and material are subject to change without notice.

#### Material Specification

Part	Materials	EN Spec.	ASTM Spec.
Body	Ductile Iron	EN-JS1050	ASTM A536 65-45-12
Shaft	Stainless Steel	BS970 431S29	AISI 431
Disc	SS304	BS970 304S15	AISI 304
	Ductile Iron	EN-JS1050	ASTM A536 65-45-12
Seat	EPDM/NBR	Commercial	Commercial
O-Ring	NBR	Commercial	Commercial

#### Drawing and Picture

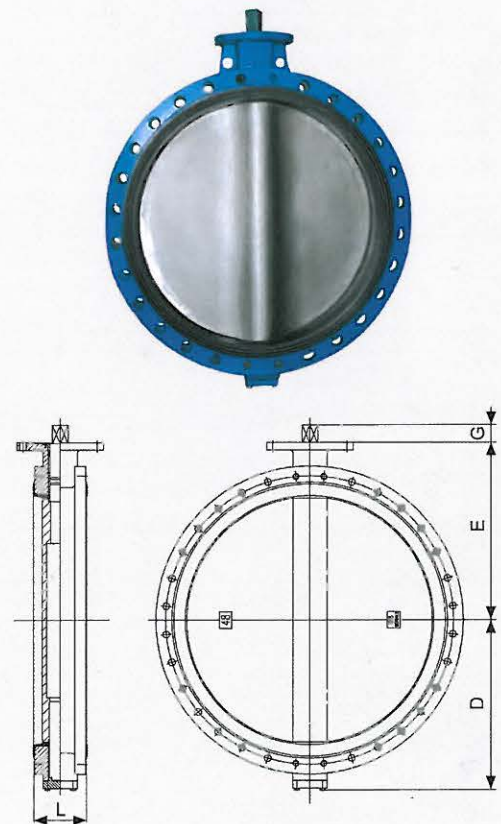

#### Dimensions (mm)

Size	350	400	450	500	600	700	750	800	900
L	78	102	114	127	154	165	190	190	203
D	288	322	341	381	450	486	525	538	632
E	330	375	397	446	520	585	585	610	690
G	45	65	65	65	65	65	65	85	85
Top Flange	F12	F14	F14	F16	F16	F25	F25	F25	F25
Weight (kg)	75	110	120	170	275	325	375	422	563

Size	1000	1050	1200	1300	1400	1500	1600	1800	2000
L	216	216	254	279	279	318	318	356	406
D	685	720	820	855	919	1008	1069	1200	1325
E	740	770	855	915	955	1067	1079	1277	1360
G	85	85	85	90	90	100	100	120	140
Top Flange	F25	F25	F35	F35	F35	F35	F35	F40	F40
Weight (kg)	763	850	1120	1480	1830	2100	2400	3100	3500



## GROOVED BUTTERFLY VALVE Size DN50-DN200 PN16

### FIG · 2952A

#### Specification

- Valves comply with EN593, BS5155, MSS SP-67.
- Rubber lined on rolled steel pipe.
- Groove dimensions comply with Metric or AWWA C606 standard.
- Handle operated.

#### Working Pressure

- 16 Bar

#### Working Temperature

- -10°C to 120°C for EPDM seat
- -10°C to 80°C for NBR seat

#### Corrosion Protection

- Internally and externally liquid epoxy painted or fusion bonded epoxy powder coated (FBE).

**Notes:** Design and material are subject to change without notice.

#### Material Specification

Part Name	Material	EN Spec.	ASTM Spec.
Body	Steel, EPDM Coated	BS970 050A20	AISI 1020
	Steel, NBR Coated	BS970 050A20	AISI 1020
Shaft	Stainless Steel	BS970 420S37	AISI 420
Disc	Stainless Steel	BS970 304S15	A351 CF8
Coupling	Ductile Iron	EN-JS1050	ASTM A536 65-45-12
O-Ring	EPDM/NBR	Commercial	Commercial
Spring	Stainless Steel	BS970 304S15	AISI 304
Gasket	PTFE	Commercial	Commercial
Dust Cover	Stainless Steel	BS970 304S15	AISI 304
Handle	Carbon Steel	BS970 080A15	ASTM A283M Gr.D

#### Drawing and Picture

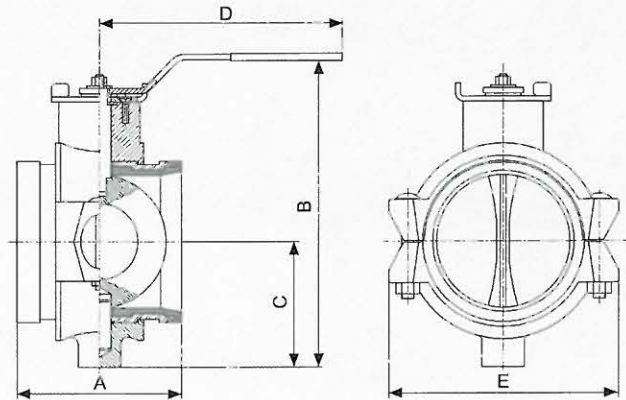

#### Dimensions (mm)

Size	50	65	80	100	150	200
Pipe OD	60.3	73.0/76.1	88.9	114.3	165.1/168.3	219.1
A	81	97	97	116	147	135
B	137	168	182	223	285	320
C	46	66	70	89	113	144
D	172	172	172	261	261	261
E	103	124	147	178	242	298
Weight (kg)	1.5	2.9	3.1	5.5	14.7	18.6



## Gear Actuator with Tamper Switch

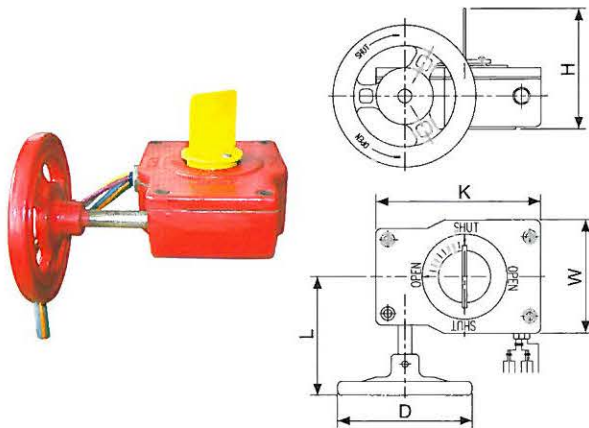

### Dimensions (mm)

Valve Size	Part Number	H	D	L	K	W
DN50 ~DN150	S2000 - 40	100	120	115	145	110
DN200 ~DN300	S2000 - 50	115	170	162	200	165

### Materials Specification

Part Name	Material	EN Spec.	ASTM Spec.
Housing	Cast Iron	EN-JL1040	A126 Class B
Cover	Cast Iron	EN-JL1040	A126 Class B
Worm	Carbon Steel	BS970 060A47	AISI 1045
Worm Gear	Ductile Iron	EN-JS1050	A536 65-45-12
Shaft	Stainless Steel	BS970 420S37	AISI 420
Handwheel	Cast Iron	EN-JL1040	A126 Class B

### Design requirements

Weflo butterfly valve should be connected to the piping system with approved couplings or flanges. Flow may be from either direction, and the valves may be positioned in any direction.

Weflo butterfly valves have been designed with a slow close handwheel operator, which effectively minimizes water hammer. These valves feature minimum flow restriction and pressure loss when in the fully open position.

### Installation

When the valves are received from the manufacturer they should be handled carefully to avoid breakage and damage to the seating area. Before installation of the valves, clean piping, flange and coupling. When the valves close hard, it is usually due to debris lodged in the seating area. Often this may be corrected by backing off the handwheel and closing again.

The valve should never be forced to seat by applying a wrench to the handwheel as this may distort the valve components or score the sealing surface. Care must be taken to align wafer valves correctly so that the disc operation to the fully open position will not be obstructed. The use of excessive force to open or close the valve violates all warranties whether express or implied.

The inlet and outlet pipe adjacent to the valve should be properly supported to prevent excessive stress on the valve body. The valve should not be used to force a pipeline into position as this may result in distortion of the valve body.

### Care and Maintenance

Weflo butterfly valves require no regular maintenance, however, it is advisable to inspect and verify proper operation of the unit annually or in accordance with the requirements of the authority having jurisdiction.

The inspection should include a visual check for leakage at the valve pipe connection and body to operator connection. Inspection and maintenance should be performed by a qualified inspection service.

### Switch Installation

Weflo butterfly valves are provided with internal supervisor position switches. The tamper switch operates by a cam connected to the valve stem. The switch will change position and close with two (2) full turns of the handwheel from the fully open position.

#### Switch 1#

For connection to the supervisory circuit  
 Normally Open: 1 Yellow  
 Normally Closed: 1 Red  
 Common: 1 White

#### Switch 2#

Auxiliary switch connected per authority  
 Normally Open: 1 Blue  
 Normally Closed: 1 Orange  
 Common: 1 Black  
 Ground Lead: 1 Green

#### SWITCH WIRE OPTION

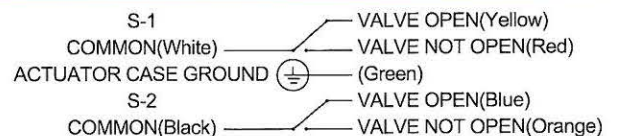

**NRS GATE VALVE , METAL SEALED**  
**Size DN50-DN600 PN16/ANSI125**

**FIG · 3123-Brass Stem , FIG · 3124-Stainless Steel Stem**

**Specification**

- Valves comply with EN1171-2002 , MSS SP-70.
- Metal seat.
- Inside stem screw.
- Adjustable stem seal.
- Available with handwheel or gearbox (bevel or spur gearbox).
- Flanges to EN1092-2 PN10 or PN16, ANSI B16.I Class125 (Other types available on request).
- Face to face length in accordance with EN558-1 basic series 3 and ASME B16.10-2000.

**Working Pressure**

- 16bar for EN1171 valves
- 200psi for MSS SP-70 valve size 2"to 12"
- 150psi for MSS SP-70 valve size 14"and above

**Material Specification**

Part Name	Materials	EN Spec.	ASTM Spec.
Body	Cast Iron	EN-JL1040	ASTM A126 Class B
Body Trim	Bronze	EN1982 CC491K	ASTM B62 C83600
Wedge Trim	Bronze	EN1982 CC491K	ASTM B62 C83600
Wedge	Cast Iron	EN-JL1040	ASTM A126 Class B
Wedge Nut	Bronze	EN1982 CC491K	ASTM B62 C83600
Stem	Brass	CuZn39Pb3	ASTM B16 C36000
	Stainless Steel	BS970 420S37	AISI 420
Bonnet	Cast Iron	EN-JL1040	ASTM A126 Class B
Gasket	Graphite	Non-asbestos	Non-asbestos
Stuffing Box	Cast Iron	EN-JL1040	ASTM A126 Class B
Packing	Graphite	Non-asbestos	Non-asbestos
Handwheel	Cast Iron	EN-JL1040	ASTM A126 Class B

**Dimensions (mm)**

Size	DN50	DN65	DN80	DN100	DN125	DN150	DN200	DN250	DN300
L	178	191	203	229	254	267	292	330	356
H	327	322	340	420	477	542	668	750	835
D	190	190	190	250	305	305	356	405	457
Weight(kg)	20.0	23.5	28.4	48.2	68.0	81.8	135.0	213.2	313.6

Size	DN350	DN400	DN450	DN500	DN600
L	381	406	432	457	508
H(Open)	1015	1120	1210	1250	1390
D	508	558	610	610	762
Weight(kg)	400.0	610.0	800.0	980.0	1320.0

**Drawing and Picture**

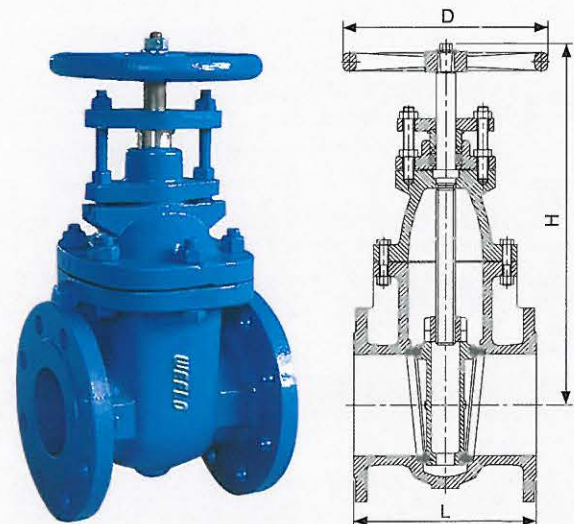

**Working Temperature**

- -10°C to 120°C

**Corrosion Protection**

- Inside and outside liquid epoxy painting.

**Notes:** Valve size DN50 to DN300 ( 2" to 12" ) available PN25 or Class250 with ductile iron body and flanges to EN1092-2 PN25 or ANSI B16.2 Class250.

Design and material are subject to change without notice.



## NRS GATE VALVE , METAL SEALED Size DN50-DN300 PN16/ANSI125

### FIG · 3129

#### Specification

- Valves comply with EN1171-2002 , BS3464.
- Metal seat.
- Inside screw.
- Adjustable stem seal.
- Available with handwheel or gearbox (bevel or spur gearbox).
- Flanges to EN1092-2 PN10 or PN16, ANSI B16.1 Class125 (Other types available on request).
- Face to face length in accordance with BS3464.

#### Working Pressure

- 16bar

#### Working Temperature

- -10°C to 120°C

#### Corrosion Protection

- Internally and externally liquid epoxy painted.

**Notes:** Seats are available integrally machined in body and wedge.  
Design and material are subject to change without notice.

#### Material Specification

Part Name	Materials	EN Spec.	ASTM Spec.
Body	Cast Iron	EN-JL1040	ASTM A126 Class B
Body Trim	Bronze	EN1982 CC491K	ASTM B62 C83600
	CI Integral	EN-JL1040	ASTM A126 Class B
Wedge Trim	Bronze	EN1982 CC491K	ASTM B62 C83600
	CI Integral	EN-JL1040	ASTM A126 Class B
Wedge	Cast Iron	EN-JL1040	ASTM A126 Class B
Wedge Nut	Bronze	EN1982 CC491K	ASTM B62 C83600
Stem	Carbon Steel	BS970 050A20	AISI 1020
	Stainless Steel	BS970 420S37	AISI 420
Bonnet	Cast Iron	EN-JL1040	ASTM A126 Class B
Gasket	Graphite	Non-asbestos	Non-asbestos
Stuffing Box	Cast Iron	EN-JL1040	ASTM A126 Class B
Packing	Graphite	Non-asbestos	Non-asbestos
Handwheel	Cast Iron	EN-JL1040	ASTM A126 Class B

#### Drawing and Picture

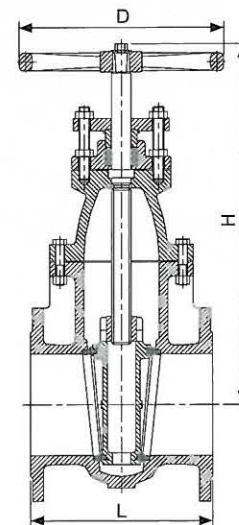

#### Dimensions (mm)

Size	DN50	DN65	DN80	DN100	DN125	DN150	DN200	DN250	DN300
L	146	159	165	171	191	210	241	273	305
H	306	325	350	405	487	531	650	773	850
D	190	190	190	250	305	305	356	405	457
Weight(kg)	17.0	20.0	24.0	38.0	48.0	68.0	120.0	198.0	295.0

**NRS GATE VALVE , METAL SEALED**  
**Size DN50-DN300 PN16/ANSI125**

**FIG · 3183-Brass Stem , FIG · 3184-Stainless Steel Stem**

**Specification**

- Valves comply with EN1171-2002 , MSS SP-70.
- Metal seat.
- Inside screw.
- Adjustable stem seal.
- Available with handwheel or gearbox (bevel gearbox or spur gearbox).
- Flanges to EN1092-2 PN10 or PN16, ANSI B16.1 Class125 (Other types available on request).
- Face to face length in accordance with EN558-1 basic series 3 and ASME B16.10-2000.

**Working Pressure**

- 16bar for EN1171 valves
- 200psi for MSS SP-70 valve

**Working Temperature**

- -10°C to 120°C

**Corrosion Protection**

- Internally and externally liquid epoxy painted.

**Notes:** Design and material are subject to change without notice.

**Material Specification**

Part Name	Materials	EN Spec.	ASTM Spec.
Body	Ductile Iron	EN-JS1050	ASTM A536 65-45-12
Body Trim	Bronze	EN1982 CC491K	ASTM B62 C83600
Wedge Trim	Bronze	EN1982 CC491K	ASTM B62 C83600
Wedge	Ductile Iron	EN-JS1050	ASTM A536 65-45-12
Wedge Nut	Bronze	EN1982 CC491K	ASTM B62 C83600
Stem	Brass	CuZn39Pb3	ASTM B16 C36000
	Stainless Steel	BS970 420S37	AISI 420
Bonnet	Ductile Iron	EN-JS1050	ASTM A536 65-45-12
Gasket	Graphite	Non-asbestos	Non-asbestos
Stuffing Box	Ductile Iron	EN-JS1050	ASTM A536 65-45-12
Packing	Graphite	Non-asbestos	Non-asbestos
Handwheel	Ductile Iron	EN-JS1050	ASTM A536 65-45-12

**Drawing and Picture**

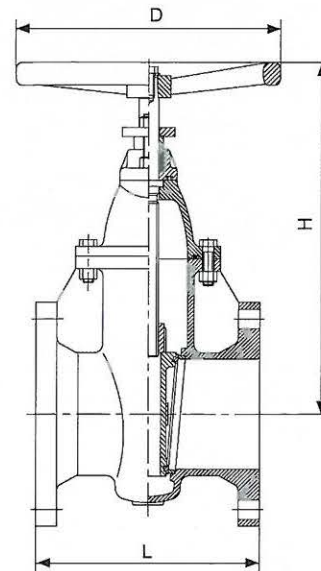

**Dimensions (mm)**

Size	DN50	DN65	DN80	DN100	DN125	DN150	DN200	DN250	DN300
L	178	190	203	229	254	267	292	330	356
H	260	285	310	350	400	445	600	720	830
D	190	190	190	250	305	305	356	405	457
Weight(kg)	14	16	19	32	44	53	92	150	219



## OS&Y GATE VALVE , GROOVE END , METAL SEALED

### Size DN50-DN300 PN16

# FIG · 3914-Stainless Steel Stem

#### Specification

- Valves comply with EN1171-2002 , MSS SP-70.
- Metal seat.
- Outside stem screw.
- Adjustable stem seal.
- Packing replaceable under pressure.
- Available with handwheel or gearbox(bevel or spur gearbox).
- Groove - Metric or AWWA C606 standard.
- Face to face length in accordance with EN558-1 basic series 3 and ASME B16.10-2000

#### Working Pressure

- 16bar

#### Working Temperature

- -10°C to 120°C

#### Material Specification

Part Name	Materials	EN Spec.	ASTM Spec.
Body	Ductile Iron	EN-JS1050	ASTM A536 65-45-12
Body Trim	Bronze	EN1982 CC491K	ASTM B62 C83600
Wedge Trim	Bronze	EN1982 CC491K	ASTM B62 C83600
Wedge	Ductile Iron	EN-JS1050	ASTM A536 65-45-12
Yoke Nut	Bronze	EN1982 CC491K	ASTM B62 C83600
Stem	Stainless Steel	BS970 420S37	AISI 420
Bonnet	Ductile Iron	EN-JS1050	ASTM A536 65-45-12
Gasket	Graphite	Non-asbestos	Non-asbestos
Yoke	Ductile Iron	EN-JS1050	ASTM A536 65-45-12
Packing	Graphite	Non-asbestos	Non-asbestos
Handwheel	Ductile Iron	EN-JS1050	ASTM A536 65-45-12

#### Drawing and Picture

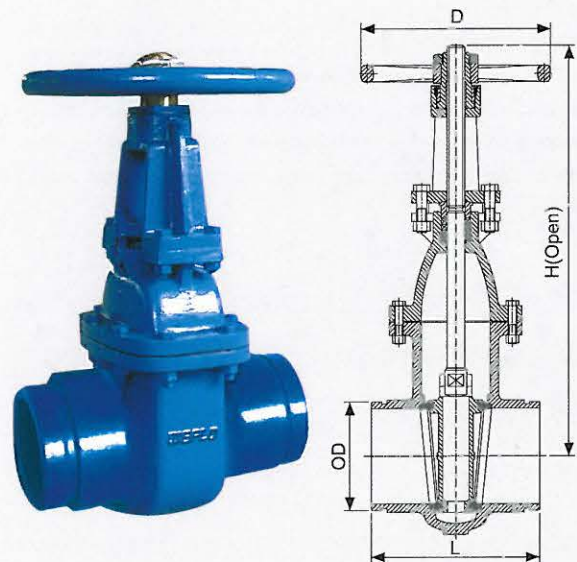

#### Corrosion Protection

- Internally and externally liquid epoxy painted.

**Notes:** Design and material are subject to change without notice.

#### Dimensions (mm)

Size	DN50	DN65	DN80	DN100	DN125	DN150	DN200	DN250	DN300
OD	60.3	73.0/76.1	88.9	114.3	139.7/141.3	165.1/168.3	219.1	273.0	323.9
L	178	191	203	229	254	267	292	330	356
H(Open)	342	366	430	587	652	745	1100	1228	1373
D	190	190	190	250	305	305	356	405	457
Weight(kg)	18.0	22.0	26.0	42.0	55.0	80.0	140.0	230.0	320.0

**NRS GATE VALVE , RESILIENT SEALED**  
**Size DN50-DN600 PN16/ANSI125**

**FIG · 3243-BS5163 Type A&B , FIG · 3246-DIN 3352 F4**  
**FIG · 3247-DIN 3352 F5 , FIG · 3248-AWWA C515**

**Specification**

- Valves comply with BS5163, DIN3352 and AWWA C515.
- Resilient sealing.
- Inside screw.
- Superior stem packing with three O-rings, one primary O-ring seal, and dust seal.
- Packing replaceable under pressure.
- High strength thrust collar.
- Available with handwheel, cap top or gearbox (bevel or spur gearbox).
- Available with flanges EN1092-2 PN10 or PN16, ANSI B16.1 Class125 (Other types available on request).
- Face to face length in accordance with EN558-1 basic series 3, ASME B16.10-2000, DIN3202-F4 and F5.
- WRAS approved (Fig.3243 valves).

**Working Pressure**

- 16bar

**Material Specification**

Part Name	Materials	ASTM Spec.	EN Spec.
Body	Ductile Iron	A536 65-45-12	EN-JS1050
Bonnet	Ductile Iron	A536 65-45-12	EN-JS1050
Wedge	DI with EPDM Coated	A536 65-45-12	EN-JS1050
Thrust Collar	Brass	B16 C36000	2874 CZ 124
Stem Nut	Brass	B16 C36000	2874 CZ 124
Stem	Stainless Steel	AISI 420	BS970 420S37
O-ring	EPDM	Commercial	Commercial
Gasket	EPDM	Commercial	Commercial
Gland	Ductile Iron	A536 65-45-12	EN-JS1050
Wrench Nut	Ductile Iron	A536 65-45-12	EN-JS1050
Handwheel	Ductile Iron	A536 65-45-12	EN-JS1050

**Dimensions (mm)**

Size		50	65	80	100	125	150	200	250	300	350	400	450	500	600
L	BS5163 Type A & B EN558-1, Series-3	178	191	203	229	254	267	292	330	356	381	406	432	457	508
	DIN3352 DIN3202-1-F4 EN558-1, Series-14	150	170	180	190	200	210	230	250	270	290	310	330	350	390
	DIN3352 DIN3202-1-F5 EN558-1, Series-15	250	270	280	300	325	350	400	450	500	550	600	650	700	800
	AWWA C515 ANSI/ASME-B16.10	178	191	203	229	254	267	292	330	356	381	406	432	457	508
H		240	255	280	305	380	417	525	621	711	905	980	1115	1190	1340
D		175	175	255	255	305	305	355	405	405	558	558	610	610	762
Weight (kg)	Fig.3243 & 3248	15	17	20	26	33	46	70	105	159	218	280	390	504	730
	Fig.3246	13	15	18	22	29	38	60	97	130	198	255	363	464	672
	Fig.3247	14	17	20	25	32	43	67	111	165	230	295	430	525	760

**Drawing and Picture**

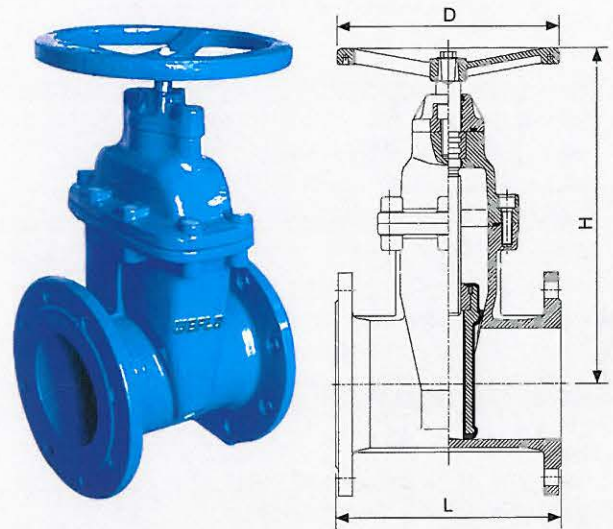

**Working Temperature**

- -10°C to 120°C

**Corrosion Protection**

- Inside and outside liquid epoxy painting.

**Notes:** Design and material are subject to change without notice.



## OS&Y GATE VALVE , RESILIENT SEALED Size DN50-DN300 PN16/ANSI 125

### FIG · 3233

#### Specification

- Valves comply with AWWA C515.
- Resilient sealing.
- Outside screw.
- Superior stem graphite packing.
- Packing replaceable under pressure.
- Available with handwheel or gearbox (bevel or spur gearbox).
- Available with flanges to EN1092-2 PN10 or PN16, ANSI B16.1 Class125 (Other types available on request).
- Face to face length in accordance with EN558-1 basic series 3, ASME B16.10-2000.

#### Working Pressure

- 16bar

#### Working Temperature

- -10°C to 120°C

#### Material Specification

Component	Materials	EN Spec.	ASTM Spec.
Body	Ductile Iron	EN-JS1050	A536 65-45-12
Bonnet	Ductile Iron	EN-JS1050	A536 65-45-12
Wedge	Ductile Iron with EPDM Coated	EN-JS1050	A536 65-45-12
Stem	Stainless Steel	BS970 420S37	AISI 420
Gasket	EPDM	Commercial	Commercial
Wedge Nut	Stainless Steel	BS970 304S15	AISI 304
Bolts on bonnet flange	Carbon Steel	Commercial	Commercial
Gland	Ductile Iron	EN-JS1050	A536 65-45-12
Gland bolts	Stainless Steel	BS970 304S15	AISI 304
Yoke Nut	Bronze	EN1982 CC491K	B62 C83600
Handwheel	Ductile Iron	EN-JS1050	A536 65-45-12
Handwheel Nut	Ductile Iron	EN-JS1050	A536 65-45-12

#### Dimensions (mm)

Size	DN50	DN65	DN80	DN100	DN125	DN150	DN200	DN250	DN300
L	178	190.5	203	229	254	267	292	330	356
H(Open)	385	415	480	550	655	740	930	1130	1320
D(Close)	320	350	400	450	530	590	730	880	1020
D	184	184	254	254	305	305	356	445	445
Weight(kg)	16	18	28	30	38	53	75	125	175

#### Drawing and Picture

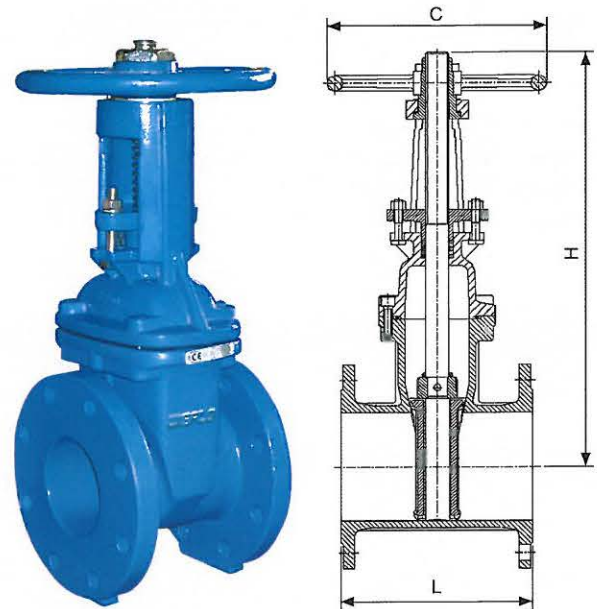

#### Corrosion Protection

- Internally and externally 250 microns minimum fusion bonded epoxy powder coated (FBE).

**Notes:** Design and material are subject to change without notice.

## NRS GATE VALVE , RESILIENT SEALED Size DN750-DN1800 150PSI FIG · 3226-AWWA C509

### Specification

- Valves comply with AWWA C509.
- Resilient sealing.
- Inside screw.
- Superior stem packing with O-rings.
- With two bearings above and below the stem collar to reduce friction.
- Packing replaceable under pressure.
- With high strength integral thrust collar.
- Available with bevel or spur gearbox.
- May be installed in horizontal or vertical position.
- Available with flanges EN1092-2 PN10 or PN16, ANSI B16.1 Class125 (Other types available on request).
- Face to face length in accordance with EN558-1 basic series 3, ASME B16.10-2000.

### Material Specification

No.	Component	Material
1	Body	DI, ASTM A536 65-45-12
2	Rubber Wedge	DI with EPDM coated
3	Stem Nut	Brass, ASTM B16 C83600
4	Stem	Stainless Steel, AISI 431
5	Bolts	Stainless Steel, AISI 304
6	Nuts	Stainless Steel, AISI 304
7	Washer	Stainless Steel, AISI 304
8	Bonnet Adapter	DI, ASTM A536 65-45-12
9	Gasket	EPDM
10	Bonnet	DI, ASTM A536 65-45-12
11	O-Ring	EPDM
12	Bolts	Stainless Steel, AISI 304
13	Nuts	Stainless Steel, AISI 304
14	Bearing	AISI 304
15	O-Ring	EPDM
16	Lifting Eye	Carbon Steel with Zinc Plated
17	Washer	Stainless Steel, AISI 316
18	Track	Stainless Steel, AISI 316
19	Plug 3/4 NPT	Brass, ASTM B16 C83600
20	Key	Steel

### Drawing and Picture

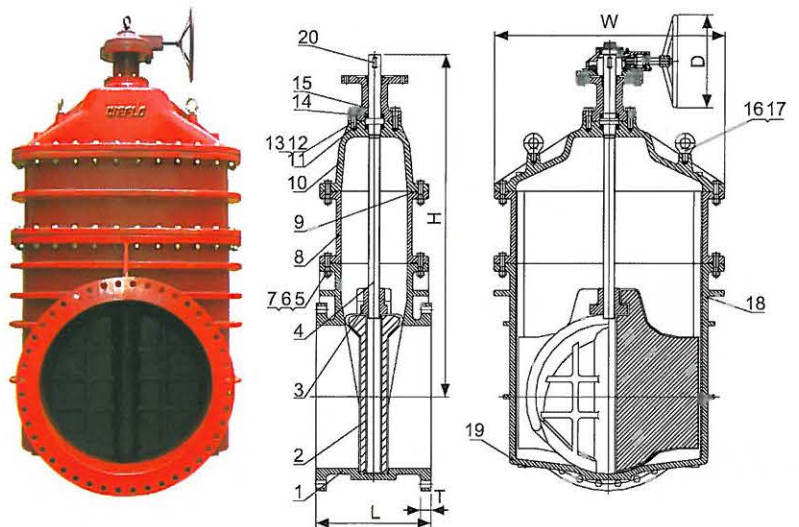

### Working Pressure

- 150psi

### Working Temperature

- -10°C to 120°C

### Corrosion Protection

- Internally and externally 250 microns minimum fusion bonded epoxy powder coated (FBE).

**Notes:** Design and material are subject to change without notice.

### Dimensions (mm)

Size	L	D	H	W	T	Weight(kg)
DN750	610	305	1778	1213	53.8	2150
DN900	711	356	2057	1378	60.5	3600
DN1050	914	457	2197	1695	66.5	6500
DN1200	1118	546	2438	1918	69.9	7500
DN1500	1118	1000	3275	2135	79.2	11500
DN1800	1219	1500	3950	2660	89	15000



## GLOBE VALVE Size DN15-DN300 PN16 FIG · 6125

### Specification

- Valves comply with DIN3356.
- Metal seat.
- Adjustable stem seal.
- Packing replaceable under pressure.
- Available with flanges to EN1092-2 PN10 or PN16, ANSI B16.1 Class125 (Other types available on request).
- Face to face length in accordance with DIN3202 series F1.

### Working Pressure

- 16bar

### Working Temperature

- -10°C to 120°C

### Corrosion Protection

- Internally and externally liquid epoxy painted.

**Notes:** Design and material are subject to change without notice.

### Material Specification

Part Name	Materials	EN Spec.	ASTM Spec.
Body	Cast Iron	EN-JL1040	ASTM A126 Class B
Bonnet	Cast Iron	EN-JL1040	ASTM A126 Class B
Body Trim	Stainless Steel	BS970 304S15	AISI 304
Disc Trim	Stainless Steel	BS970 304S15	AISI 304
Disc	Cast Iron	EN-JL1040	ASTM A126 Class B
Stem	Stainless Steel	17440X20Cr13	AISI 420
Packing	Graphite	Non-asbestos	Non-asbestos
Gasket	Graphite	Non-asbestos	Non-asbestos
Yoke Bushing	Brass	CuZn39Pb3	ASTM B16 C36000
Handwheel	Cast Iron	EN-JL1040	ASTM A126 Class B

### Drawing and Picture

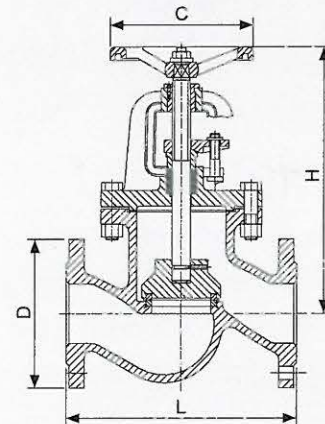

### Dimensions (mm)

DN	15	20	25	32	40	50	65
L	130	150	160	180	200	230	290
D	95	105	115	140	150	165	185
H	170	181	199	213	240	254	298
C	100	100	120	120	140	140	200
Weight (kg)	3.6	4.7	6.0	7.8	11.0	14.8	24.7

DN	80	100	125	150	200	250	300
L	310	350	400	480	600	730	850
D	200	220	250	285	340	405	460
H	345	375	384	438	546	648	760
C	200	240	280	320	356	515	515
Weight (kg)	30.5	41	67	95.2	143	221	295

## SWING CHECK VALVE

Size DN50-DN600 PN16/PN25/Class125/Class250

# FIG · 5101-Bronze Disc Trim , FIG · 5102-Rubber Disc Trim

### Specification

- Valves comply with EN 12334, BS5153, MSS SP-71 or AWWA C508.
- Globe shape to provide full flow with low pressure drop.
- Suitable for mounting in horizontal and vertical position (with vertical flow upwards).
- Available with flanges EN1092-2 PN10 or PN16, ANSI B16.1 Class125 (Other types available on request).

### Working Pressure

- Size 50mm—600mm 16Bar
- Size 50mm—300mm 25Bar

### Working Temperature

- -10°C to 120°C for Bronze or EPDM disc trim
- -10°C to 82°C for NBR disc trim

### Material Specification

Part Name	Materials	EN Spec.	ASTM Spec.
Body*	Cast Iron	EN-JL1040	ASTM A126 Class B
Cover*	Cast Iron	EN-JL1040	ASTM A126 Class B
Side Plug	Brass	CuZn39Pb3	ASTM B16 C36000
Hanger Pin	Stainless Steel	BS970 420S37	AISI 420
Hanger	Ductile Iron	EN-JS1050	ASTM A536 65-45-12
Disc*	Cast Iron	EN-JL1040	ASTM A126 Class B
Disc Trim	Bronze	EN1982 CC491K	ASTM B62 C83600
	EPDM/NBR	Commercial	Commercial
Body Trim	Bronze	EN1982 CC491K	ASTM B62 C83600
Gasket	Graphite	Non-asbestos	Non-asbestos

### Drawing and Picture

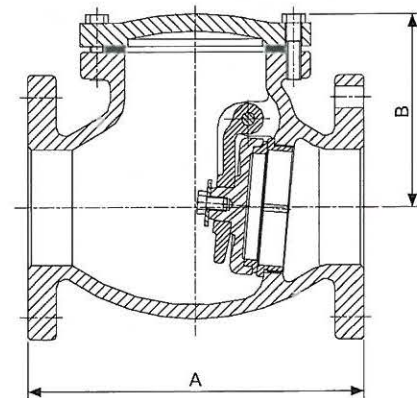

### Corrosion Protection

- Internally and externally liquid epoxy painted or fusion bonded epoxy powder coated (FBE).

**Notes:** In Ductile Iron construction for PN25 or Class250.  
Design and material are subject to change without notice.

### Dimensions (mm)

Size	50	65	80	100	125	150	200	250	300	350	400	450	500	600
A	203	216	241	292	330	356	495	622	699	787	914	914	1016	1219
B	125	137	147	166	190	217	265	300	342	402	472	500	514	605
Weight(kg)	11.5	13	17	25	40	50	58.3	218	282	500	680	780	1000	1600



## SWING CHECK VALVE Size DN40-DN300 PN16/PN25

### FIG · 5201-Braze Disc Trim , FIG · 5202-Rubber Disc Trim

#### Specification

- Face to dimensions to DIN3202 F6 series.
- Globe shape to provide full flow with low pressure drop.
- Suitable for mounting in horizontal and vertical position (with vertical flow upwards).
- Available with flanges EN1092-2 PN10 or PN16, ANSI B16.1 Class125 (Other types available on request).

#### Working Pressure

- 16bar or 25bar

#### Working Temperature

- -10°C to 120°C for Bronze or EPDM disc trim
- -10°C to 82°C for NBR disc trim

**Notes:** In Ductile Iron construction for PN25 or Class250.  
Design and material are subject to change without notice.

#### Material Specification

Part Name	Materials	EN Spec.	ASTM Spec.
Body*	Cast Iron	EN-JL1040	A126 Class B
Cover*	Cast Iron	EN-JL1040	A126 Class B
Gasket	Graphite	Non-asbestos	Non-asbestos
Hanger Pin	Stainless Steel	17440X20Cr13	AISI 420
Hanger	Ductile Iron	EN-JS1050	A536 65-45-12
Disc*	Cast Iron	EN-JL1040	A126 Class B
Disc Trim	Brass	CuZn39Pb3	B16 C36000
	EPDM/NBR	Commercial	Commercial
Body Trim	Brass	CuZn39Pb3	B16 C36000
Side Plug	Brass	CuZn39Pb3	B16 C36000

#### Drawing and Picture

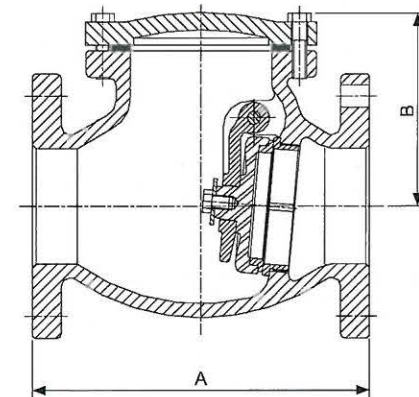

#### Corrosion Protection

- Internally and externally liquid epoxy painted or fusion bonded epoxy powder coated (FBE).

#### Dimensions (mm)

Size	40	50	65	80	100	125	150	200	250	300
A	180	200	240	260	300	350	400	500	600	700
B	118	120	125	147	158	188	193	250	300	342
Weight(kg)	10	11.5	13	17	25	40	50	58.3	218	282

## WAFLER SWING CHECK VALVE

### Size DN50-DN600 PN16/Class125

# FIG · 5301

#### Specification

- The short face to face dimension and compact design of this valve allow installation and service in tight spaces.
- Spring assisted for better dynamic behaviour.
- Soft sealed for perfect tightness even at low differential pressure.
- Available with flanges EN1092-2 PN10 or PN16, ANSI B16.1 Class125 (Other types available on request).

#### Working Pressure

- 16bar

#### Working Temperature

- -10°C to 120°C for EPDM seat
- -10°C to 82°C for NBR seat
- -10°C to 150°C for Viton seat

#### Corrosion Protection

- Internally and externally liquid epoxy painted or fusion bonded epoxy powder coated (FBE).

#### Material Specification

Part Name	Materials	EN Spec.	ASTM Spec.
Body	Cast Iron	EN-JL1040	A126 Class B
Clapper	Stainless Steel	BS970 304S15	A351 CF8
Hinge Arm	Stainless Steel	BS970 304S15	A351 CF8
Seat	EPDM/NBR/Viton	Commercial	Commercial
Hinge-Pin	Stainless Steel	BS970 420S37	AISI 420
Spacer	PTFE	Commercial	Commercial
Spring	Stainless Steel	BS970 304S15	AISI 304

#### Dimensions (mm)

Size	A			B	C	D	Weight (kg)
	Table D/E Flange	ANSI 125# Flange	EN1092-2 PN16 Flange				
50	98	102	106	44.5	33	27	1.6
65	111	121	126	48	47	47	2.2
80	130	134	141	51	52	45	2.9
100	162	172	161	57	76	65	4.7
125	194	194	191	63.5	95	100	6.5
150	216	220	217	70	121	121	7.8
200	273	277	272	73	163.5	176	15
250	337	337	337	79	194	220	20
300	384	407	382	86	241	270	31
350	444	447	446	108	267	310	75
400	495	511	515	108	317	320	91
450	558	546	550	108	355.6	370	100
500	615	602	610	140	387.4	410	154
600	723	715	733	152	482.6	480	250

#### Drawing and Picture

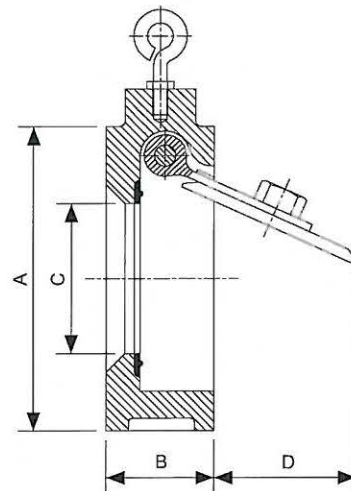

**Notes:** Design and material are subject to change without notice.



## WAFER DOUBLE DOOR CHECK VALVE

Size DN50-DN600 PN16/Class125

### FIG · 5306

#### Specification

- The short face to face dimension and compact design of this valve allow installation and service in tight spaces.
- Spring assisted for better dynamic behaviour.
- Soft sealed for perfect tightness even at low differential pressure.
- Available with flanges EN1092-2 PN10 or PN16, ANSI B16.1 Class125 (Other types available on request).
- WRAS approval.

#### Working Pressure

- 16bar

#### Working Temperature

- -10°C to 120°C for EPDM seat
- -10°C to 82°C for NBR seat
- -10°C to 150°C for Viton seat

#### Material Specification

Part Name	Materials	EN Spec.	ASTM Spec.
Body	Cast Iron	EN-JL1040	ASTM A126 Class B
Disc	Stainless Steel	BS970 304S15	A351 CF8
Seat	EPDM/NBR/Viton	Commercial	Commercial
Hinge Pin	Stainless Steel	BS970 420S37	AISI 420
Stop Pin	Stainless Steel	BS970 420S37	AISI 420
Pin Retainer	Stainless Steel	BS970 304S15	AISI 304
Spring	Stainless Steel	BS970 304S15	AISI 304
Washer	PTFE	Commercial	Commercial
Gasket	EPDM/NBR/Viton	Commercial	Commercial

#### Drawing and Picture

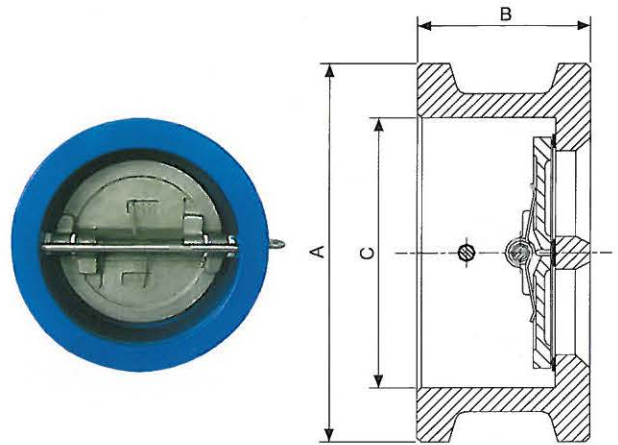

#### Corrosion Protection

- Internally and externally liquid epoxy painted or fusion bonded epoxy powder coated (FBE).

**Notes:** Design and material are subject to change without notice.

#### Dimensions (mm)

Size	A			B	C	Weight (kg)
	Table D/E Flange	ANSI 125# Flange	EN1092-2 PN16 Flange			
50	96	102	106	54	66	1.8
65	109	121	126	54	78	2.4
80	126	134	141	57	90	3.2
100	158	172	161	64	115	4.8
125	190	194	191	70	141	7.3
150	210	220	217	76	170	10
200	267	277	272	95	210	14.2
250	331	337	327	108	273	23.6
300	379	407	382	143	324	37.5
350	445	447	442	184	356	62
400	493	511	494	191	406	74
450	559	546	554	203	457	100
500	616	602	616	213	508	155
600	723	715	733	222	600	215

## GROOVED END DOUBLE DOOR CHECK VALVE Size 2-1/2"-12" PN20

### FIG · 5905-SS Disc , FIG · 5906-Bronze Disc

#### Specification

- Spring automatically closes disc at zero flow before flow reversal occurs.  
This prevents surge and water hammer.
- Soft sealed for perfect tightness even at low differential pressure.
- Groove dimensions comply with Metric or AWWA C606 standard.

#### Working Pressure

- 20bar

#### Working Temperature

- -10°C to 120°C for EPDM seat
- -10°C to 82°C for NBR seat
- -10°C to 150°C for Viton seat

#### Corrosion Protection

- Internally and externally liquid epoxy painted or fusion bonded epoxy powder coated (FBE).

#### Material Specification

Part Name	Material	EN Spec.	ASTM Spec.
Housing	Ductile Iron	EN-JS1050	A536 65-45-12
Hex Bolt	Carbon Steel	Carbon Steel	A307B
Washer	Carbon Steel	BS970 050A20	AISI 1020
O-Ring	EPDM/NBR/Viton	Commercial	Commercial
Seat	EPDM/NBR/Viton	Commercial	Commercial
Shaft	Stainless Steel	BS970 420S37	AISI 420
End Face	Ductile Iron	EN-JS1050	A536 65-45-12
Spring	Stainless Steel	BS970 304S15	AISI 304
Disc	Stainless Steel	BS970 304S15	A351 CF8
	Bronze	EN1982 CC491K	B62 C83600
Eye Bolt	Carbon Steel	BS970 060A35	AISI 1035

#### Drawing and Picture

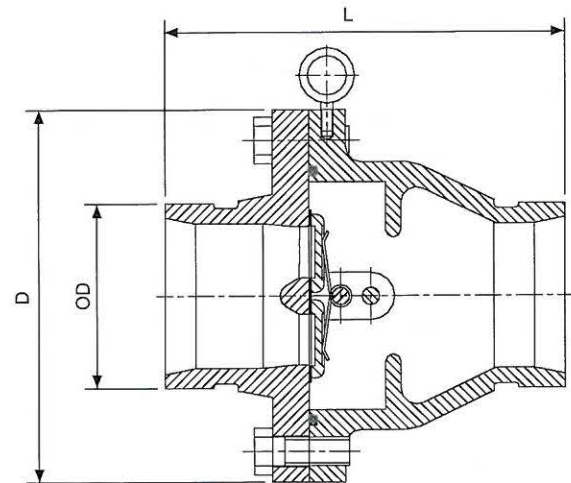

**Notes:** Design and material are subject to change without notice.

#### Dimensions (mm)

Size	2-1/2	3	4	5	6	8	10	12
OD	73.0/76.1	88.9	114.3	139.7/141.3	165.1/168.3	219.1	273.0	323.9
L	140	150	197	211	211	232	260	305
D	178	191	235	254	280	372	406	483
Weight (kg)	7	10	18	19	22	49	60	106



## GLOBE SILENT CHECK VALVE

### Size DN50-DN300 PN16/PN25/Class125/Class250

# FIG · 5106

#### Specification

- Complies with the requirements of EN12334.
- The design is for liquid service and offers many obvious advantages when compared with conventional swing check valve.
- Spring automatically closes disc at zero flow before flow reversal occurs. This prevents surge and water hammer.
- Soft sealed for perfect tightness even at low differential pressure.
- Available with flanges to EN1092-2 PN10 or PN16, ANSI B16.1 Class125 (Other types available on request).

#### Working Pressure

- 16bar or 25bar

#### Corrosion Protection

- Internally & externally fusion bonded epoxy powder coated (FBE).

#### Material Specification

Part Name	Materials	EN Spec.	ASTM Spec.
Body*	Cast Iron	EN-JL1040	A126 Class B
Seat	CI Integral	EN-JL1040	A126 Class B
Disc*	Cast Iron	EN-JL1040	A126 Class B
Disc Trim	EPDM/NBR/Viton	Commercial	Commercial
Spring	Stainless Steel	BS970 304S15	AISI 304
Bushing	Bronze	EN1982 CC491K	B62 C83600
Stem	Stainless Steel	BS970 420S37	AISI 420
	Brass	CuZn39Pb3	B16 C36000
Bracket*	Cast Iron	EN-JL1040	A126 Class B
Screw	Stainless Steel	BS970 304S15	AISI 304

#### Drawing and Picture

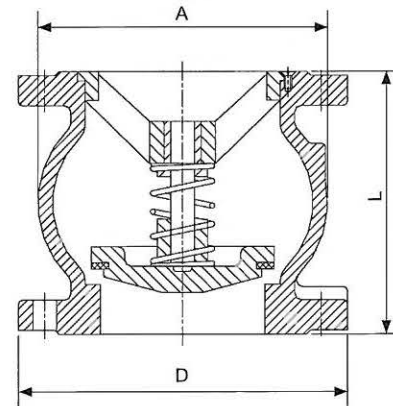

#### Working Temperature

- -10°C to 120°C for bronze EPDM disc trim
- -10°C to 82°C for NBR disc trim
- -10°C to 150°C for Viton disc trim

**Notes:** In Ductile Iron construction for PN25 or Class250.  
Design and material are subject to change without notice.

#### Dimensions (mm)

Size	50	65	80	100	125	150	200	250	300
L	100	120	140	170	200	230	288	354	410
A	97	125	150	187	220	260	340	420	490
D	EN1092-2 PN16 Flange	165	185	200	220	250	285	340	405
	EN1092-2 PN25 Flange	165	185	200	235	270	300	360	425
	ANSI 125# Flange	152	178	191	229	254	279	343	406
	ANSI 250# Flange	165	191	210	254	279	318	381	445
Weight (kg)	8	10	13	17	30	35	50	90	100

## BALL CHECK VALVE

PN16/Class125

**FIG · 5109-Flange End , Size DN40 to DN350**

**FIG · 5709-Thread End , Size DN25 to DN100**

### Specification

- Face to face dimensions to EN558-1 basic series 48 & DIN3202 F6 series.
- Fully rubber coated aluminium ball.
- Functions even at a low pressure.
- Free low passage, blockage-free.
- Low frictional losses.
- For sewage prone to blockages.
- Available with flanges EN1092-2 PN10 or PN16, ANSI B16.1 Class125 (Other types available on request).
- With thread NPT or BSPT.

### Working Pressure

- 16bar

### Working Temperature

- -10°C to 120°C for EPDM seat
- -10°C to 82°C for NBR seat

### Corrosion Protection

- Internally and externally fusion bonded epoxy powder coated (FBE).

### Material Specification

Part Name	Materials	EN Spec.	ASTM Spec.
Body	Ductile Iron	EN-JS1050	A536 65-45-12
Cover	Ductile Iron	EN-JS1050	A536 65-45-12
Ball	Aluminium NBR/EPDM Coated	EN1706 AC-42100	ANSI H35.1(M) 356.0
Gasket	NBR/EPDM	Commercial	Commercial

### Drawing and Picture

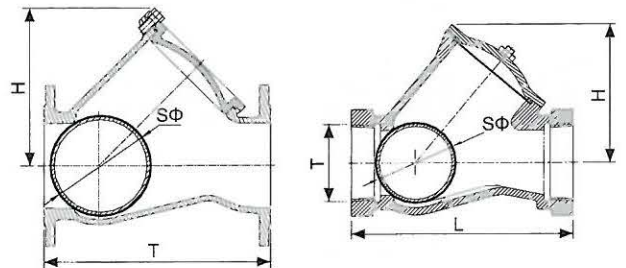
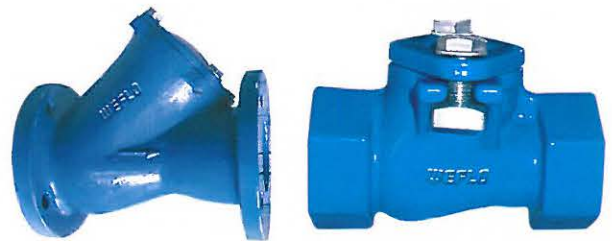

**Notes:** Design and material are subject to change without notice.

### Fig.5109 Dimensions (mm)

Size	40	50	65	80	100	125	150	200	250	300	350
L	180	200	240	260	300	350	400	500	600	700	800
H	100	125	140	180	207	225	280	355	420	480	580
SΦ	50	63	80	96	125	150	180	250	320	370	414
Weight (kg)	8	9	11	13	20	32	42	74	138	200	310

### Fig.5709 Dimensions (mm)

Size	25	32	40	50	65	80	100
T	1" NPT/BSPT	1-1/4" NPT/BSPT	1-1/2" NPT/BSPT	2" NPT/BSPT	2-1/2" NPT/BSPT	3" NPT/BSPT	4" NPT/BSPT
L	121	140	180	200	240	260	300
H	60	75	95	125	140	180	207
SΦ	32	40	50	63	80	96	125
Weight (kg)	2.7	3.6	5	6.5	8.5	10	16



## BALANCING VALVE

Size DN50-DN300 PN16/Class125

### FIG · 1209-Flanged End , FIG · 1210-Grooved End.

#### Specification

- Inside screw, non-rising stem.
- EPDM coated disk for size DN50 to DN200, DN250 and DN300 valves are SS304 disk with coated EPDM sealed ring.
- Back seating feature.
- Can be set in conjunction with flow charts.
- Two test points located on each valve.
- Available with flanges to EN1092-2 PN10 or PN16, ANSI B16.1 Class125 (Other types available on request).
- Groove to Metric or AWWA C606 standard.
- Face to face length in accordance with EN558-1 basic series 1.

#### Working Pressure

- 16bar

#### Working Temperature

- -10°C to 120°C

#### Corrosion Protection

- Internally and externally liquid epoxy painted or fusion bonded epoxy powder coated (FBE).

**Notes:** Design and material are subject to change without notice.

#### Drawing and Picture

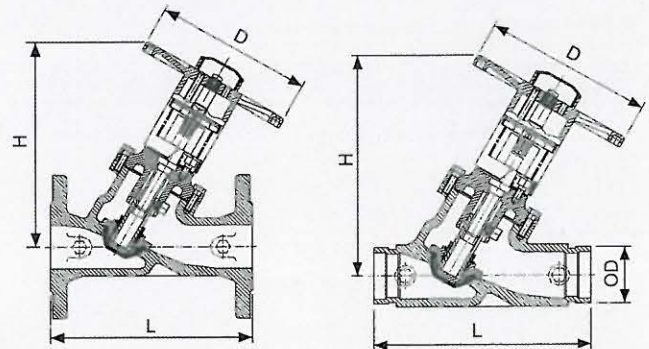

#### Material Specification

Part Name	Materials	EN Spec.	ASTM Spec.
<b>Body</b>	Ductile Iron	EN-JS1050	ASTM A536 65-45-12
<b>Disc</b>	DN50-200 DI+EPDM Coated	EN-JS1050	ASTM A536 65-45-12
	DN250-300 Stainless Steel with Coated EPDM Sealed Ring	BS970 304S15	A351 CF8
<b>Disc Nut</b>	Brass	CuZn39Pb3	ASTM B16 C36000
<b>Stem</b>	Stainless Steel	BS970 420S37	ANSI 420
<b>O-Ring</b>	EPDM	Commercial	Commercial
<b>Bonnet</b>	Ductile Iron	EN-JS1050	ASTM A536 65-45-12
<b>Gasket</b>	EPDM	Commercial	Commercial
<b>Handwheel</b>	Ductile Iron	EN-JS1050	ASTM A536 65-45-12

#### Dimensions (mm)

Size	50	65	80	100	125	150	200	250	300
<b>L</b>	230	290	310	350	400	480	600	730	850
<b>H</b>	260	293	305	323	353	388	453	554	566
<b>D</b>	180	180	180	180	260	260	260	450	450
<b>OD</b>	60.3	73.0/76.1	88.9	114.3	139.7/141.3	165.1/168.3	219.1	273.0	323.9
<b>Weight(kg)</b>	12	17	24.5	30	49	62.5	100	195	315

## FOOT VALVE

### Size DN50-DN300 PN16/Class125

# FIG · 1120

#### Specification

- Designed for silent operation, positive seating and full flow area.
- Suitable for pressure up to 16 Bar water service.
- Coated EPDM or NBR disc sealed ring.
- Screens are perforated 304 stainless steel with spot welded seam.
- Available with flanges to EN1092-2 PN10 or PN16, ANSI B16.1 Class125 (Other types available on request).

#### Working Pressure

- 16bar

#### Working Temperature

- -10°C to 120°C for EPDM coated plug
- -10°C to 82°C for NBR coated plug

#### Corrosion Protection

- Internally and externally liquid epoxy painted or fusion bonded epoxy powder coated (FBE).

**Notes:** Design and material are subject to change without notice.

#### Material Specification

Component	Material	EN Spec.	ASTM Spec.
Body	Cast Iron	EN-JS1040	ASTM A126 Class B
Disc	Cast Iron	EN-JS1040	ASTM A126 Class B
Seat	CI Integral	EN-JS1040	ASTM A126 Class B
Disc Trim	EPDM/NBR	Commercial	Commercial
Bushing	Bronze	EN1982 CC491K	ASTM B62 C83600
Stem	Stainless Steel	BS970 420S37	AISI 420
Spring	Stainless Steel	BS970 304S15	AISI 304
Support	Cast Iron	EN-JS1040	ASTM A126 Class B
Screen	Stainless Steel	BS970 304S15	AISI 304

#### Drawing and Picture

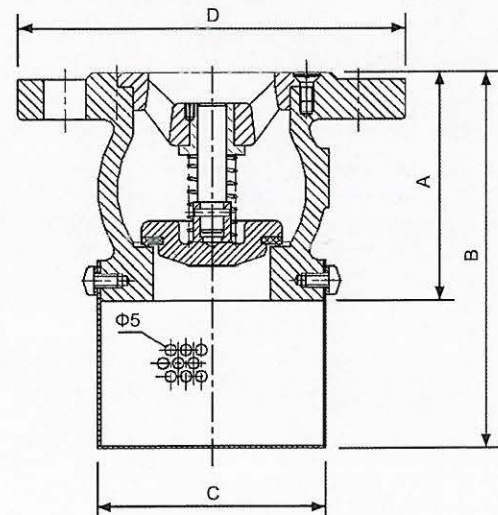

#### Dimensions (mm)

Size	50	65	80	100	125	150	200	250	300
A	100	120	140	170	200	230	288	354	410
B	160	205	240	300	355	410	490	575	655
C	94	120	142	177	206	237	290	330	360
D	165	185	200	220	250	285	340	405	460
Weight (kg)	8	10	13	17	30	35	50	90	100



## Y-STRAINER

### Size DN50-DN600 PN16/PN25

# FIG · 7103-PN16 , FIG · 7107-PN25

#### Specification

- BSPT blowoff outlet on cover. Blowoff outlets are finished with plugs.
- Screens are perforated 304 stainless steel with spot welded seam.
- Recessed seat in body assures accurate screen alignment.
- With flange EN1092-2 PN16/PN25, other types are available.
- Face to face dimension in accordance with DIN3202 series F1.

#### Working Pressure

- 16bar for Size DN50 to DN600
- 25bar for Size DN50 to DN300

#### Working Temperature

- -10°C to 120°C

#### Corrosion Protection

- Internally and externally liquid epoxy painted or fusion bonded epoxy powder coated (FBE).

#### Material Specification

Part Name	Materials	EN Spec.	ASTM Spec.	
Body	7103	Cast Iron	EN-JL1040	ASTM A126 Class B
	7107	Ductile Iron	EN-JS1050	ASTM A536 65-45-12
Cover	7103	Cast Iron	EN-JL1040	ASTM A126 Class B
	7107	Ductile Iron	EN-JS1050	ASTM A536 65-45-12
Screen	Stainless Steel	BS970 304S15	AISI 304	
Gasket	Teflon / EPDM/Graphite	Commercial	Commercial	
Plug	7103	Cast Iron	EN-JL1040	ASTM A126 Class B
	7107	Ductile Iron	EN-JS1050	ASTMA536 65-45-12

#### Standard Screens

Size	Hole Dia.	Free Flow Area
DN50 to 80	1.5mm	33%
DN100 to 600	3.0mm	40%

#### Dimensions (mm) for Fig.7101

Size	50	65	80	100	125	150	200	250	300	350	400	450	500	600
L	230	290	310	350	400	480	600	730	850	980	1100	1200	1250	1450
H	145	170	195	233	276	318	370	518	545	755	827	930	980	1170
Plug	1/2"	1"	1"	1"	1-1/4"	1-1/2"	1-1/2"	2"	2"	2"	2"	2"	2"	2"
Weight (kg)	10	14.5	19	19	40	62	109	197	253	458	556	627	780	1080

#### Drawing and Picture

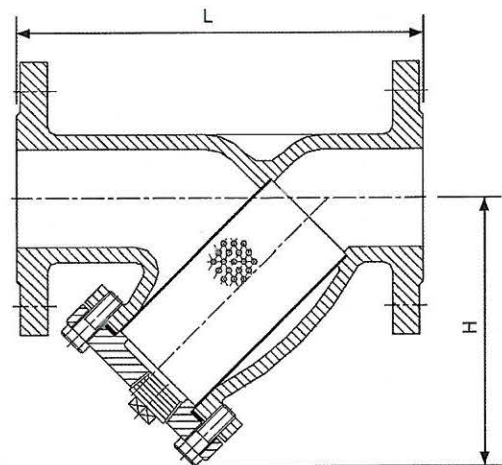

Notes: Design and material are subject to change without notice.

## BASKET STRAINER

Size DN50-DN600 PN16/PN25/Class125/Class250

# FIG · 7105-PN16/Class125 , FIG · 7108-PN25/Class250

### Specification

- NPT or BSPT blowoff outlet on body. Blowoff outlets are finished with plugs.
- Screens are perforated 304 stainless steel with spot welded seam.
- Available with flange EN1092-2 PN16/PN25, ANSI B16.1 Class125 or ANSI B16.2 Class250 (Other types available on request).

### Working Pressure

- 16bar for Size DN50 to DN600
- 25bar for Size DN50 to DN300

### Working Temperature

- -10°C to 120°C

### Corrosion Protection

- Internally and externally liquid epoxy painted or fusion bonded epoxy powder coated (FBE).

### Material Specification

Part Name	Materials	EN Spec.	ASTM Spec.	
Body	7105	Cast Iron	EN-JL1040	ASTM A126 Class B
	7108	Ductile Iron	EN-JS1050	ASTM A536 65-45-12
Cover	7105	Cast Iron	EN-JL1040	ASTM A126 Class B
	7108	Ductile Iron	EN-JS1050	ASTM A536 65-45-12
Screen	Stainless Steel	BS970 304S15	AISI 304	
Gasket	Teflon / Graphite	Commercial	Commercial	
Plug	7105	Cast Iron	EN-JL1040	ASTM A126 Class B
	7108	Ductile Iron	EN-JS1050	ASTMA536 65-45-12

### Standard Screens

Size	Hole Dia.	Free Flow Area
DN50 to 80	1.5mm	33%
DN100 to 600	3.0mm	40%

### Dimensions (mm)

Size	50	65	80	100	125	150	200	250	300	350	400	450	500	600
L	207	210	251	292	334	378	475	511	680	769	842	842	842	1054
A	225	250	297	330	370	410	530	615	770	925	972	1010	1110	1690
B	128	155	190	202	218	243	305	335	425	585	590	543	600	1175
Plug	1/2"	3/4"	3/4"	1"	1"	1"	1-1/2"	1-1/2"	2"	2"	2"	2"	2"	2"
Weight (kg)	11	19	21	30	43	58	100	151	270	470	500	645	850	1250

### Drawing and Picture

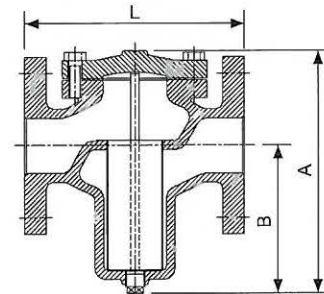

Size DN50

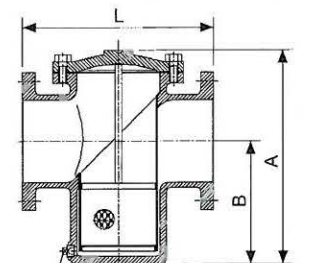

The plug for size 65 to 150  
The plug for size 200 and above

**Notes:** Design and material are subject to change without notice.



## SUCTION DIFFUSER PN16/Class150 FIG · 7109

### Specification

- Pump protection fitting, providing in one single compact unit a reducing elbow, a protective strainer and a flow straightener to improve pump performances.
- Removable 20 mesh start up screen for added protection during system start up.
- Oversized diffuser screen.
- Creates a uniform flow to the pump.
- Angled body pattern also designed for reducing pipe size to the pump.
- Drain plug for easy routine cleaning.
- Fully epoxy coated with stainless steel screen for long-lasting corrosion protection.

### Drawing and Picture

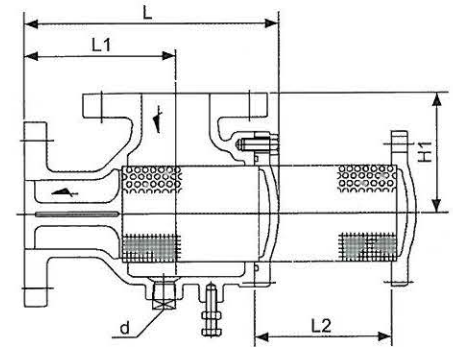

### Working Pressure

- 16bar

### Working Temperature

- -10°C to 120°C

### Corrosion Protection

- Internally and externally liquid epoxy painted or fusion bonded epoxy powder coated (FBE).

**Notes:** Design and material are subject to change without notice.

### Material Specification

Part Name	Material	ASTM Spec.
Body	Cast Iron	ASTM A126 Class B
Cover	Cast Iron	ASTM A126 Class B
Screen	Stainless Steel	AISI 304
Stud & Nuts	Carbon Steel	ASTM A307B

### Dimensions (mm)

Size	In	50A	65A	65A	80A	80A	100A	100A	100A	125A	125A	125A	150A	150A	150A	200A	200A	200A	
	Out	50A	50A	65A	65A	80A	80A	100A	100A	100A	125A	125A	100A	125A	150A	125A	150A	200A	
L		211	238	239	264	268	303	303	311	365	369	359	401	406	399	521	495	496	
L1		130	144	146	160	163	186	187	195	238	241	232	258	265	256	326	302	301	
L2		103	126	126	147	147	170	170	170	203	203	203	228	228	228	285	285	285	
H1		102	111	111	128	128	152	152	152	177	177	177	203	203	203	253	251	251	
d		NPT 1/2" - 14						NPT 3/4" - 14						NPT 1" - 11.5					

Size	In	250A	250A	250A	300A	300A	300A	350A	350A	350A	350A	400A	400A	400A	450A	450A
	Out	150A	200A	250A	200A	250A	300A	200A	250A	300A	350A	300A	350A	400A	350A	400A
L		591	598	585	711	698	686	782	767	745	751	817	818	819	923	924
L1		362	369	354	448	437	425	495	480	458	464	489	490	491	553	554
L2		360	360	360	430	430	430	482	482	482	482	525	525	525	615	615
H1		292	292	291	339	341	341	379	379	379	379	402	402	402	429	429
d		NPT 1" - 11.5														

## Stainless Steel Thread End Y-Strainer Size 8-50 PN40/600WOG

### FIG · 7702

#### Specification

- Screens are perforated 304 stainless steel with spot welded seam.
- Recessed seat in body assures accurate screen alignment.
- NPT or Metric threaded ends.

#### Working Pressure

- PN40/600PSI

#### Working Temperature

- -10°C to 120°C

#### Drawing and Picture

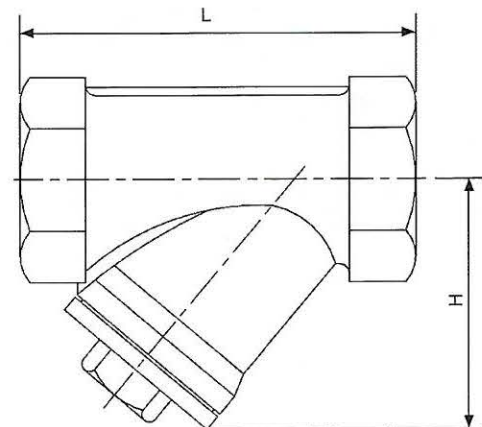

**Notes:** Design and material are subject to change without notice.

#### Material Specification

Part Name	Materials	BS Spec.	ASTM Spec.
Body	Stainless Steel	970 316S16	A351 CF8M
Cover	Stainless Steel	970 316S16	A351 CF8M
Screen	Stainless Steel	970 316S15	AISI 304
Gasket	Teflon / Viton	Commercial	Commercial
Plug	Stainless Steel	970 316S16	A351 CF8M

#### Dimensions (mm) for Fig.7101

Size	8	10	15	20	25	32	40	50
L	65	65	65	70	90	100	120	137
H	30	30	40	49	57	64	76	102
Hole Dia.	0.8	0.8	0.8	0.8	0.8	0.8	0.8	0.8
Weight (kg)	0.15	0.16	0.22	0.35	0.52	0.72	1.15	2.05



## BALL VALVE

Size DN15-DN200 PN16/Class125

**FIG · 4102-Comply with DIN standard**

**FIG · 4103-Comply with MSS standard**

**FIG · 4104-Comply with NF standard**

### Specification

- Valves comply with DIN/NF/MSS SP-72.
- Low operating torque.
- Actuator-ready with top-flange in accordance to ISO5211-1.
- Flange EN1092-2PN16 (Other types are available on request).

### Working Pressure

- 16bar

### Working Temperature

- -10°C to 120°C

### Corrosion Protection

- Internally and externally liquid epoxy painted.

**Notes:** Design and material are subject to change without notice.

### Material Specification

Component	Material	EN Spec.	ASTM Spec.
<b>Body</b>	Ductile Iron	EN-JS1050	ASTM A536 65-45-12
<b>End Cap</b>	Ductile Iron	EN-JS1050	ASTM A536 65-45-12
<b>Ball</b>	Stainless Steel	BS970 304S15	AISI 304
<b>Stem</b>	Stainless Steel	BS970 304S15	AISI 304
<b>Body Seat</b>	Teflon+ Graphite	Commercial	Commercial
<b>Packing</b>	Teflon+ Graphite	Commercial	Commercial
<b>O-Ring</b>	EPDM / Viton	Commercial	Commercial
<b>Stopper</b>	Stainless Steel	BS970 304S15	AISI 304
<b>Handle</b>	Carbon Steel	Mild Steel	Mild Steel

### Drawing and Picture

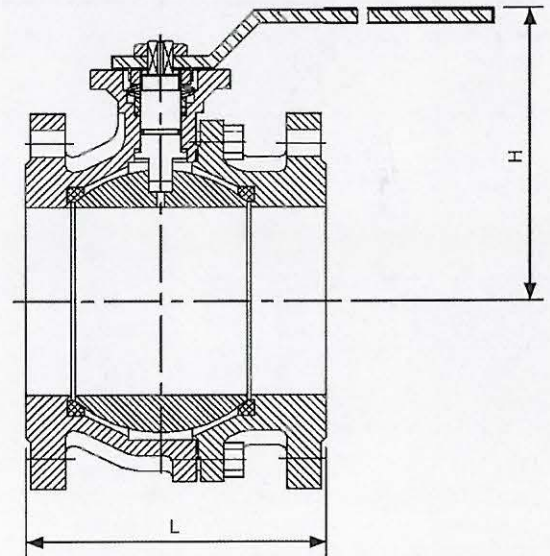

### Dimensions (mm)

Size	15	20	25	32	40	50	65	80	100	125	150	200
L	DIN	115	120	125	130	140	150	170	180	190	200	400
	NF	-	-	-	-	-	142	154	160	172	186	200
	MSS	108	117	127	140	165	178	191	203	229	254	292
H	70	75	85	105	110	115	130	140	155	195	240	325
Weight (kg)	2	3.2	4.1	5	6.5	9	14	18	26.4	34	42	50

## DOUBLE ORIFICE AIR RELIEF VALVE

Size DN50-DN200 PN16

### FIG · 9101A

#### Specification

- Dual air release valves vent the accumulated small volumes of air during normal system operation.
- Allow inflow of large volumes of air during draining of the pipeline.
- Allow venting of large volumes of air during filling of the pipeline.
- Provide protection from pipeline collapse due to vacuum
- With flange EN1092-2 PN16 (Other types are available on request).

#### Working Pressure

- 16bar

#### Working Temperature

- -10°C to 120°C

#### Corrosion Protection

- Inside and outside liquid epoxy painting or fusion bonded epoxy powder coating (FBE)

**Notes:** Design and material are subject to change without notice.

#### Material Specification

Part Name	Material	EN Spec.	ASTM Spec.
Body	Cast Iron	EN-JL1040	ASTM A126 Class B
Cover	Cast Iron	EN-JL1040	ASTM A126 Class B
Larger Ball	Stainless Steel	BS970 304S15	AISI 304
Small Ball	Stainless Steel	BS970 304S15	AISI 304
Gasket	EPDM/NBR	Commercial	Commercial
Cap	Stainless Steel	BS970 304S15	AISI 304
Screen	Stainless Steel	BS970 304S15	AISI 304

#### Drawing and Picture

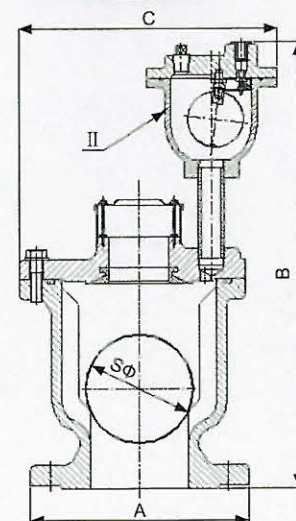

#### Dimensions (mm)

Size	50	65	180	100	150	200
A	165	185	200	220	285	340
B	370	425	425	450	490	540
C	190.5	230	230	260	320	341
S	65	94	94	110	150	200
II	1/2"	3/4"	3/4"	3/4"	3/4"	3/4"